

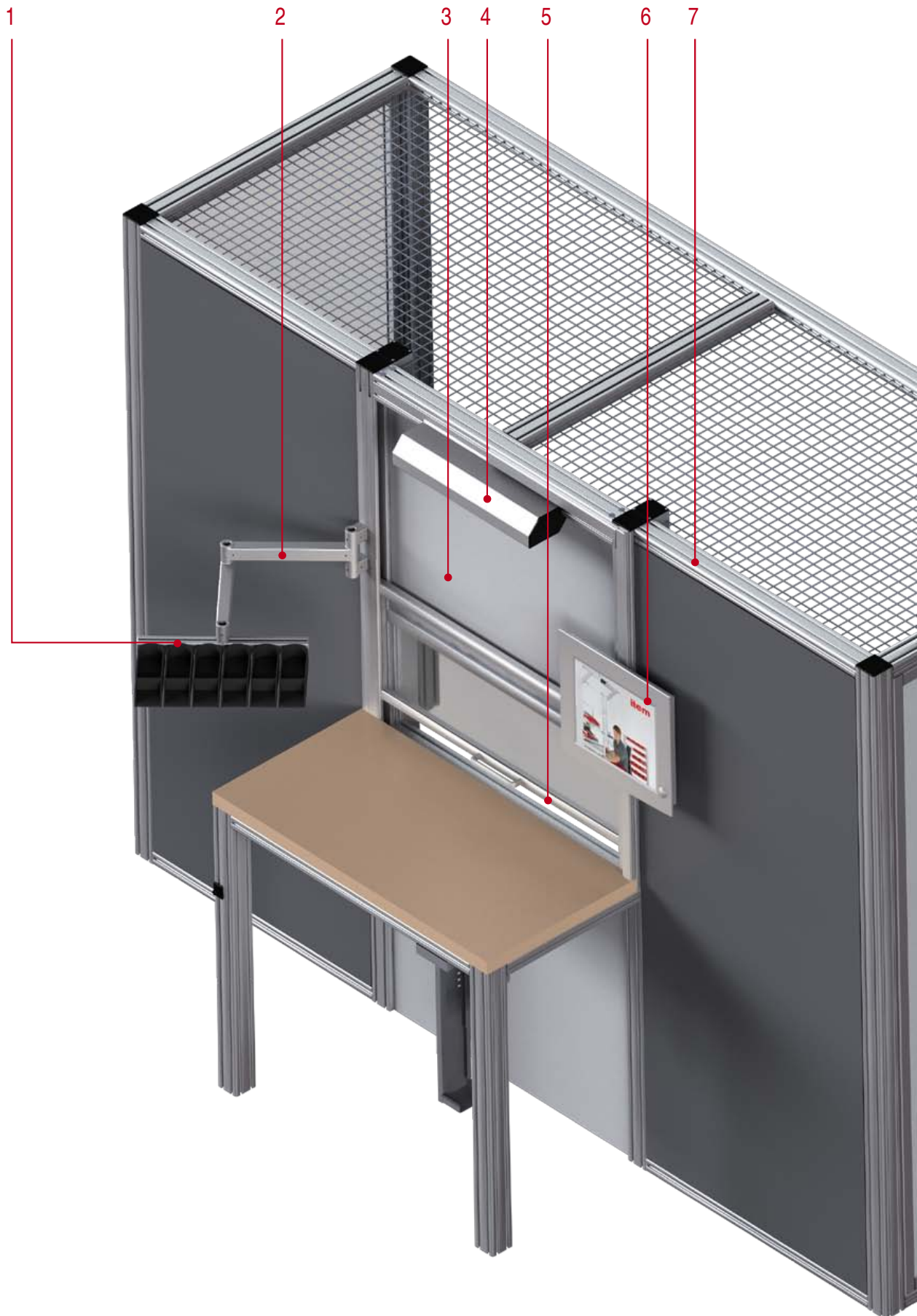

- Equipment Accessories
- Information Provision
- Lighting
- Power Supply
- Pneumatic Components
- Impact Protection

Application example – machine accessories
Perfect support for personnel



8

9

1 Container Mounting

- Ergonomic storage of small parts
- Straightforward fastening for ease of replacement

402

Section 13

2 Pivot Arms

- Ergonomic positioning of equipment
- Available in various versions for different loads
- Easy to adjust and fit in place

396

Section 13

3 Lifting doors

- Easy-running door with counterweight
- Manual and automatic operation
- Protection for personnel and processes

215

Section 6

4 Light fittings

- Working light that meets the highest safety standards
- Hinge enables position adjustment
- Compact LED lamp as a machine light fitting

413

Section 13

5 Cable conduits

- A safe home for feed cables
- Can be configured to suit requirements
- Switches and plug sockets can be installed

429

Section 14

6 Monitor holder

- Compatible with VESA standard for flatscreen monitors
- Separate mounting devices for PC and keyboard

409

Section 13

7 Pneumatic elements

- Profile core bores used as compressed-air conduits
- Special profile fasteners, seals and connections

420

Section 13

8 Clamp Profiles

- Secure mesh and other panel elements safely in place
- Range of models for various tasks

197

Section 6

9 Corrugated Mesh

- For separating machinery and working areas
- Wide range of additional panel elements available

308

Section 10

13

Key:  See page Products in this section Products in other sections

Machine Accessories
Products in this section



Telescope Profile

- Enables variation of profile length
- Clamp lever fixes easily in place

390



Positioning Set

- For measuring and positioning tasks
- All feed elements inside one profile groove

394



Pivot Arms

- For keeping frequently used equipment close to hand
- All joints can be rotated through 360°

396



Friction Joints 8

- Stable joints for customised pivot arms
- Integrated adjustable friction brake

398



Frame Profile 8 40x20

- Stable, continuous edging for panel elements
- For shelving, drawers and workpiece carriers

399



Shelf 8

- High load-carrying capacity
- Easy to fit to a profile groove

400



Container Mounting

- Straightforward connector for ease of installation
- Practical and universal

402



Runner

- Movable hanger for light-weight equipment
- For improved organisation and ergonomics

402

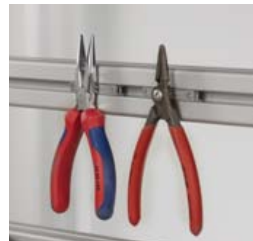

Magnetic Holder 8

- Magnetic forces hold accessories in place
- Simple storage solution for tools

404



Document Holder

- For building customised frames and holders
- Clamp function makes changing documents easy

405



Notice Holder A4, magnetic

- Practical protection for documents with a magnetic frame
- Available in four colours

408



Monitor Adapter

- VESA-compatible fixing for flatscreen monitors
- Prevents buildup of electrostatic charges

409



PC Mount

- Secure fixing for keyboard and computer
- Ball-bearing mounted pull-out

410



Label Holder

- Bring order to shelves and drawer units
- Simply clip into Profiles 8

412



Light Fitting 55W

- Bright working light that meets the highest safety standards
- Extremely easy to position thanks to pivot function

413



Lamp 35W

- Precise lighting of the working area
- Housing provides protection from splashes and dust

415



LED Machine Light Fitting

- LED technology ensures very low heat emissions
- Compact working light in protective housing

416



Light Fitting 11W

- Energy-saving long-term lighting
- Low heat emissions and operating costs

417



Multi-Socket Power Strips, 5 outlet

- Angled installation ensures easy access
- Practical, energy-saving ON/OFF switch

418



Pneumatic Universal-Fastening Sets

- Connect profiles at right angles or via their end faces
- Cavities in Profiles 8 can be used as compressed-air conduits

420



Compressed Air Manifold

- With three quick-release couplings
- Easy to fasten to a profile groove

424



Protective Profiles

- Safe impact protection thanks to hollow-chambered profiles
- Prevent damage and injuries

425



Buffer Strip

- For gentle closing of doors
- Also suitable as a door seal

426



Impact Buffers Parabolic Buffers

- Rubber/metal buffers deaden impacts effectively
- Also suitable for use as vibration-absorbing feet

427



Telescope 8 40x40

- Telescope function enables variable profile length
- Clamp lever fixes easily in place
- Maximum load up to 500 N



Outer profile for constructing telescope profiles of variable length for adjusting the height or inclination of fixtures and equipment. A profile 6 30x30 must be used for the inner profile. The outer profile can be connected directly to a profile groove via its end face or using fastening elements (Hinges, heavy duty, etc.). Line 6 components are suitable for connecting the inside profile. The inner profile, which is guided by a sliding bearing in the telescope, is secured with the Telescope Securing Set.

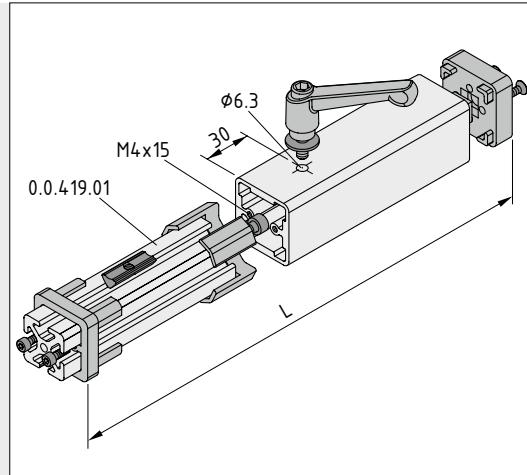

Overall length L of the telescope:

$$L \geq \text{stroke} + 74 \text{ mm}$$

Profile 6 30x30 must be 14 mm shorter than Telescope Profile 8 40x40 in order that it can be inserted completely in the assembled telescope, and the stroke thereby maximised.

Max. load in telescope direction: 500 N

13

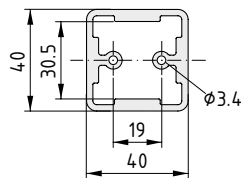

Telescope Profile 8 40x40

A [cm ²]	m [kg/m]	I _x [cm ⁴]	I _y [cm ⁴]	I _t [cm ⁴]	W _x [cm ³]	W _y [cm ³]	
5.92	1.59	10.52	11.46	16.28	5.26	5.73	
natural, cut-off max. 3000 mm							0.0.440.50
natural, 1 pce., length 3000 mm							0.0.452.22

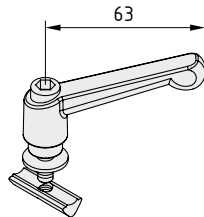

Telescope Securing Set 8 40x40

T-Slot Nut 6 St M6, bright zinc-plated
 Washer DIN 9021-6,4, St, bright zinc-plated
 Clamp lever, black
 m = 86.0 g

1 set	0.0.444.71
-------	------------

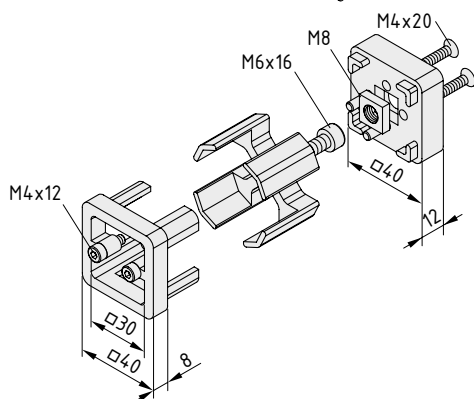

Telescope Connection Set 8 40x40

Telescope cap 8 40x40, PA, black
 Telescope sliding cap 8 40x40, PA, black
 Telescope connecting plate 8 40x40, die-cast zinc, white aluminium
 Cap Screw DIN 912-M6x16, St, bright zinc-plated
 2 Cap Screws DIN 912-M4x12, St, black
 Square nut DIN 562-M8, St, bright zinc-plated
 2 Countersunk Screws DIN 7991-M4x20, St, bright zinc-pl.
 m = 138.0 g

1 set	0.0.440.54
-------	------------



Telescope 8 80x40

This profile extends according to the task at hand

- Variable-length strut with large load-carrying capacity
- Simple height and incline adjustment for load-carrying profiles
- Maximum load up to 750 N
- Clamp lever or locking plunger as fixing mechanism



Telescope 8 80x40 is a heavy-duty strut of adjustable length. It is particularly suitable for adjusting the height or inclination of equipment. The adjustable plain bearings and extended support width also enable this telescope to be used for constructing length-adjustable table legs.

Telescope Profile 8 80x40 supports and guides the inside profile. The outer profile can be connected directly to a profile groove via its end face or using fastening elements (e.g. Hinge 8 80x40, heavy duty).

Telescope Inner Profile 8 80x40 mounted in a sliding bearing is either secured with Telescope Securing Set 8 80x40 at the desired height or is located via predrilled holes using Telescope Locking Plunger 8 80x40.

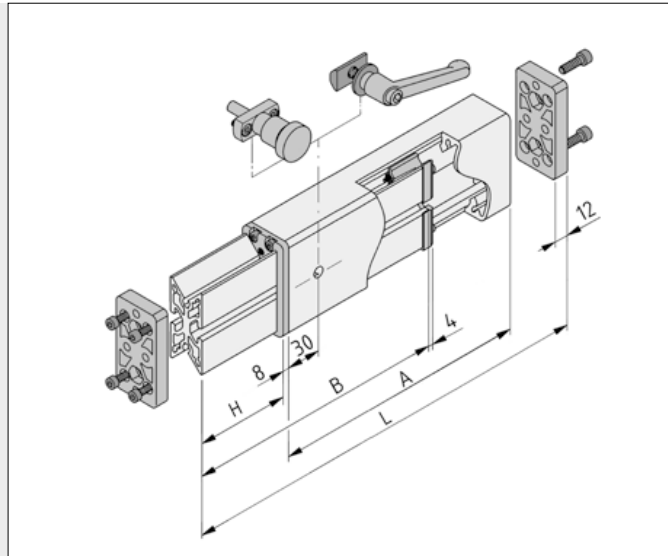

Telescope Inner Profile 8 80x40 (length B) must be 20 mm shorter than Telescope Profile 8 80x40 (length A) in order that it can be inserted completely in the assembled telescope, and stroke H thereby maximised.

$$L_{\min.} = A + 20 \text{ mm}$$

$$L_{\max.} = L_{\min.} + H$$

$$B \geq H \times 1.2 \wedge B \geq H + 60 \text{ mm}$$

$$B \leq A - 20 \text{ mm}$$

Max. load in telescope direction: 750 N

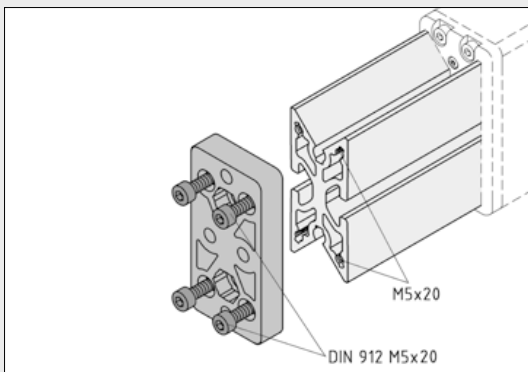

Telescope Connecting Plate 8 80x40 offers various possibilities for attaching the inside profile to a connecting structure. It is used for screw connection with Line 8 components or other parts. Suitable through holes and countersinks are provided in the Connecting Plate for this purpose.

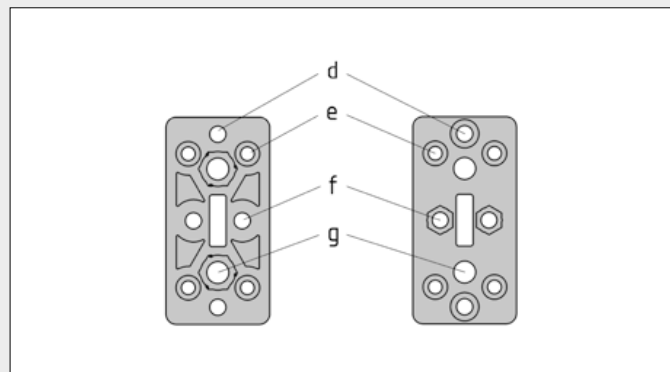

Function of the holes in the Telescope Connecting Plate:

d = Securing to Telescope Profile 8 80x40 using screws M6x22

e = Securing to Telescope Inner Profile 8 80x40 using screws DIN 7984-M5x20

f = Through hole \varnothing 6.4 for adapting other products to the Telescope Inner Profile 8 80x40

g = Through hole \varnothing 9 for adapting other products to the Telescope Profile 8 80x40 by press-fitting an M8 nut

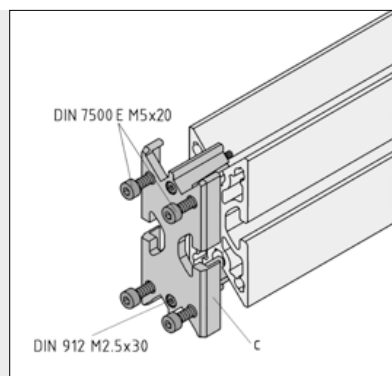
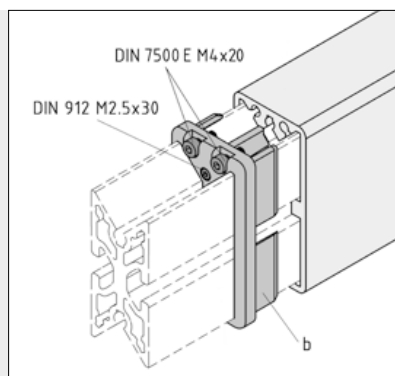
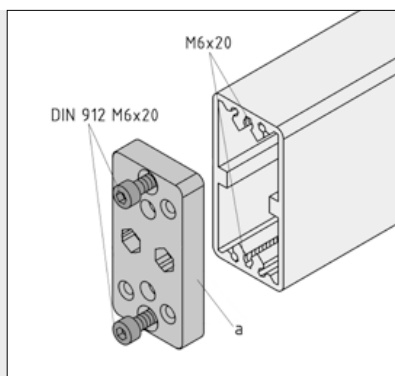

Telescope Connection Set 8 80x40 contains all components required for connecting Telescope Profile 8 80x40 and for constructing a telescope:

- a = Telescope Connecting Plate 8 80x40
- b = Telescope Cap 8 80x40
- c = Telescope Sliding Cap 8 80x40

Telescope Connecting Plate 8 80x40 is screwed to the Telescope Profile and offers various possibilities for fastening to a connecting structure.

To secure the telescope cap (with Telescope Profile 8 80x40) and telescope sliding cap (with Telescope Inner Profile 8 80x40), the Telescope Connection Set is provided with self-tapping screws DIN 7500.

After assembly of the two telescope profiles, the plain bearings of the Telescope Sliding Cap and Telescope Cap are adjusted free of play using screws M2.5x30 (1.5 A/F).

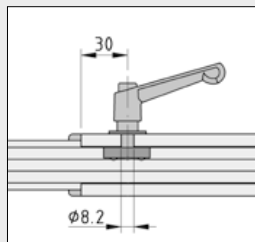

On request, your local item partner can provide the Telescope Profiles machined ready for use with the Telescope Securing Set or Telescope Locking Plunger.

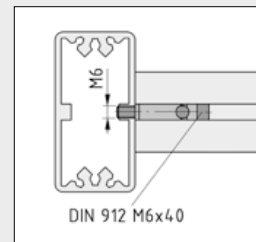
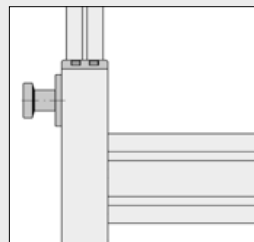
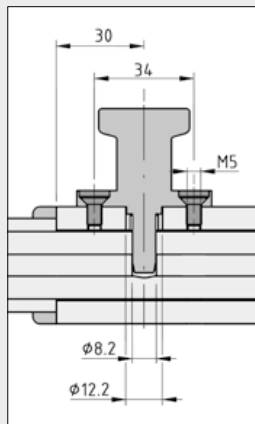

For lateral connection of Telescope Profiles 8 80x40, it is advisable to tap M6 threads in the area of the central rib and to use Automatic-Fastening Sets 8.

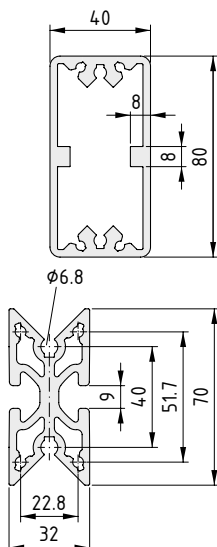

Telescope Profile 8 80x40

A [cm ²]	m [kg/m]	I _x [cm ⁴]	I _y [cm ⁴]	I _t [cm ⁴]	W _x [cm ³]	W _y [cm ³]
9.61	2.59	20.57	77.12	42.72	10.28	19.28
natural, cut-off max. 6000 mm						0.0.608.49
natural, 1 pce., length 6000 mm						0.0.604.56

Telescope Inner Profile 8 80x40

A [cm ²]	m [kg/m]	I _x [cm ⁴]	I _y [cm ⁴]	I _t [cm ⁴]	W _x [cm ³]	W _y [cm ³]
9.78	2.64	10.50	34.88	6.85	2.99	21.80
natural, cut-off max. 6000 mm						0.0.608.50
natural, 1 pce., length 6000 mm						0.0.604.57

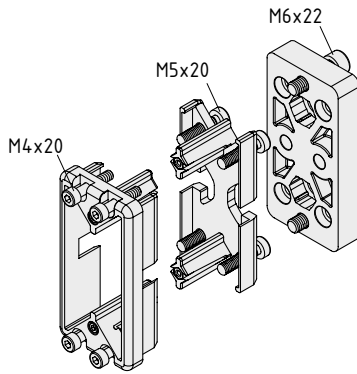

Telescope Connection Set 8 80x40



Telescope Conn. Plate 8 80x40, die-cast zinc, white alum.
 Telescope Sliding Cap 8 80x40, POM, black
 Telescope Cap 8 80x40, POM, black
 2 Cap Screws DIN 912-M6x22, St, bright zinc-plated
 4 Cap Screws DIN 7500 E-M5x20, St, bright zinc-plated
 4 Cap Screws DIN 7500 E-M4x20, St, bright zinc-plated
 m = 250.0 g

1 set

0.0.608.57

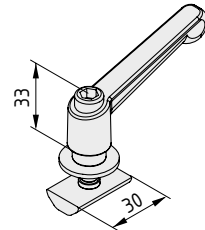

Telescope Securing Set 8 80x40



Special T-Slot Nut 8 St M6, bright zinc-plated
 Stepped threaded bolt M8/M6
 Washer DIN 9021-8,4, St, bright zinc-plated
 Clamp lever M8, black
 m = 110.0 g

1 set

0.0.608.48

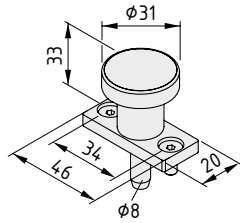

Telescope Locking Plunger 8 80x40



Locking plunger with base plate, black
 2 Countersunk Screws DIN 7991-M5x12
 m = 68.0 g

1 set

0.0.609.73

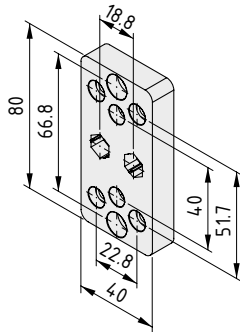

Telescope Connecting Plate 8 80x40



Die-cast zinc
 m = 190.0 g
 white aluminium, similar to RAL 9006, 1 pce.

0.0.604.60



Positioning Set

Precise positioning for monitoring material flows

- For measuring and positioning tasks
- All feed elements inside one profile groove



Adding a Positioning Set 8 40 contradiirectional and a Feed Screw M6 (contradiirectional) produces a positioning device that acts in both directions.

Turning the Handwheel in clockwise direction moves the positioning slide away from the user (the contradiirectional additional slide moves towards the positioning slide).



The optional Digital Position Indicators (4) (mechanical or electronic counter) enable precise positional adjustment of the Positioning Set.

The mechanical position indicator provides a digital indication of the positioning distance (one revolution of the handwheel corresponds to a distance of 1 mm, resolution 0.1 mm).

The electronic position indicator has a measuring accuracy of 0.01 mm. It can be calibrated by the user and provides a simple means of measuring the absolute value and incremental dimensions.

N.B.: The Positioning Set combined with the position indicator is not a measuring device! It is used instead for setting predefined positions for e.g. repeat assembly operations.

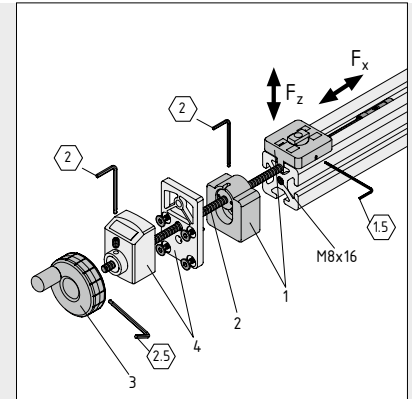

The basic components for an adjustment device include the Positioning Set 8 40 (1), the associated Feed Screw M6-LH (2) and the Handwheel D50 (3).

Attachments are secured to the positioning slide using either anti-torsion positive locking in a groove of Line 8 or a screw connection (M6).

Setscrews can be accessed from the side and are used to adjust the vertical play of the slide in the guide groove.

The maximum pressure loading F_x in the direction of movement is 200 N; perpendicular to the groove, a compressive force of 100 N and a tensile force of 50 N (F_z direction) may act on the slides.

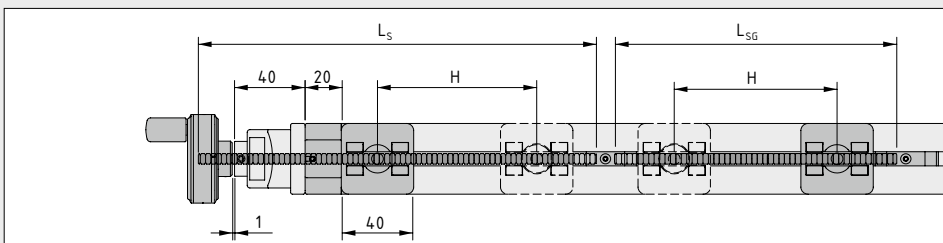

The length of Feed Screw L_s is determined as a function of the adjustment distance H and the accessory components:

- $L_s = H + 130$ mm (with Digital Position Indicator)
 - $L_s = H + 90$ mm (without Digital Position Indicator)
- The length of the contradiirectional Feed Screw is:
 $L_{sg} = H + 67$ mm

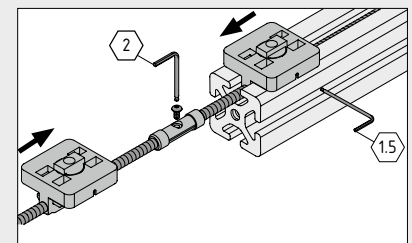

Space-saving contradiirectional adjustment systems can be built extremely rapidly thanks to the combination of a positioning set and contradiirectional positioning set.

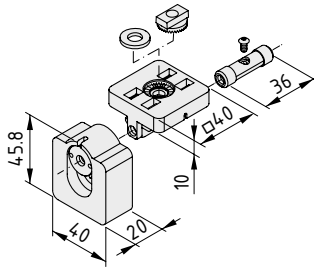

Positioning Set 8 40



Bearing Block, PA, black
 Slide with anti-torsion feature, PA, black
 Washer, St, bright zinc-plated
 Coupling M6, St, bright zinc-plated
 Notes on Use and Installation
 m = 85.0 g

1 set 0.0.616.65

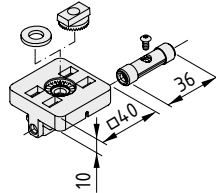

Positioning Set 8 40 contradiirectional



Slide with anti-torsion feature, PA, black
 Washer St, bright zinc-plated
 Coupling M6, St, bright zinc-plated
 m = 35.0 g

1 set 0.0.616.64

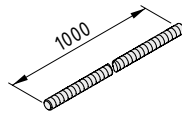

Positioning Set 8 40 Feed Screw M6-LH



St, stainless
 m = 180.0 g

stainless, 1 pce., length 1000 mm 0.0.615.69

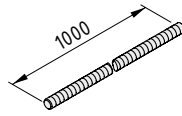

Positioning Set 8 40 Feed Screw M6 (contradiirectional)



St, stainless
 m = 180.0 g

stainless, 1 pce., length 1000 mm 0.0.616.63

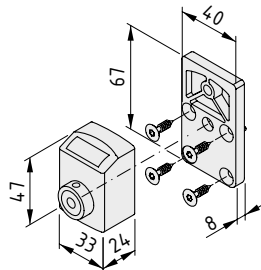

Digital Position Indicator D6 mechanical



Counter, mechanical
 Adapter plate, PA, black
 Seal, self-adhesive
 4 Countersunk Screws 4.2x16 St, bright zinc-plated
 m = 100.0 g

1 set 0.0.619.72

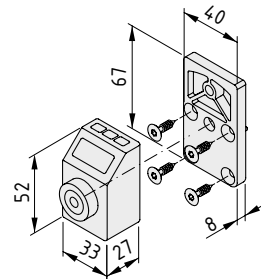

Digital Position Indicator D6 electronic



Counter, electronic, with zeroing, chain-dimension and calibration function
 Adapter plate, PA, black
 Seal, self-adhesive
 4 Countersunk Screws 4.2x16 St, bright zinc-plated
 m = 115.0 g

1 set 0.0.619.71

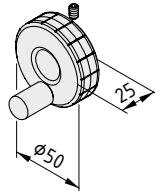

Positioning Set 8 40 Handwheel D50



PA
 m = 46.0 g

black, 1 pce. 0.0.616.69



Pivot Arm 8 370, light Double Pivot Arm 8 695

- For light loads
- For keeping frequently used equipment close to hand
- Double Pivot Arm for added reach



Our lightweight option for improved ergonomics – the item Pivot Arm 8 370.
This stable Pivot Arm can be fitted to an Upright on any of the new item work benches easily. The braking torque can be individually adjusted at each joint, enabling you to tailor the manoeuvrability of the Pivot Arm to your needs. The End Swivel Joint can be rotated 360°.
The Pivot Arm can reach approximately 370 mm. It can accommodate a maximum (vertical) load of 120 N.

The Double Pivot Arm 8 695 from item – for double the reach and maximum flexibility!
Both arms are connected via a swivel joint in order to increase the pivot radius. The robust End Swivel Joint can be connected to the end face or groove of a Profile 8. The Double Pivot Arm should only be fitted to vertical profile grooves.
The Double Pivot Arm can reach approximately 695 mm and the maximum vertical load is 80 N.

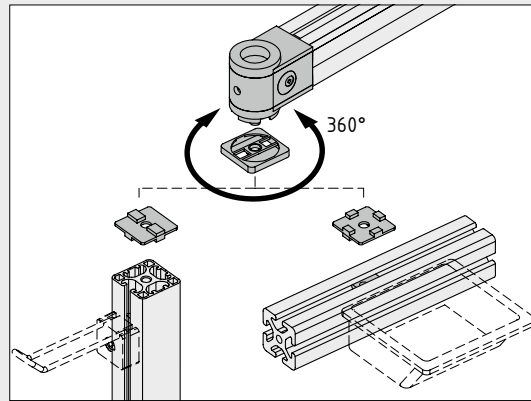

The connection can be made with either a horizontal or vertical profile groove. An end-face connection with Profiles is also possible. All the joints can be rotated through 360° and their frictional moment can be adjusted.

13

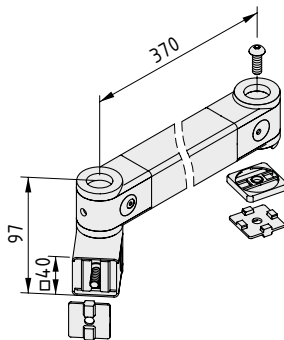

Pivot Arm 8 370 light

- Profiles 8 40x40 3N light
- Standard Swivel Joint (mounting joint)
- End Swivel Joint
- Connecting cover, PA, grey
- 2 Connecting Plates, Al, natural
- Button-Head Screw M8x22, St, bright zinc-plated
- Notes on Use and Installation
- m = 1.4 kg

1 pce.

0.0.631.17

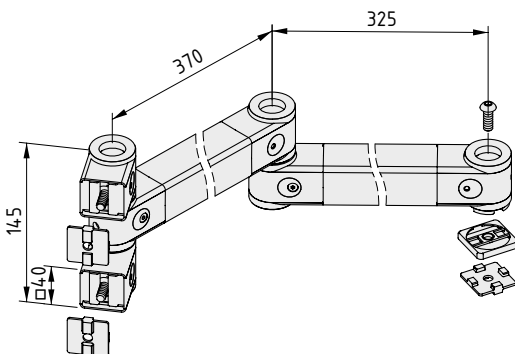

Double Pivot Arm 8 695

- Profiles 8 40x40 3N light
- Double Swivel Joint 40 (mounting joints)
- Standard Swivel Joint (middle joint)
- End Swivel Joint
- Connecting cover, PA, grey
- 3 Connecting Plates, Al, natural
- Button-Head Screw M8x22, St, bright zinc-plated
- Notes on Use and Installation
- m = 2.7 kg

1 pce.

0.0.631.19





Double Pivot Arm 8 695 heavy-duty

- Suitable for loads up to 140 N
- End Swivel Joint can be rotated through 360°



Double Pivot Arm 8 695 heavy-duty – move even heavy loads safely!

The heavy-duty Double Pivot Arm is connected to a simple Pivot Arm via a Double Swivel Joint in the middle. The two mounting joints can be connected to any Profiles 8. The heavy-duty Double Pivot Arm should only be fitted to vertical profile grooves.

The Pivot Arm can reach approximately 695 mm. It can accommodate a maximum (vertical) load of 140 N.

The End Swivel Joint can be rotated through 360° for maximum versatility.

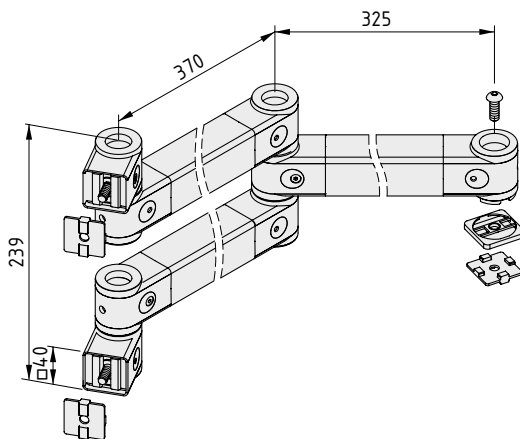

Double Pivot Arm 8 695 heavy-duty



Profiles 8 40x40 3N light
 2 Standard Swivel Joints (mounting joints)
 Double Swivel Joint 40 (middle joint)
 End Swivel Joint
 Connecting cover, PA, grey
 3 Connecting Plates, Al, natural
 Button-Head Screw M8x22, St, bright zinc-plated
 Notes on Use and Installation
 m = 3.7 kg

1 pce.

0.0.631.20



Friction Joints 8

- For building customised pivot arms
- With adjustable friction brake



The Friction Joints in the standard Pivot Arms from item ensure that the supporting strut holds firm, moves smoothly and can be brought safely to a halt. Individual Friction Joints can be connected together with Profiles 8 to create customised solutions. When building such solutions, it is important to take note of the load limitations imposed by the leverage in the pivot arms. Single and double swivel joints are available.

The braking action of the Friction Joints is easily adjusted and remains consistent over an extended period of use. The radius of swivel is 360°.

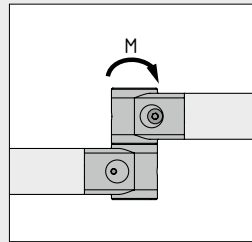

The maximum torque load for a Standard Swivel Joint and End Swivel Joint is 45 Nm, while Double Swivel Joint 40 can carry loads of up to 60 Nm.

13

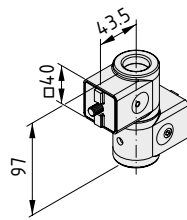

Friction Joint 8, Standard Swivel Joint



2 Friction Joints
 2 mounting plates, Al, natural
 2 Button-Head Screws M8x22, St, bright zinc-plated
 Notes on Use and Installation
 m = 503.0 g

1 pce.

0.0.623.88

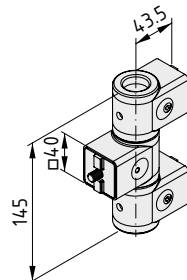

Friction Joint 8, Double Swivel Joint 40



3 Friction Joints
 3 mounting plates, Al, natural
 3 Button-Head Screws M8x22, St, bright zinc-plated
 Notes on Use and Installation
 m = 770.0 g

1 pce.

0.0.623.89

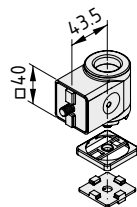

Friction Joint 8, End Swivel Joint



Friction Joint
 2 mounting plates, Al, natural
 2 Button-Head Screws M8x22, St, bright zinc-plated
 Connection seal, PA, grey
 Notes on Use and Installation
 m = 300.0 g

1 pce.

0.0.623.92



Frame Profile 8 40x20

- Stable, continuous edging for panel elements
- For drawers or workpiece carriers
- As edge protection for shelving



Shelving at the workplace and on the material trolley ensures parts are available to users when they need them. Workpiece carriers, enclosed in a frame, may be employed on transfer units to protect the goods being transported. Frame Profile 8 40x20 provides a stable means of holding and securing a plastic or metal panel element (up to 4 mm thick). The corner fasteners connect seamlessly with the frame

profiles and enable panels to be inserted easily across both without need for processing. After the frame has been closed, the panel is secured with a flexible Retaining Cord to prevent movement.

Installation tip: It is best to moisten the Retaining Cord with soapy water to ensure it can be pressed in easily.

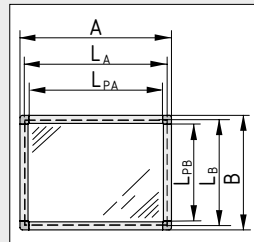
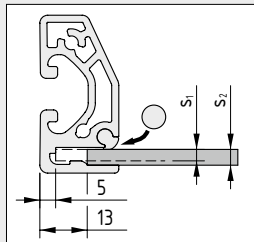

	$S_1 = 2 - 3.2 \text{ mm}$	$S_2 = 3.2 - 4 \text{ mm}$
L_A [mm]	A - 10	A - 26
L_B [mm]	B - 10	B - 26

The cut-off dimensions of panel elements (L_A , L_B) are dependent on the thickness s .

An external Profile 8 groove can be used to secure the frame profile to the basic frame of the table or material trolley, e.g. using Angle Locking Bracket 8 80x40.

The Corner-Fastening Set Frame is screwed into the screw channels in the frame profile using the self-tapping screws without any need for profile processing ($M = 2 \text{ Nm}$).

Calculating the profile cut-off length:

$$L_{PA} = A - 44 \text{ mm}$$

$$L_{PB} = B - 44 \text{ mm}$$

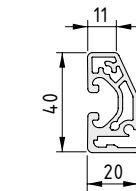

Frame Profile 8 40x20



Al, anodized
m = 880 g/m

natural, cut-off max. 6000 mm 0.0.616.95

natural, 1 pce., length 6000 mm 0.0.616.93

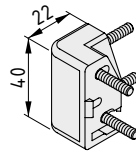

Corner-Fastening Set Frame 8 40x20



Corner fastener, die-cast zinc, RAL 9006 white aluminium
4 Hexagon Socket Head Cap Screws M4x20, self-tapping, St, bright zinc-plated
Cap, PA, grey
m = 54.0 g

1 set 0.0.618.61



Retaining Cord D6

NBR
m = 10 g/m

grey, cut-off max. 20 m 0.0.622.12

grey, 1 roll length 20 m 0.0.621.77



Shelf 8

- High load-carrying capacity
- Easy to fit to a profile groove



Do you need storage space at your work benches or production facilities? It doesn't get any easier than with shelves from item: simply slot into Profile 8 groove, secure in place with a flick of the wrist and that's it – done!

But what if a horizontal Profile 8 groove isn't available? All you need is Shelf Adapter Set 8. Fitted with just 2 screws, the system can carry a maximum load of 500 N per shelf.

Shelves 8 200 and 320 are prepared ready for use in a width of 600 mm, with fitted End Caps and grub screws to prevent removal. In the Shelf Profile: Profile 5 groove for end supports, partitions and side connection and fastening.

Shelf Profiles are also available to your specifications in any length (up to 6 m).

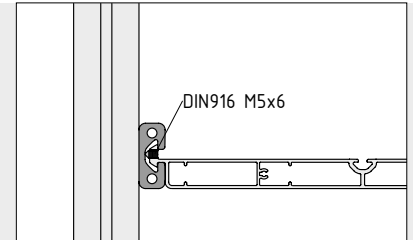
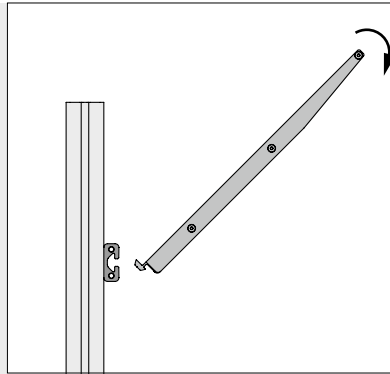

Shelf Adapter Set 8 is the universal fastening system for your shelves – even if you don't have a Profile 8 groove available.

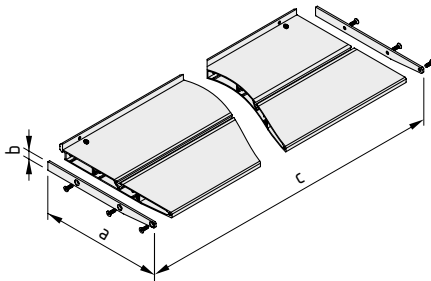

Shelf 8 200-600

Shelf 8 200, Al, natural
Shelf Cap Set 8 200, St, black
2 grub screws DIN 916-M5x6, St, bright zinc-plated
a = 200 mm b = 14 mm c = 600 mm m = 1.7 kg

1 set 0.0.627.00

Shelf 8 320-600

Shelf 8 320, Al, natural
Shelf Cap Set 8 320, St, black
2 grub screws DIN 916-M5x6, St, bright zinc-plated
a = 320 mm b = 18 mm c = 600 mm m = 2.9 kg

1 set 0.0.626.97

Shelf Profile 8 200

Al, anodized

A [cm ²]	m [kg/m]	I _x [cm ⁴]	I _y [cm ⁴]	W _x [cm ³]	W _y [cm ³]
9.28	2.51	2.96	361.60	1.99	33.45

natural, cut-off max. 6000 mm 0.0.618.53

natural, 1 pce., length 6000 mm 0.0.618.56

Shelf Profile 8 320

Al, anodized

A [cm ²]	m [kg/m]	I _x [cm ⁴]	I _y [cm ⁴]	W _x [cm ³]	W _y [cm ³]
15.13	4.10	7.83	142.10	4.68	84.03

natural, cut-off max. 6000 mm 0.0.621.00

natural, 1 pce., length 6000 mm 0.0.620.94

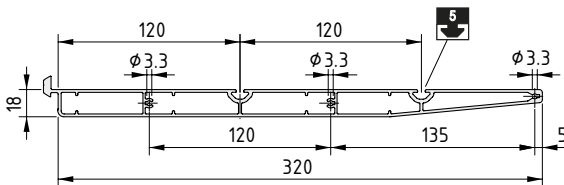
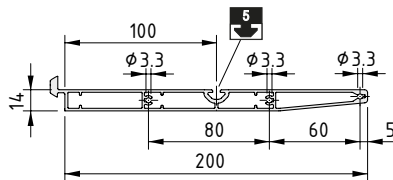

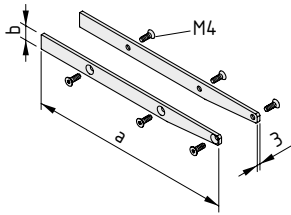
**Shelf Cap Set 8 200**

2 shelf caps 8 200, St, black
 6 Countersunk Screws DIN 7991-M4x12, St, bright zinc-plated
 a = 200 mm b = 14 mm m = 120.0 g

1 set

0.0.623.27

Shelf Cap Set 8 320

2 shelf caps 8 320, St, black
 6 Countersunk Screws DIN 7991-M4x12, St, bright zinc-plated
 a = 320 mm b = 18 mm m = 250.0 g

1 set

0.0.623.30

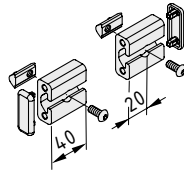
**Shelf Adapter Set 8**

Adapter Profile 8 40x16, Al, natural
 2 Button-Head Screws M6x14, St, bright zinc-plated
 2 Caps 8 40x16, PA-GF, black
 2 T-Slot Nuts V 8 St M6, bright zinc-plated
 m = 120.0 g

1 set

0.0.627.14



Container Mounting

- A quick-action fixing for connecting Parts Containers to a Line 8 groove
- Practical and universal



Any kind of containers with wall thicknesses of up to 5 mm can be mounted between two profiles.

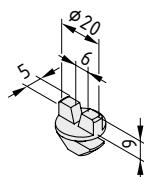
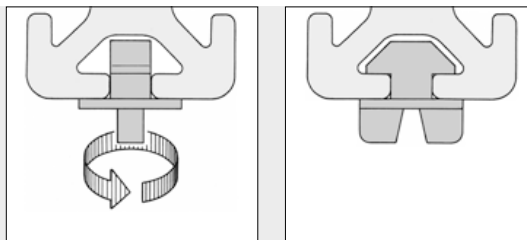

Container Mounting 8

PA-GF

m = 3.0 g

black, 1 pce.

0.0.026.87



Runner

- Movable hanger for lightweight equipment
- Improved ergonomics for tools



Hanger which can be moved along the profile groove and is used for suspending tools, balancers etc.

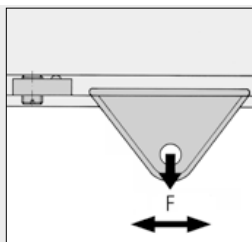

A T-Slot Nut is recommended as the end stop. It is secured in the groove by the grub screw.

$F_{max.} = 50 \text{ N}$

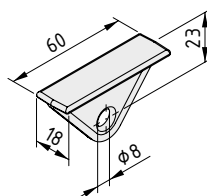

Runner 8

PA-GF

m = 8.0 g

black, 1 pce.

0.0.026.13





Runner 8

- Strong hanger
- Easy movement thanks to low-friction slide elements



Runner 8 is a simple model with a load-carrying capacity of 50 N that is suspended from a Profile 8 groove.

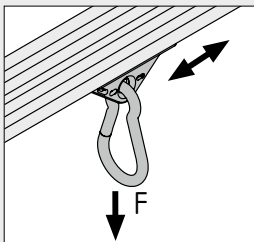

The corrosion-resistant Spring Hooks enable easy attachment to the Runner and rapid tool changes.

- Spring Hook 60 D6: Recommended max. tensile force $F = 100\text{ N}$
- Spring Hook 80 D8: Recommended max. tensile force $F = 200\text{ N}$

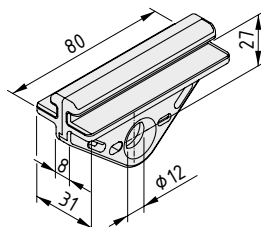

Runner 8 80x40

2 runner halves, PA-GF, black
2 slide elements, POM, natural
 $m = 39.0\text{ g}$

1 set

0.0.618.97

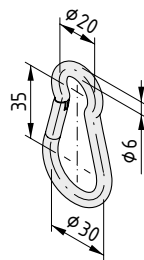

Spring Hook 60 D6

St
Spring hook similar to DIN 5299
 $m = 25.4\text{ g}$

stainless, 1 pce.

0.0.619.68

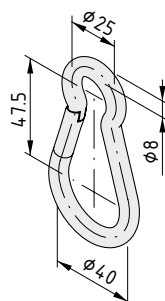

Spring Hook 80 D8

St
Spring hook similar to DIN 5299
 $m = 67.0\text{ g}$

stainless, 1 pce.

0.0.619.70





Magnetic Holder 8

- Holds tools and accessories against a Line 8 groove
- Practical and easy to use thanks to use of magnets



Its pull is irresistible – the item Magnetic Holder!
 For securely stowing metallic objects such as spanners, etc. on the groove of the non-magnetic aluminium Profile. Magnetic Holder 8 can be fitted into a Profile 8 groove in next to no time.
 Holding force $F = 40 \text{ N}$

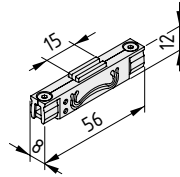

Magnetic Holder 8



Magnet housing half 8, PA-GF, grey, similar to RAL 7042
 2 magnets 20x5x2, St, nickel-plated
 2 Magnetic Stops 8, terminal shoes, St, bright zinc-plated
 2 Countersunk Screws DIN 7991-M3x10, St, bright zinc-plated
 2 square nuts DIN 562-M3, St, bright zinc-plated
 $m = 18.0 \text{ g}$

grey similar to RAL 7042, 1 pce.

0.0.627.86



Document Holder

From clipboard to poster

- For working, workflow and design plans
- Frame and holder in various sizes
- Clamping function enables users to change documents rapidly
- Available with protective panel if required



The Document Holder system is used for constructing display and information panels of any size in the workplace or the training area. The panels can be attached directly to a frame construction made of aluminium profiles, e.g. to a work bench in the production area. The Document Holder can also be used to construct fixed or moveable panels on appropriate frame structures.

The system consists of two aluminium profiles that are interconnected using an integrated spring-loaded hinge. The Document Holder Support Profile forms the fixed frame which also secures the rear panel. This frame is fixed onto basic constructions made up of Line 8 Profiles using Clip 8 St. The spring-loaded Lid Profile firmly clamps documents and can securely hold an optional acrylic glass panel to protect documents.

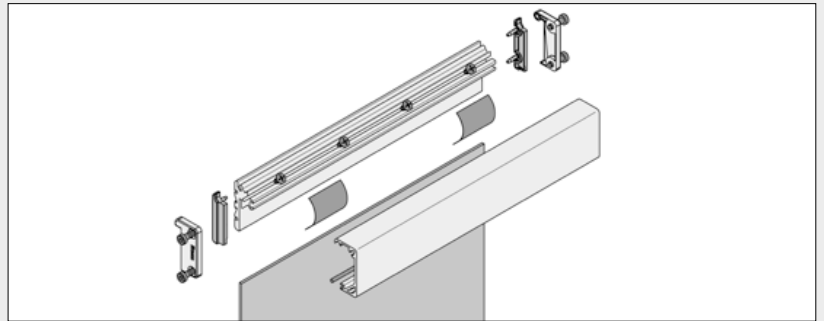
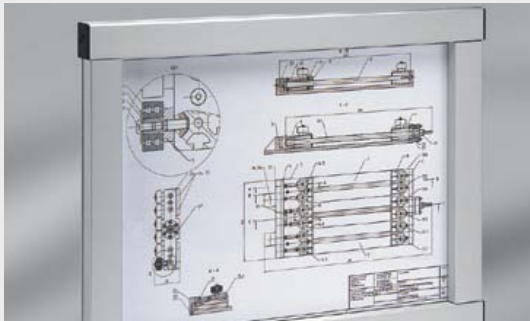

Document Holders can be constructed in any sizes as either clipboards or frames for documents. item's sales partners provide design assistance and supply either individual components, complete frames or building kits. The tables overleaf show the dimensions required for Document Holders together with the various sizes.

The rear panel (thickness 2 mm) is clamped to the Support Profile by driving the Countersunk Screws DIN 7982 St 3.9x9.5 into the screw channel.

Retaining Cord D2.5 is inserted into the Lid Profile to prevent the document from moving. Greasing the contact surfaces of the leaf springs in the Profiles is recommended.

13

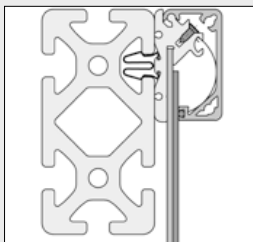

The Document Holder Support Profile is fixed onto basic constructions made up of Line 8 Profiles using Clip 8 St.

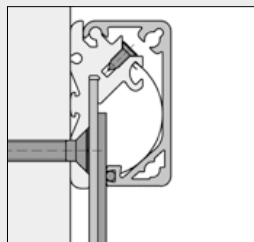

The Support Profile can also be secured to any surface using a Countersunk Screw.

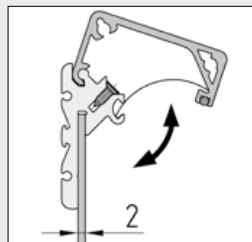

The Lid Profile opens and closes to clamp the Document Holder. The leaf springs hold the lid in place at its two extreme positions. The document is held in place by simply closing the Lid Profile as illustrated.

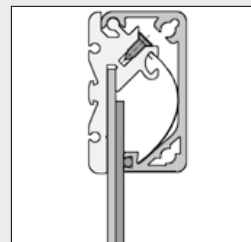

A protective panel can be used in Document Holder frames that are enclosed on all sides. This too is held in position by the Lid Profile.

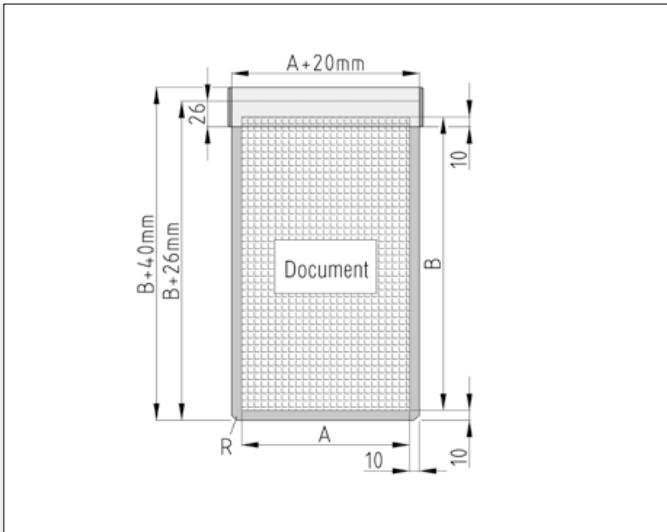

Calculating the number and lengths of the individual components for constructing Document Holders in the form of a clipboard.

	Qty.	Length [mm]	Length [mm]
Rear panel (R)	1	A+20	B+26
Support Profile	1	A+20	
Lid Profile	1	A+20	
Retaining Cord	1	A+20	
Leaf Springs	$\frac{A}{100}$		
Countersunk Screws 3,9x9,5	$\frac{A}{50}$		

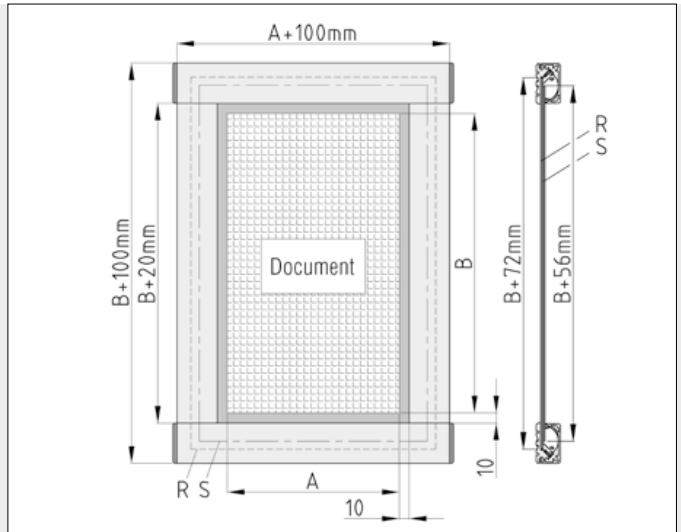

Calculating the number and lengths of the individual components for constructing Document Holder Frames.

	Qty.	Length A [mm]	Length B [mm]
Rear panel (R)	1	A+72	B+72
Protective panel (S)	1	A+56	B+56
Support Profile, horiz.	2	A+100	
Support Profile, vert.	2		B+20
Lid Profile, horiz.	2	A+100	
Lid Profile, vert.	2		B+19.5
Leaf Springs	$\frac{A+B}{100}$		
Countersunk Screws 3,9x9,5	$\frac{A+B}{50}$		

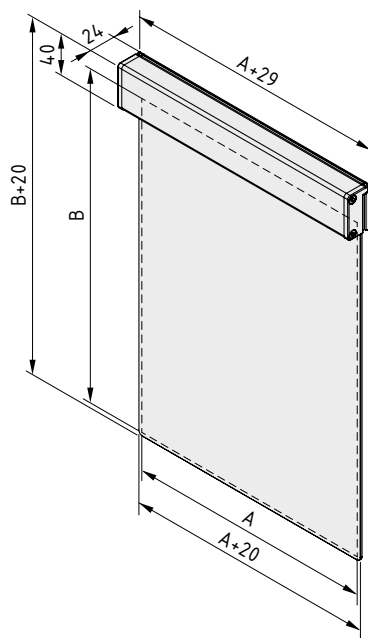

Document Holder 8 A4

Fully assembled (excluding protective panel)
 Document dimension A = 210 mm
 Document dimension B = 300 mm
 m = 0.7 kg

1 set 0.0.476.22

Document Holder 8 A3

Fully assembled (excluding protective panel)
 Document dimension A = 420 mm
 Document dimension B = 300 mm
 m = 1.3 kg

1 set 0.0.476.23

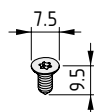
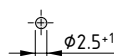
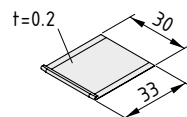
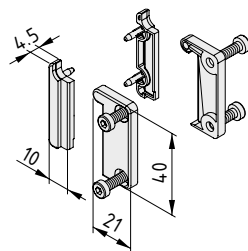
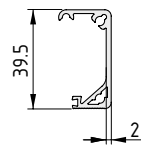
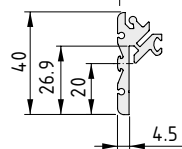
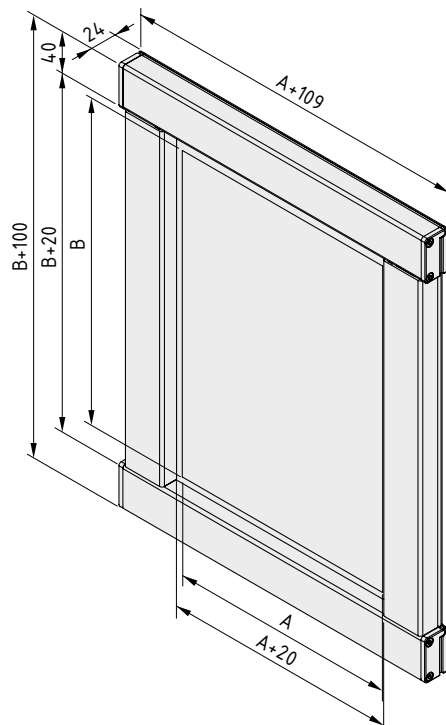

Document Holder 8 Frame A4	
Fully assembled (including protective panel PMMA) Document dimension A = 210 mm Document dimension B = 300 mm m = 2.3 kg	
1 set	0.0.476.24
Document Holder 8 Frame A3	
Fully assembled (including protective panel PMMA) Document dimension A = 420 mm Document dimension B = 300 mm m = 3.4 kg	
1 set	0.0.476.25
Document Holder 8 Support Profile	
Al, anodized m = 0.68 kg/m	
natural, cut-off max. 3000 mm	0.0.485.90
natural, 1 pce., length 3000 mm	0.0.454.47
Document Holder 8 Lid Profile	
Al, anodized m = 0.47 kg/m	
natural, cut-off max. 3000 mm	0.0.485.92
natural, 1 pce., length 3000 mm	0.0.454.48
Document Holder 8 Cap Set	
Cap Set right, PA-GF, black Cap Set left, PA-GF, black 4 Hexagon Socket Head Cap Screws DIN 6912-M4x12, black m = 12.0 g	
1 set	0.0.485.76
Document Holder 8 Leaf Spring	
St m = 1.2 g	
stainless, 1 pce.	0.0.486.76
Retaining Cord D2.5	
Elastomer, resistant to oils, water and cleaning agents m = 6 g/m	
clear, cut-off max. 10 m	0.0.485.88
clear, 1 roll length 10 m	0.0.485.89
Countersunk Screw, self-threading DIN 7982 St 3.9x9.5, TX 15	
St m = 0.8 g	
stainless, 1 pce.	8.0.008.09



Notice Holder A4, magnetic

- Protects documents from soiling
- Magnetic frame holds documents in place, even in draughts
- Available in four different colours

The new magnetic Notice Holder – important information where you need it and when you need it!
 These Notice Holders protect your notices and allow you to display important information on any suitable ferrous surface, such as item Compound Material St.
 The Notice Holders are made from hard-wearing transparent film and have a magnetic frame. Size approx. 320x232 mm.
 Available in grey, yellow, green and red.

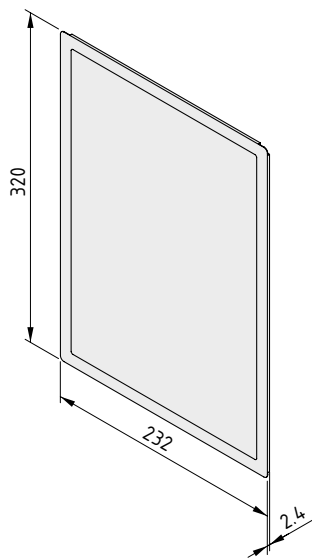

Notice Holder A4, magnetic

Rigid PVC film, 0.4 mm, non-reflective
 Magnetic strips
 m = 120.0 g

grey, 1 pce.	0.0.635.11
yellow, 1 pce.	0.0.636.61
green, 1 pce.	0.0.636.62
red, 1 pce.	0.0.636.63



Monitor Adapter

Universal fixing for flatscreen monitors

- Compatible with VESA standard
- Anti-torsion fastening to profile grooves



The Monitor Adapter enables flatscreens to be installed (with standard fastening VESA 75 or 100) on work bench systems or production control stations. The connection geometry employs the modular dimension of Line 8 profiles and thus enables use of typical fastening elements (Line 8 profiles, Hinge 8 40x40 heavy duty, etc.). Optional anti-torsion features secure the set position through positive locking.

Monitor Adapter 8 VESA 75-100 PA is manufactured from ESD plastic, which prevents electrostatic charges from building up and enables a slow rate of discharge to protect sensitive components.

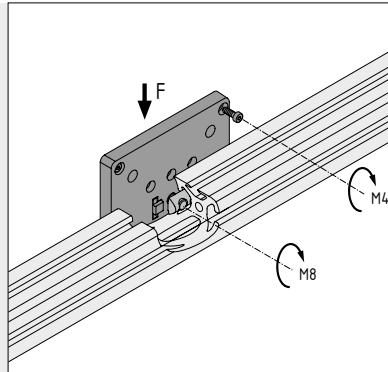

Maximum permissible load of Monitor Adapter 8 VESA 75-100 PA:

$$F_{\max} = 120 \text{ N}$$

Screws M8: $M_{\max} = 8 \text{ Nm}$

Screws M4: $M_{\max} = 3 \text{ Nm}$

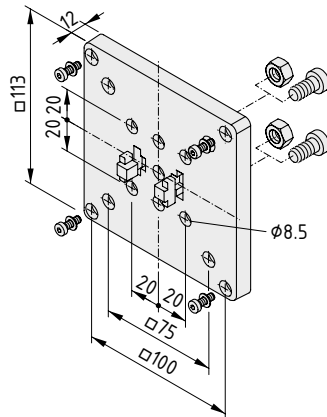

Monitor Adapter 8 VESA 75-100 PA



- Adapter Plate, PA-GF, black
- 2 anti-torsion lugs, die-cast zinc, bright zinc-plated
- 4 screws M4x12, St, bright zinc-plated
- 4 washers $\varnothing 4.3$, bright zinc-plated
- 2 Hexagon Socket Head Cap Screws M8x16, St, bright zinc-plated
- 2 hexagon nuts M8, St, bright zinc-plated
- $m = 150.0 \text{ g}$

1 set

0.0.615.48



PC Mount and Keyboard Shelf

- Secure fixing for keyboard and computer
- Keyboard Shelf with fold-out mouse rest
- Pull-out rails for tidy fixtures

Both PC and keyboard can be safely and securely fastened with the optimum mounting devices from item. Fasten the PC Mount below the working surface and simply place your computer into the holder. The PC Mount can be adjusted to accommodate various housing sizes and can be pulled out and rotated using additional pull-out rails under the table. As a result, your computer stays easily accessible for maintenance and cleaning at all times.

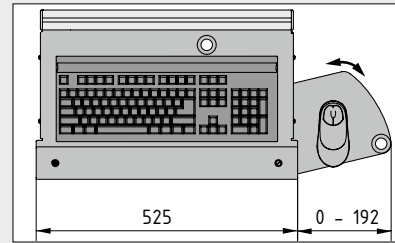

The Keyboard Shelf holds the computer keyboard and mouse. It can be fitted securely to Pivot Arms or an area in the work bench handling zone via its screw fastening. A special Fastening Set is also available to convert the Keyboard Shelf to a retractable version which fits neatly under the working surface.

The mouse rest can be fitted to the right or left of the Keyboard Shelf.

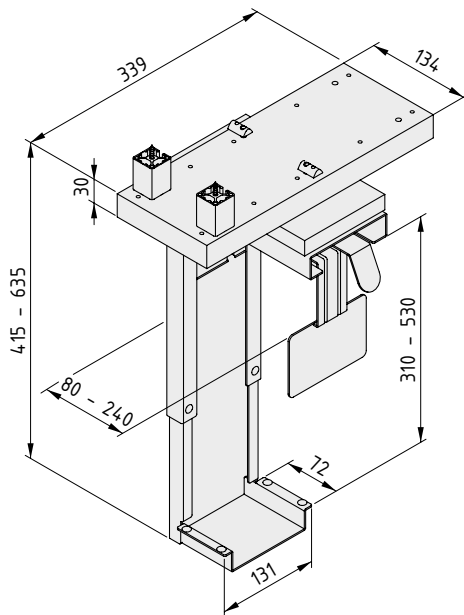

PC Mount

- Mount with pull-out rail and rotating element, St, white aluminium
- 2 Countersunk Screws 5x60, St, bright zinc-plated
- 2 spacers, Al, natural
- 2 Button-Head Screws M6x14, St, bright zinc-plated
- 2 T-Slot Nuts 8 St M6, bright zinc-plated
- Notes on Use and Installation
- m = 5.8 kg

1 set

0.0.631.70

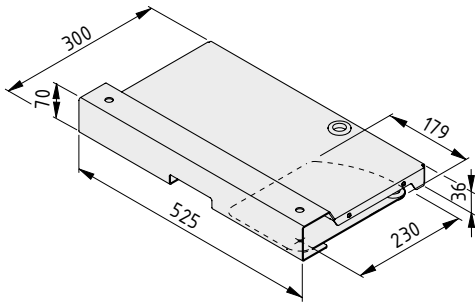

Keyboard Shelf

Keyboard Shelf 500x200, Al, powder-coated white aluminium
 Mouse rest suitable for R/L fitting, folds out
 2 cable holes 23x30x2 mm
 Washer 6x54x2 mm
 Book screw M4x5
 m = 1.8 kg

1 pce.

0.0.620.87

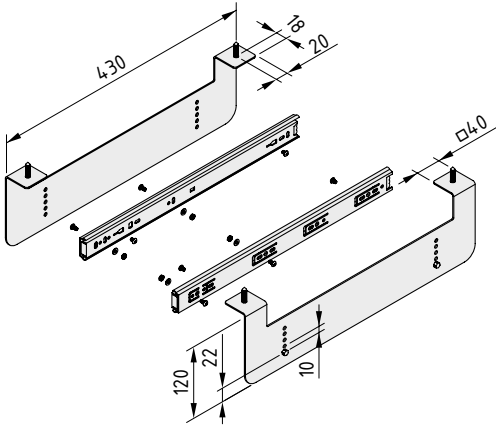

Fastening Set Keyboard Shelf

2 telescopic rails 400 TA, St, bright zinc-plated
 2 retaining plates, St, white aluminium, similar to RAL 9006
 Fastening materials
 Notes on Use and Installation
 m = 2.1 kg

1 set

0.0.637.05



Label Holder

- Bring order to shelves and drawer units
- Simply clip into Profiles 8

Label Holder 8 160x40 is used for attaching labels to shelves, work benches and fixtures. It consists of the Label Profile, which has a protective strip and end caps, and two Clips 8 St.

The Label Holder takes paper labels 36 mm high that can be customised at will. The transparent strip protects the labels against soiling.

The Label Profile can also be cut to length and used for constructing Label Holders of any desired length. The Label Profile is then sealed by end caps.

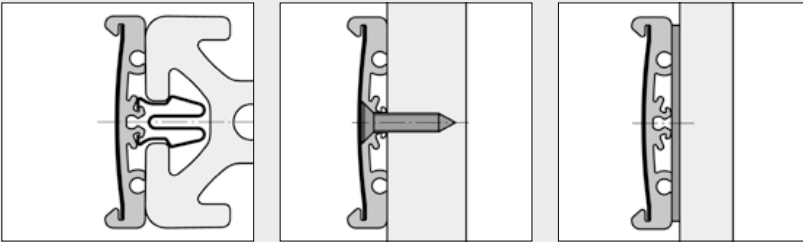

Label Holder 8 can be secured to different structures:

- with Clip 8 St to Line 8 Profile grooves
- with a Countersunk Screw to walls and panels and to profile grooves of other Lines
- with double-sided adhesive tape (width 36 mm) to panel elements

Clip 8 St

69

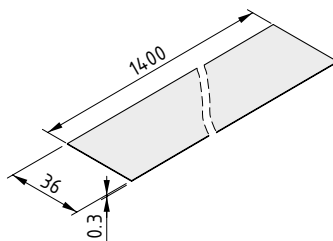
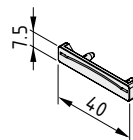
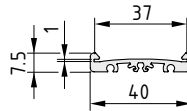
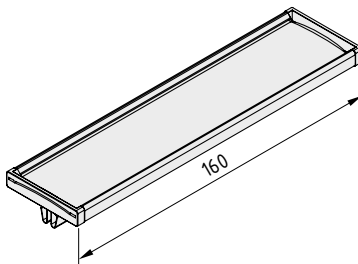

Label Holder 8 160x40

Label Profile 8 40, length 152 mm
2 Label Profile Caps 8 40
Label Protection Strip 8 40, length 152 mm
2 Clips 8 St
m = 66.0 g

1 set 0.0.488.70

Label Profile 8 40

Al, anodized
m = 0.37 kg/m
natural, 1 pce., length 3000 mm

0.0.454.59

Label Profile Cap 8 40

PA-GF
m = 1.0 g
black, 1 pce.

0.0.488.56

Label Protection Strip 8 40

PVC
m = 14.3 g/m
transparent, 1 pce., length 1400 mm

0.0.488.63



Light Fitting 55W

- Bright working light that meets the highest safety standards
- Extremely easy to position thanks to pivot function
- Flexible connection concept for power supply



Sturdy Light Fitting for illumination of workplaces and machines. The integrated swivel profile with Line 8 system groove supports 7 setting angles.

The Light Fitting can be powered from a 230 V AC or 120 V AC source and is VDE-ENEC safety-approved. When fitted with the impact-resistant Polycarbonate Protective Panel and sealing cap, the Light Fitting complies with IP 40-EN 60529.

All electrical connecting elements are approved for a rated voltage of 250 V AC with a rated current of 16 A.

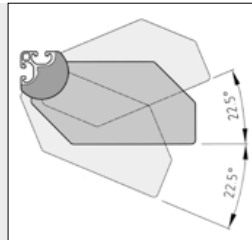

To allow the Light Fitting to be adjusted to individual applications, it can be locked in various positions over a swivel range of $\pm 22.5^\circ$ from 0° .

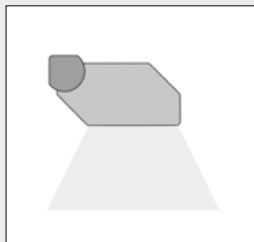

Light distribution by the Light Fitting (side view)		
Distance [mm]	Beam-width [mm]	E [Lux]
500	1000	3500
900	1800	1250
1300	2600	700
1700	3400	500

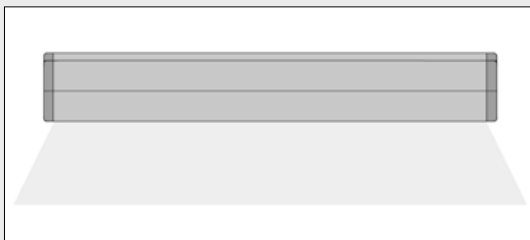

Light distribution by the Light Fitting (front view)		
Distance [mm]	Beam-width [mm]	E [Lux]
500	750	3500
900	950	1250
1300	1150	700
1700	1350	500



The Light Fitting can be sealed against dust (IP 40) by means of the Protective Panel. This panel also protects the Light Fitting against soiling and damage. The open socket must be sealed with a cap.

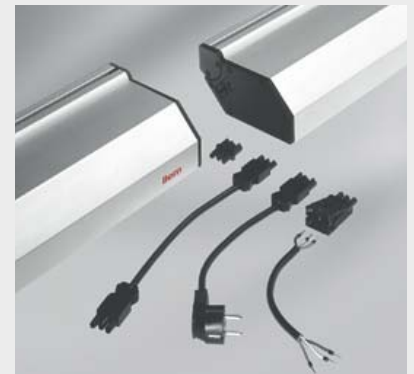

The Connecting Cable is used to connect the power supply to an earthed plug. The socket can be used to power the Light Fitting from any line network which is in place. The wires are held securely in the socket by means of a spring-force connection. If several Light Fittings are connected end-to-end, the power is fed from one Light Fitting to another by means of the Adapter. The dowel which is inserted into a mounting hole in the cap provides a mechanical link between the Light Fittings. If several Light Fittings positioned separately are connected in series and share a common power supply, the Light Fittings are interconnected using the Extension Cable which is available prefitted with appropriate connectors in a standard length of 2 m, or alternatively a customised version may be made using a plug and socket.

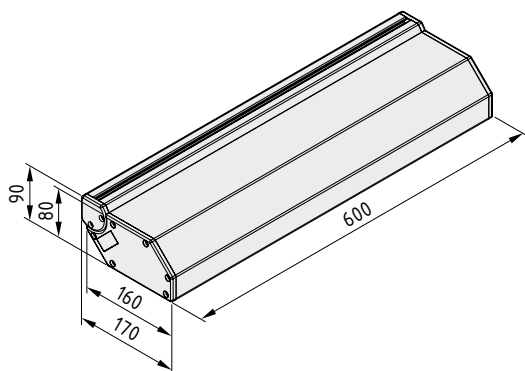

Light Fitting 55W, 230V



On/off switch
 55W compact fluorescent lamp
 Electronic Lamp-Control Unit
 60° parabolic reflector grid
 Socket lock
 Notes on Use and Installation
 m = 3.7 kg

1 pce. 0.0.417.34

Light Fitting 55W, 120V



On/off switch
 55W compact fluorescent lamp
 Electronic Lamp-Control Unit
 60° parabolic reflector grid
 Socket lock
 Notes on Use and Installation
 m = 3.7 kg

1 pce. 0.0.417.58

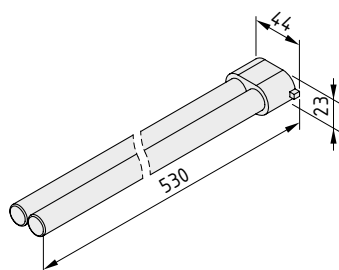

Compact Lamp 55W



Twin tube
 Tube diameter: 17 mm
 Power: 55 Watt
 Light colour: natural white, 4800 lm
 m = 150.0 g

1 pce. 0.0.417.57

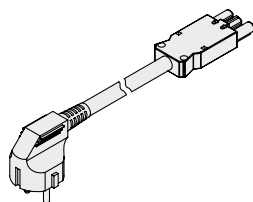

Connecting Cable, Socket / Earthed Plug



Cable length 3 m (1.5 mm²)
 m = 370.0 g

black, 1 pce. 0.0.417.42

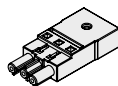

Socket, Spring-Force Connected



PA
 m = 25.0 g

black, 1 pce. 0.0.417.44



Adapter, Socket / Plug



PA
 incl. dowel
 m = 13.0 g

black, 1 set 0.0.417.45

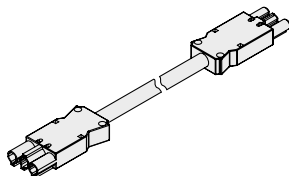

Extension Cable, Socket / Plug



Cable length 2 m (1.5 mm²)
 m = 234.0 g

black, 1 pce. 0.0.417.52

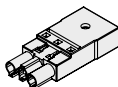

Plug, Spring-Force Connected



PA
 m = 25.0 g

black, 1 pce. 0.0.417.59

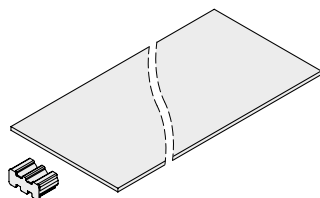

Polycarbonate Protective Panel



PC, transparent
 incl. socket sealing cap
 m = 195.0 g

1 set 0.0.417.43



Lamp 35W

- For targeted precision lighting
- Water and dust-resistant housing (IP67)



Dust-tight and water-tight industrial spotlight (IP 67) in a low-voltage (12 V) design.

The aluminium housing for the Light Fitting is equipped for fastening with Profile 8 grooves. A Hinge, heavy duty or other fastening elements can be used to integrate the Lamp 35W into machines, fixtures and equipment.

Lamp 35W comes with a 2 m connecting cable, which is linked to the electronic transformer using a coded system plug. Up to 3 Lamps can be attached to this power pack via the distributor block.

The voltage supply to the electronic transformer is provided via the Connecting Cable, Socket / Earthed Plug (0.0.417.42) to a 230 V safety contact socket.

The housing of Lamp 35W can be fitted with Handle PA 80.



Fixed Lamp 35W, adjustable with Hinge 8 40x40, heavy-duty with Clamp Lever.

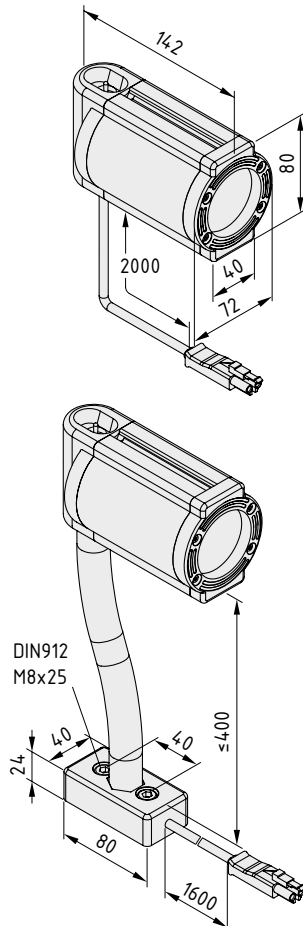

Lamp 35W



- ON/OFF switch
- Halogen reflector 35W
- Protective panel of hardened glass
- Protection: IP 67, EN 60529
- Protection class III
- 2 m connecting cable
- Notes on Use and Installation
- m = 0.6 kg

1 set 0.0.417.60

Lamp 35W with Flexible Tube



- ON/OFF switch
- Halogen reflector 35W
- Protective panel of hardened glass
- Protection: IP 67, EN 60529
- Protection class III
- m = 1.2 kg

1 set 0.0.417.71

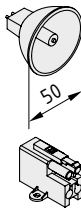

Lamp 35W, Halogen Reflector	
m = 25.0 g	
1 pce.	0.0.417.77

Lamp 35W, 3-Way Distributor Block	
m = 20.0 g	
1 pce.	0.0.417.74

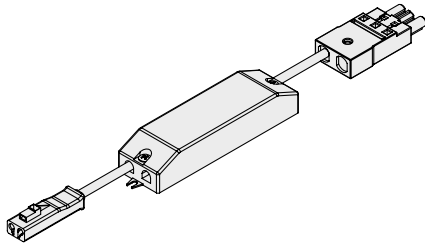

Electronic Transformer 105W	
Primary voltage: 230/240 V AC	
Secondary voltage: 12 V AC	
m = 167.0 g	
1 pce.	0.0.417.75



LED Machine Light Fitting

- Compact working light for use anywhere
- LED light fitting generates very little heat
- Water and dust-resistant housing (IP67)

The item LED Machine Light Fitting – putting your processes in the right light. Practical, dust- and water-tight Machine Light Fitting in aluminium housing with 5 W output for blanket illumination of the workplace or direct lighting of a specific area. Operating voltage is 24 V DC, protection IP67. The LED Machine Light Fitting is switched on and off via external switches on the power supply.

13

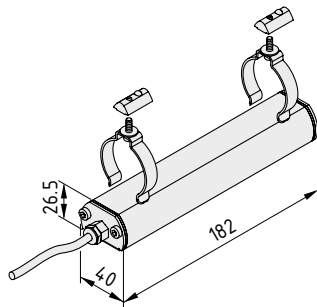

LED Machine Light Fitting	
Aluminium housing IP67	
2 fastening clamps with screws and T-Slot Nuts 8 St	
Fastening elements	
Rated voltage: 24 V DC	
Protection class III	
Output: 5 W	
Power cable, black, L = 3 m	
m = 0.4 kg	
1 pce.	0.0.631.73

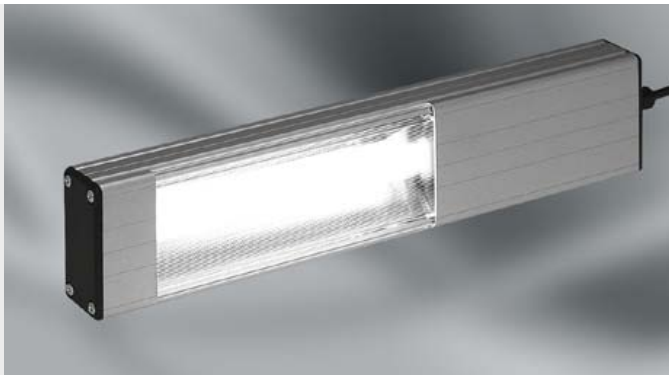

Light Fitting 11W

- Energy-saving long-term lighting
- Runs on safety low voltage
- Flicker-free light thanks to Lamp-Control Unit

Compact industrial light for use with safety low voltage supply. Each segment (360 mm long) of the Light Fitting is equipped with an electronic Lamp-Control Unit for low voltage (24 V DC) and a Compact Lamp (power 11 W, corresponds to a conventional 75 W filament lamp).

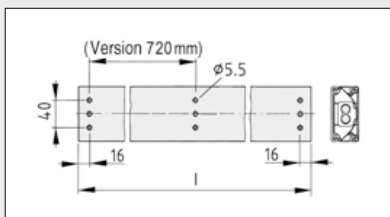

The rear of the housing is prepared for fastening with Button-Head Screws M5x14. Fully compatible with Conduit Profiles.

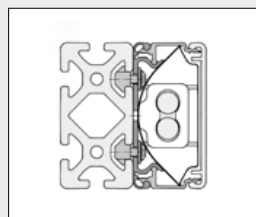

Fastening of Light Fitting 11W to any mounting surface or Profile 8 grooves.

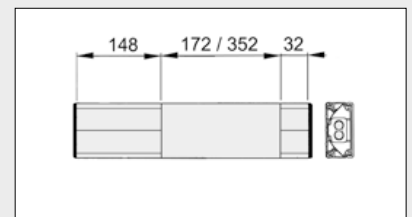
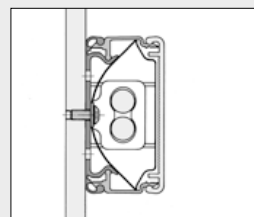

Length of transparent cover

Conduit Profiles E

432

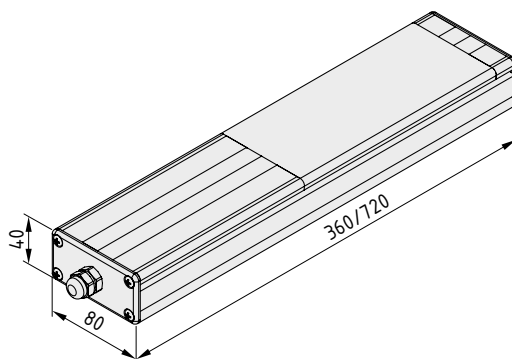

Light Fitting 11W 80x40x360



Aluminium housing
Transparent cover, PMMA
Caps, PA-GF, black
Lamp-Control Unit, Compact Lamp, reflectors, installation material, fastening screws M5x14
Rated voltage: 24 V DC
Protection: IP 50, EN 60529
Power output: 11 W
m = 0.7 kg

1 pce.

0.0.417.06

Light Fitting 11W 80x40x720



Aluminium housing
Transparent cover, PMMA
Caps, PA-GF, black
Lamp-Control Unit, Compact Lamp, reflectors, installation material, fastening screws M5x14
Rated voltage: 24 V DC
Protection: IP 50, EN 60529
Power output: 22 W
m = 1.4 kg

1 pce.

0.0.417.07

Compact Lamp 11W

Twin tube
Tube diameter: 12 mm
Power output: 11 W
m = 70.0 g

1 pce.

0.0.417.17

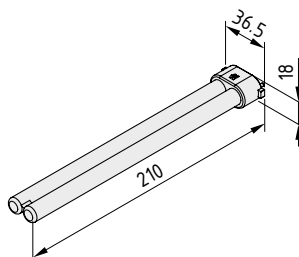



Multi-Socket Power Strips, 5 outlet

- Securely fixed to a profile groove
- Angled installation ensures easy access
- With practical central ON/OFF switch

Robust Multi-Socket Power Strip in industrial quality. An impact-proof aluminium housing accommodates 5 sockets (German domestic standard) and a 2-pole ON/OFF switch with indicator light.

Mains connection via a fixed conventional power cord or a system plug – can also be connected directly to the mains using Adapter, Socket/Plug (0.0.417.45, max. 16 A).

Can be fastened to profile grooves and all panels: fits flush with the fastening elements included. The Fastening Sets also enable you to fit the units at an angle of 90° or 70° (particularly ergonomic). These sets are then used instead of the fastening elements supplied with the Multi-Socket Power Strips.

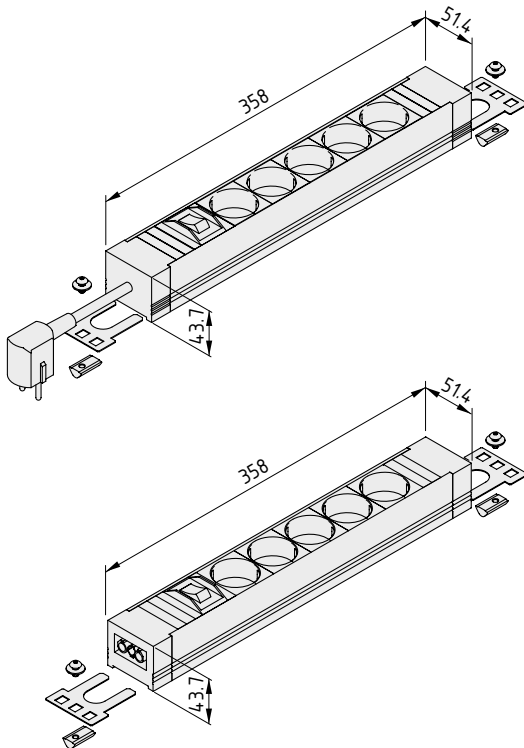
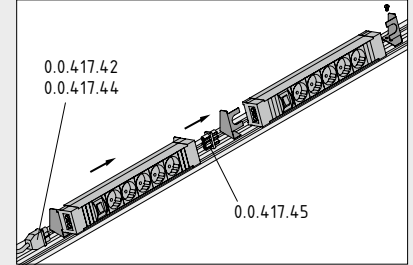

Multi-Socket Power Strip, 5 outlet, with conventional power cord

Housing, Al, anodized, natural
 5 power sockets (German domestic standard)
 ON/OFF switch, illuminated, 2-pole
 Feed cable 1.5 mm², l = 2 m
 2 fastening brackets
 2 T-Slot Nuts V 8 St M5, bright zinc-plated
 Fastening elements
 m = 670.0 g

1 set 0.0.627.43

Multi-Socket Power Strip, 5 outlet, with system plug

Housing, Al, anodized, natural
 5 power sockets (German domestic standard)
 ON/OFF switch, illuminated, 2-pole
 System plug
 System socket
 2 fastening brackets
 2 T-Slot Nuts V 8 St M5, bright zinc-plated
 Fastening elements
 m = 450.0 g

1 set 0.0.627.44

Multi-Socket Power Strip Angle Fastening Set

2 angle brackets 90°, St, bright zinc-plated
 m = 84.0 g

1 set 0.0.627.40

Multi-Socket Power Strip Angle Fastening Set 70°

2 angle brackets 70°, St, bright zinc-plated
 m = 65.0 g

1 set 0.0.627.42



Multi-Socket Power Strip, 8 outlet, 19" , with conventional power cord

- Robust and powerful
- Secure screw attachment to Rebate Profile 19"

The item Multi-Socket Power Strip, 8 outlet is the ideal extension for your power supply. Eight power sockets (German domestic standard) and a two-pole ON/OFF switch with indicator light – all in a plastic housing with fittings to accommodate Rebate Profile 19" .

The Multi-Socket Power Strip, 8-outlet, can also be placed in Cable Duct E of a work bench.

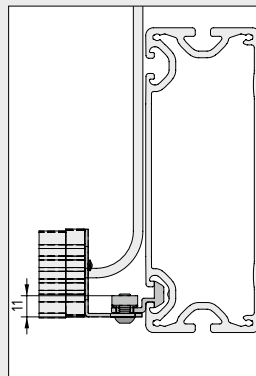
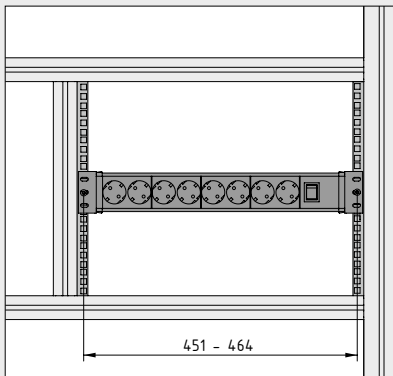

Rebate Profile 8 Al
19"  186

Because this robust, industrial quality Multi-Socket Power Strip can be fitted to the profile grooves of a machine frame or structure, positioning your power supply precisely where it is needed couldn't be simpler. Mains connection via a fixed conventional power cord that is included in the scope of supply.

Multi-Socket Power Strip 19" is fitted to a Profile 8 groove using Rebate Profile 19" .

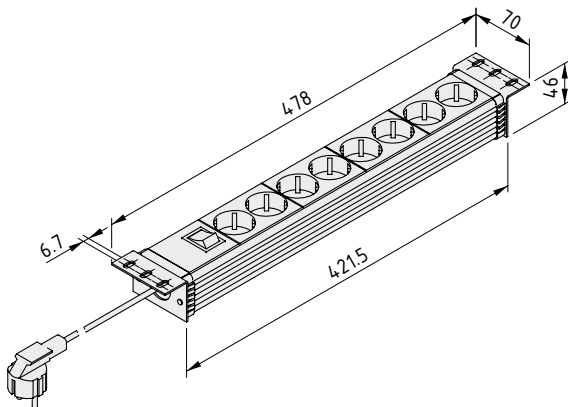

Multi-Socket Power Strip, 8 outlet, 19" , with conventional power cord

8 power sockets (German domestic standard)
Feed cable 1.5 mm², max. 16 A, l = 3 m
ON/OFF switch, illuminated
m = 870.0 g

1 pce.

0.0.631.79



Pneumatic Universal-Fastening Sets

- Cavities in Profiles 8 can be used as compressed-air conduits
- Connect profiles at right angles or via their end faces
- Large profile cavities are not adversely affected by bore holes

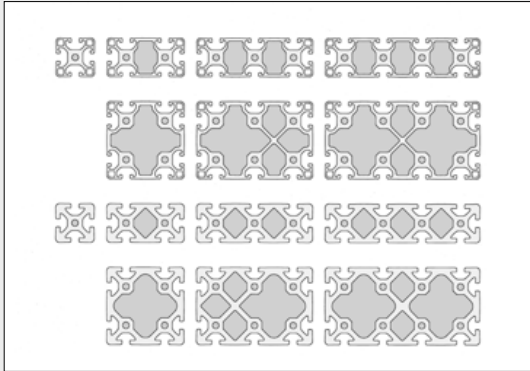

Appropriate fastening elements such as Pneumatic Universal Fasteners are needed in order to use the profile cavities as pneumatic lines. The Automatic-Fastening Set is also suitable for connecting profiles used as pneumatic lines.

Automatic-Fastening Set 8 N 85

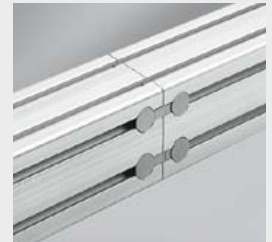
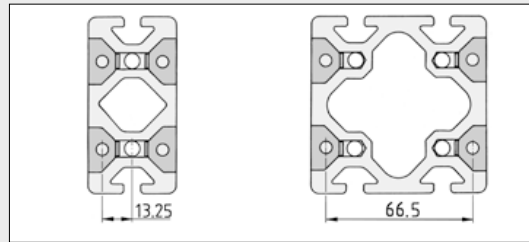
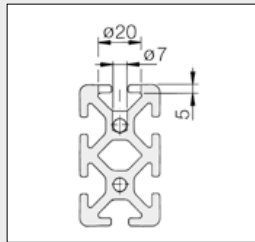
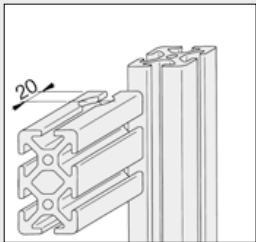

Depending on the profile size and load, several pairs of Fastening Sets may be required. When using the Pneumatic Universal-Fastening Sets ensure that the pilot drill does not penetrate the main chamber.

Pneumatic Universal-Butt-Fastening Sets 8 are used to connect the end faces of two profiles, e.g. where profile segments need to be extended.

Alternatively, Automatic Butt-Fastening Sets 8 can also be used.

13

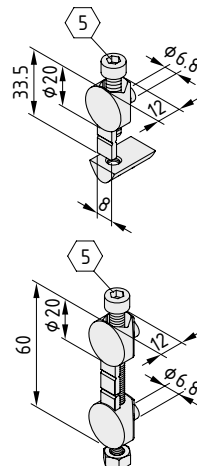

Pneumatic Universal-Fastening Set 8

Pneumatic Universal Fastener 8, die-cast zinc
Hexagon Socket Head Cap Screw DIN 912-M6x30, St
T-Slot Nut 8 St M6

$M_{\text{bright zinc-plated}} = 14 \text{ Nm}$ $m = 34.0 \text{ g}$

bright zinc-plated, 1 set

0.0.364.45

Pneumatic Universal-Butt-Fastening Set 8

2 Pneumatic Universal Fasteners 8, die-cast zinc
Hexagon Socket Head Cap Screw DIN 912-M6x50, St
Hexagon Nut DIN 934-M6, St

$M_{\text{bright zinc-plated}} = 14 \text{ Nm}$ $m = 45.0 \text{ g}$

bright zinc-plated, 1 set

0.0.364.46



Seals PE

- Enables use of Profiles 8 as compressed-air conduits
- Sealing for profile connections
- Compensate for unevenness at the end face
- Self-adhesive for ease of installation



Seals PE must be located at every connection point between components functioning as pneumatic lines. The settlement of the Seal PE material can result in an initial reduction in the screw pretension. The screws must therefore be tightened after 24 hours. Self-adhesive versions facilitate assembly and eliminate pronounced unevenness (saw cuts, butt joints etc.).

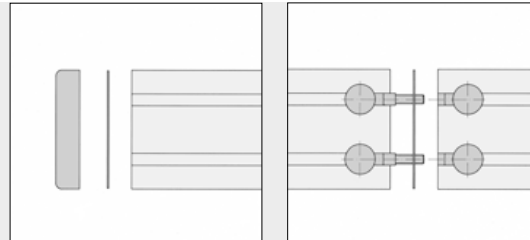

Seals PE must be used between all joints.

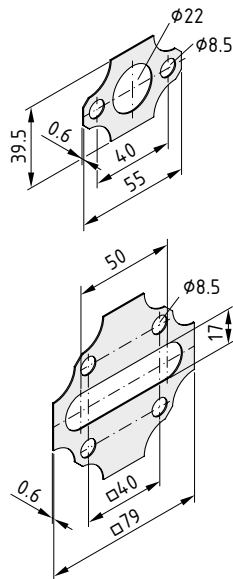

Seal 8 80x40 PE



PE-LD
self-adhesive on one side
m = 1.0 g
natural, 1 pce.

0.0.420.80

Seal 8 80x80 PE



PE-LD
self-adhesive on one side
m = 2.0 g
natural, 1 pce.

0.0.420.79



Pneumatic Connecting Plates

- For connecting supply lines and consumers
- Fitted to the end face of the profile



Pneumatic Connecting Plates are employed for connecting compressed-air supply systems or compressed-air consumers to Profiles 8 80x40 and 80x80. The Connecting Plate is attached by means of Button-Head Screws ISO 7380-M8x20 (M = 25 Nm) fitted into the core bores in the end faces of the profile.

Pneumatic Universal-Fastening Sets are employed for connecting profiles used as compressed-air conduits.

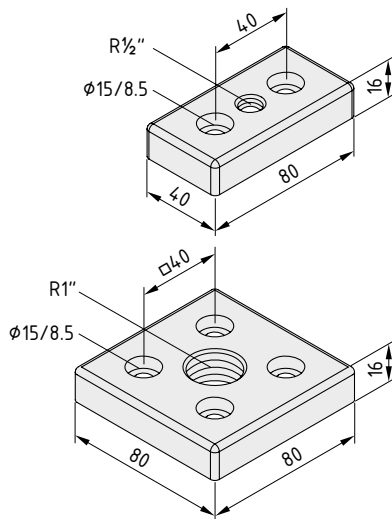

Pneumatic Connecting Plate 8 80x40 R $\frac{1}{2}$ "



Die-cast zinc
m = 230.0 g

black, 1 pce.

0.0.406.34

Pneumatic Connecting Plate 8 80x80 R1"



Die-cast zinc
m = 390.0 g

black, 1 pce.

0.0.406.25



Pneumatic Connections

- For connecting compressed-air conduits to profile bores
- Can be fitted to the desired point on the profile
- For pneumatic connections G1/8 and G1/4.

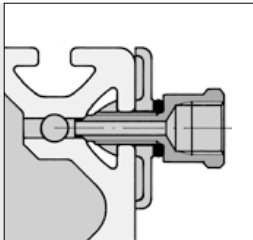

Supply of compressed air to the profile cavity by means of a central bore in the T-slot in conjunction with a Pneumatic Connecting Set. The seal is provided at the taper seat of the Pneumatic Connector.

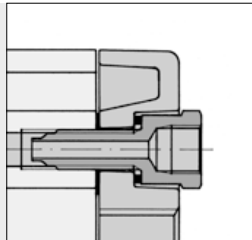

Supply of compressed air to a central bore by means of a Pneumatic Connecting Plate with Pneumatic Connection fitted to the end face.

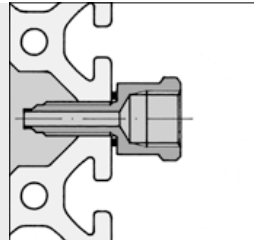

Depending on the type of application, the profile may need to be machined. When using a Pneumatic Connector outside the core bores, a standard O-ring seal must be used.

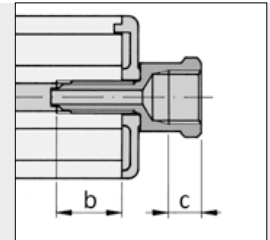
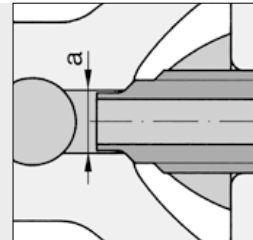

Pneumatic-Connector	a	b	c
8 G1/8	∅ 4.9 mm	M8x16	6 mm
8 G1/4	∅ 4.9 mm	M8x16	8 mm

When using the Pneumatic Connector (with inner thread c) in conjunction with the core bore, an appropriate thread of length (b) or, in the case of connections made at 90°, bores of diameter (a) must be provided, and a T-Slot Nut St to retain the fitting.

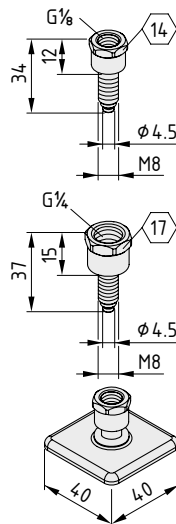

Pneumatic Connector 8 G1/8



St
M = 12 Nm m = 15.0 g
black, 1 pce.

0.0.411.69

Pneumatic Connector 8 G1/4



St
M = 12 Nm m = 18.0 g
black, 1 pce.

0.0.411.68

Pneumatic Connecting Set 8 G1/8



St
Pneumatic Connector, St
Cap, PA-GF
Seal, NBR
m = 19.0 g

black, 1 set

0.0.411.73

Pneumatic Connecting Set 8 G1/4



St
Pneumatic Connector, St
Cap, PA-GF
Seal, NBR
m = 24.0 g

black, 1 set

0.0.411.72



Compressed Air Manifold

- Easy to fasten to a profile groove
- With three quick-release couplings

Compressed air connections precisely where you need them – with the Compressed Air Manifold from item. Fit the Compressed Air Manifold to work bench profiles and use the three quick-release couplings for your compressed air devices (operating pressure $P_{perm.} = 8 \text{ bar}$). Nominal diameter of couplings: 7.2 mm, thread G 3/8. Connection for the compressed air feed line: G 1/2.

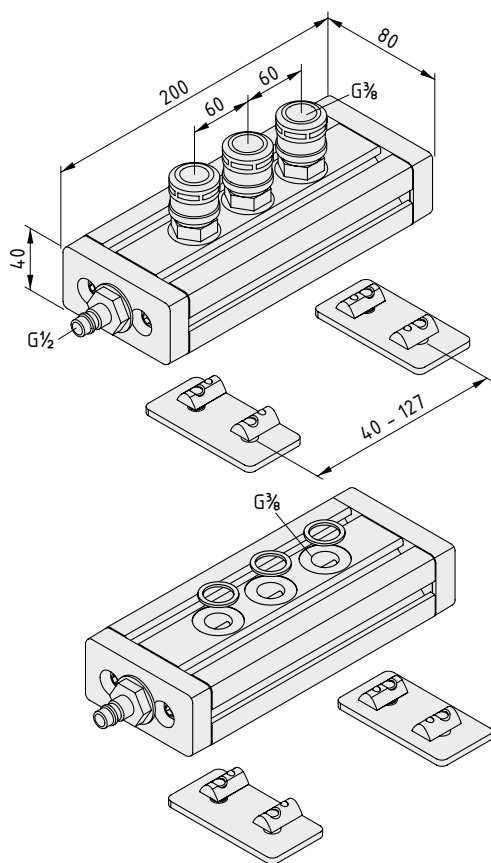

Compressed Air Manifold

Compressed Air Manifold, Al, natural
 3 quick-release couplings G 3/8, St - ND 7.2 mm
 Male connector G 1/2, St - ND 7.2 mm
 2 Flat Brackets 8 40, St, black
 4 Fastening Sets, St, bright zinc-plated
 m = 1.8 kg

1 set	0.0.635.98
-------	------------

Compressed Air Manifold Without Quick-Action Couplings

Compressed Air Manifold, Al, natural
 3 seals G 3/8, Al
 Male connector G 1/2, St - ND 7.2 mm
 2 Flat Brackets 8 40, St, black
 4 Fastening Sets, St, bright zinc-plated
 m = 1.6 kg

1 pce.	0.0.645.40
--------	------------



Protective Profiles

Prevent damage and injuries

- Safe impact protection thanks to hollow-chambered profiles
- Protects edges and hidden struts



The elastic hollow-chambered plastic profiles are pushed into the grooves of Line 8 profile. Protective Profiles provide impact protection for the sides of profiles and cover profile edges. Elastic Caps cover the end faces of the Protective Profiles.

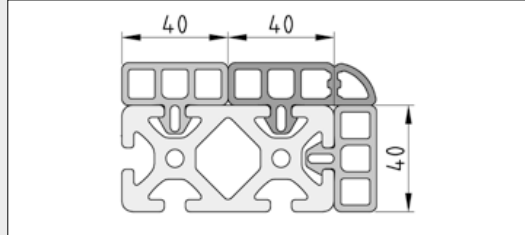

The Protective Profiles have a modular dimension of 40 mm. Large cross-sections of Line 8 Profiles can be protected effectively by combining several Protective Profiles.

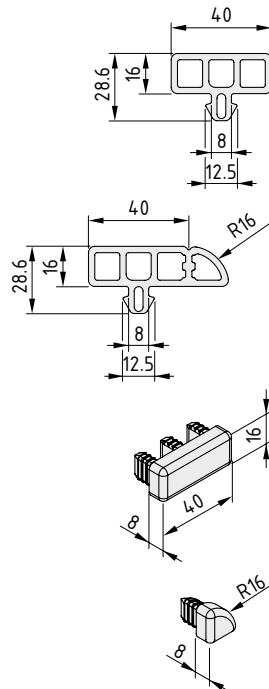

Protective Profile 8 40x16



TPE
m = 334 g/m
black, 1 pce., length 2000 mm

0.0.474.72

Protective Profile 8 40x16 R16



TPE
m = 435 g/m
black, 1 pce., length 2000 mm

0.0.474.71

Cap for Protective Profile 8 40x16



m = 6.0 g
black, 1 pce.

0.0.474.74

Cap for Protective Profile 8 R16-90°



m = 2.0 g
black, 1 pce.

0.0.474.73



Buffer Strip

- For gentle closing of doors
- Also suitable as a door seal



Flexible plastic strip with fastening geometry for Profiles 8 and Clamp Profile 8 32x18. The strip can be used as a stop for swing, sliding and lifting doors, as a sealing profile or for similar applications.

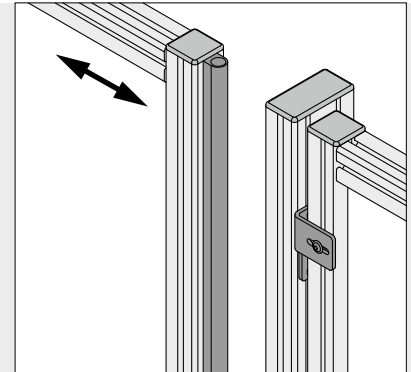
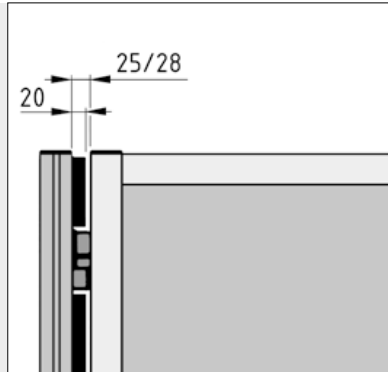

In enclosure and guard applications using Hanger 8/Door Rabbet 8 (gap width 25/28 mm), Buffer Strip 8 20x18 can be used to reduce the gap width.

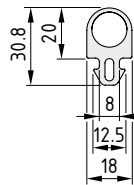

Buffer Strip 8 20x18



TPE
 Hardness 73 Sh A
 Oil, UV and water resisting
 m = 240 g/m

black, 1 pce., length 2000 mm

0.0.458.01

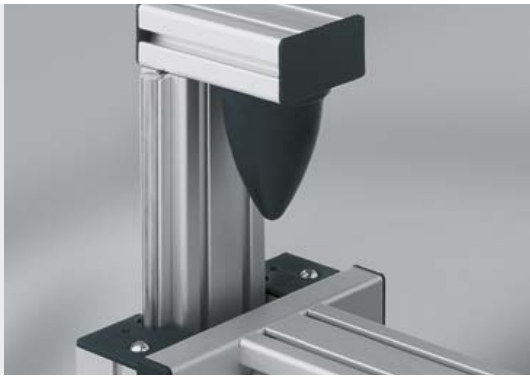

Impact Buffers Parabolic Buffers

- Rubber/metal elements deaden impacts effectively
- Resistant to oil, grease, salt water and soap suds
- Also suitable for use as damping feet

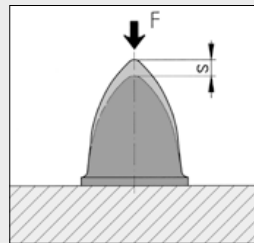
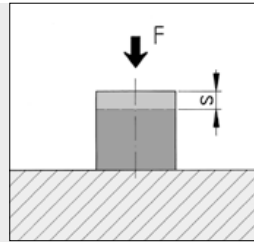

	max. F	s
Impact Buffer M4	90 N	1.4 mm
Impact Buffer M6	150 N	2.7 mm
Impact Buffer M8	350 N	3.0 mm

	max. F	s
Parabolic Buffer M8	370 N	20.0 mm
Parabolic Buffer M10	1057 N	35.0 mm
Parabolic Buffer M12	2360 N	50.0 mm

Parabolic Buffer with approximately exponential force profile.

Materials used in all the following products:

NBR
Hardness 55 Sh A
Steel insert, St

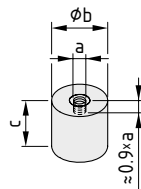

Impact Buffer M4 D15x15

a = M4 b = 15 mm c = 15 mm m = 5.0 g

black, 1 pce. 0.0.416.33

Impact Buffer M6 D20x15

a = M6 b = 20 mm c = 15 mm m = 12.0 g

black, 1 pce. 0.0.416.35

Impact Buffer M8 D30x30

a = M8 b = 30 mm c = 30 mm m = 38.0 g

black, 1 pce. 0.0.416.37

Parabolic Buffer M8 D30x36

a = M8 b = 30 mm c = 36 mm m = 26.0 g

black, 1 pce. 0.0.416.39

Parabolic Buffer M10 D50x58

a = M10 b = 50 mm c = 58 mm m = 103.0 g

black, 1 pce. 0.0.416.41

Parabolic Buffer M12 D75x89

a = M12 b = 75 mm c = 89 mm m = 319.0 g

black, 1 pce. 0.0.416.43

