



7

## HINGES AND FITTINGS

7

- Hinges
- Door Rabbets and Seals
- Sliding-Door Guide Sets
- T-Slot Sliders/T-Slot Rollers
- Slide Guides
- Castors
- Roller Shutter System

Hinges and fittings  
Products in this section



**Hinges PA**

- Made from durable plastic
- For lightweight doors and lids

📄 225



**Hinges Al light**

- Made from aluminium, also suitable for heavyweight doors
- Can be installed to produce a very small door gap

📄 228



**Hinge Leaf Profiles**

- For assembling Hinges Al light in any size
- Suitable for continuous hinge strips

📄 231



**Modular Hinge System 8**

- For particularly strong doors and lids
- Carefully designed hinge leaves that can be combined as required

📄 233



**Hinges St**

- Slim and made from steel
- For doors and lids subjected to standard loads

📄 236



**Hinges Zn**

- Secure fixing for heavily loaded doors and lids
- Durable metal design

📄 237



**Door Rabbet 8**

- The secure stop for swing doors
- Safety thanks to robust design

📄 240



**Door Stop Seal**

- Elastic lip seal has cushioning effect
- Protects against dust and dampness

📄 241



**Sliding-Door Guide Set 8**

- Easy-running sliders on the panel element
- Guidance along the profile groove

📄 242



**Sliding-Door Guide Profile**

- For retrofitting sliding doors to profile constructions
- For frameless panel elements made from plastic

📄 244



**T-Slot Slider**

- Glides in the groove and enables free rotation
- Guide for folding, lifting and sliding doors

📄 246



**Slide Guide Strip**

- For the Slide Guides of doors and fixtures
- Plastic strips for guidance in the profile groove

📄 248



**T-Slot Slider**

- Strong metal slide
- Plastic inserts for low-wear and low-friction movement

📄 250



**Runway Profiles**

- System solutions comprising Castor Units and Runway Profiles
- For use with high-load-carrying customised slides

📄 254



**Roller Shutter System**

- Space-saving protection provided by a flexible door as a turnkey solution
- Aluminium or plastic roller shutters

📄 258



## Hinges PA

- Made from durable plastic
- For lightweight doors and lids
- Products from Line X also available



7

Hinges PA have an anti-torsion feature that engages with the profile grooves. Before the Hinges can be fastened to a panel element, through-holes need to be drilled into the panel.

The shape and colour of Hinges X 8 PA match Profiles X 8.

Double Hinges PA can only be used on 20 mm wide profiles in Line 5, on 30 mm wide profiles in Line 6 and on 40 mm wide profiles in Line 8.

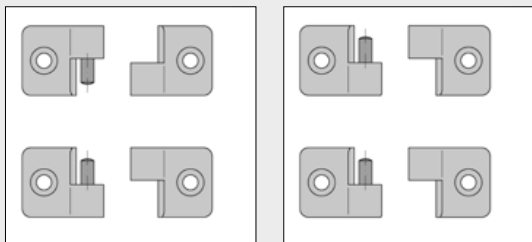
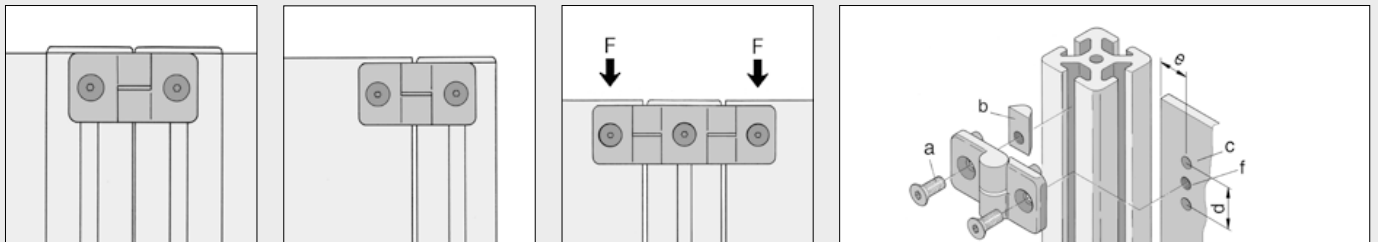

Line 6, 8 and 10 door elements can be attached either permanently or in such a way that they can be lifted off subsequently. For the lift-off version, the doors must be equipped only with right-hand or left-hand Hinges. For the permanently fixed version, right-hand and left-hand Hinges must be combined.

	Hinge / Double Hinge				
				X 8	
a	Screw DIN 7991	M5x8	M5x14	M6x16	M6x20
b	T-Slot Nut	5 St M5	6 St M5	8 St M6	V8 St M6
c [mm]		∅ 5	∅ 6.3	∅ 8.2	∅ 8.2
d [mm]		15	22	23.8	24
e [mm]		9	14	18	18
f		M5	M5	M6	M6
F [N]		50	75	100	100

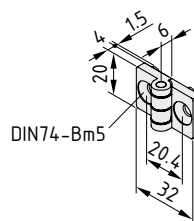

### Hinge 5 PA

PA-GF  
cannot be lifted out  
m = 6.0 g

black, 1 pce.	0.0.370.18
grey similar to RAL 7042, 1 pce.	0.0.641.54

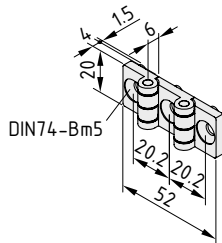

<b>Double Hinge 5 PA</b>	<b>5</b>
PA-GF cannot be lifted out m = 10.0 g	
black, 1 pce.	0.0.437.33

<b>Fastening Set 5 for Bracket / Angle Bracket 5 20 / profile side for Hinge 5 PA</b>	<b>5</b>
Countersunk Screw DIN 7991-M5x8, St, black T-Slot Nut 5 St M5, bright zinc-plated m = 2.5 g	
1 set	0.0.370.70

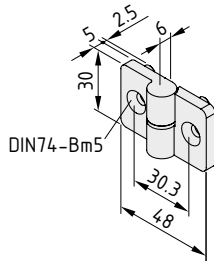

<b>Hinge 6 PA, right</b>	<b>6</b>
Hinge halves, PA-GF Pin, St, bright zinc-plated Washer, PA m = 14.0 g	
black, 1 pce.	0.0.431.23
grey similar to RAL 7042, 1 pce.	0.0.641.53

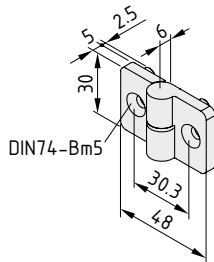

<b>Hinge 6 PA, left</b>	<b>6</b>
Hinge halves, PA-GF Pin, St, bright zinc-plated Washer, PA m = 14.0 g	
black, 1 pce.	0.0.431.25
grey similar to RAL 7042, 1 pce.	0.0.641.52

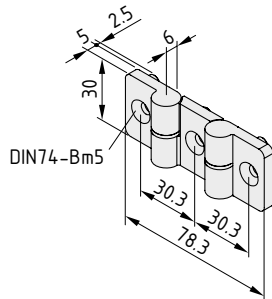

<b>Double Hinge 6 PA</b>	<b>6</b>
Hinge halves, PA-GF Pin, St, bright zinc-plated Washer, PA m = 25.0 g	
black, 1 pce.	0.0.431.27

<b>Fastening Set 6 profile side for Hinge 6 PA</b>	<b>6</b>
T-Slot Nut 6 St M5, bright zinc-plated Countersunk Screw DIN 7991-M5x14, St, black m = 7.0 g	
1 set	0.0.434.65

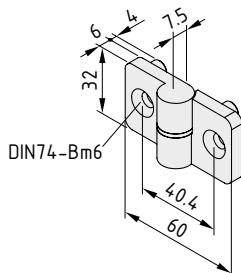

<b>Hinge 8 PA, right</b>	<b>8</b>
Hinge halves, PA-GF Pin, St, bright zinc-plated Washer, PA m = 21.0 g	
black, 1 pce.	0.0.026.12
grey similar to RAL 7042, 1 pce.	0.0.630.89

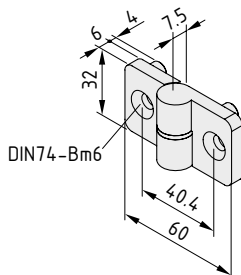

<b>Hinge 8 PA, left</b>	<b>8</b>
Hinge halves, PA-GF Pin, St, bright zinc-plated Washer, PA m = 21.0 g	
black, 1 pce.	0.0.026.10
grey similar to RAL 7042, 1 pce.	0.0.630.45

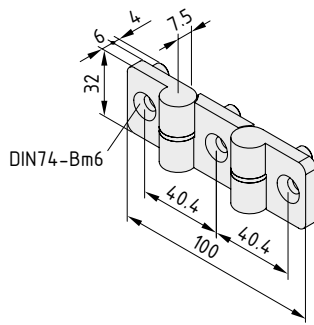

**Double Hinge 8 PA**



Hinge halves, PA-GF  
Pin, St, bright zinc-plated  
Washer, PA  
m = 40.0 g

black, 1 pce.

0.0.373.42

**Fastening Set 8 profile side for Hinge 8 PA**



T-Slot Nut 8 St M6, bright zinc-plated  
Countersunk Screw DIN 7991-M6x16, St, black  
m = 14.0 g

1 set

0.0.026.28

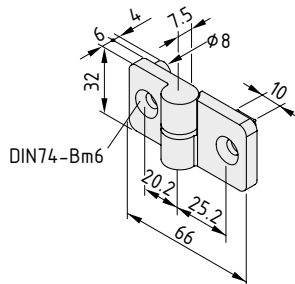

**Hinge 10 PA 10/8, right**



Hinge halves, PA-GF  
Pin, St, bright zinc-plated  
Washer, PA  
m = 34.0 g

grey similar to RAL 7042, 1 pce.

0.0.641.96

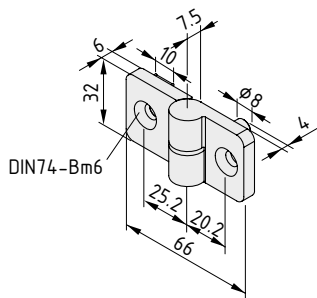

**Hinge 10 PA 10/8, left**



Hinge halves, PA-GF  
Pin, St, bright zinc-plated  
Washer, PA  
m = 34.0 g

grey similar to RAL 7042, 1 pce.

0.0.641.94

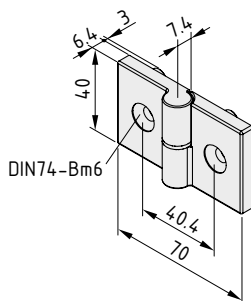

**Hinge X 8 PA, right**



2 Hinge Leaves, PA  
Washer, St, bright zinc-plated  
Grooved pin, St, bright zinc-plated  
m = 28.0 g

grey similar to RAL 7042, 1 pce.

0.0.601.52

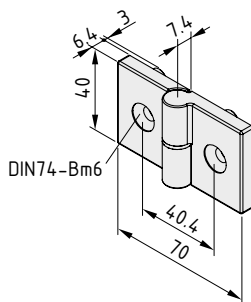

**Hinge X 8 PA, left**



2 Hinge Leaves, PA  
Washer, St, bright zinc-plated  
Grooved pin, St, bright zinc-plated  
m = 28.0 g

grey similar to RAL 7042, 1 pce.

0.0.601.97

7



## Hinges AI

**Strong, adjustable and elegant**

- Made from aluminium, also suitable for heavyweight doors
- Can be installed to produce a very small door gap
- Versions with a 270° opening angle are available

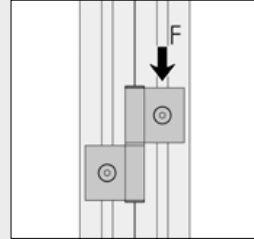

F = 500 N

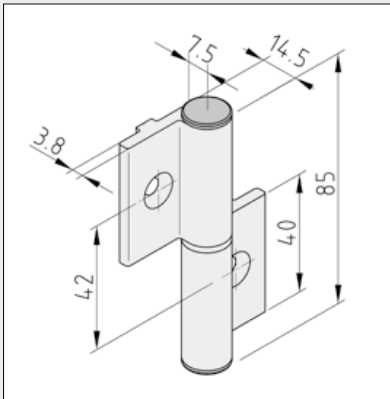
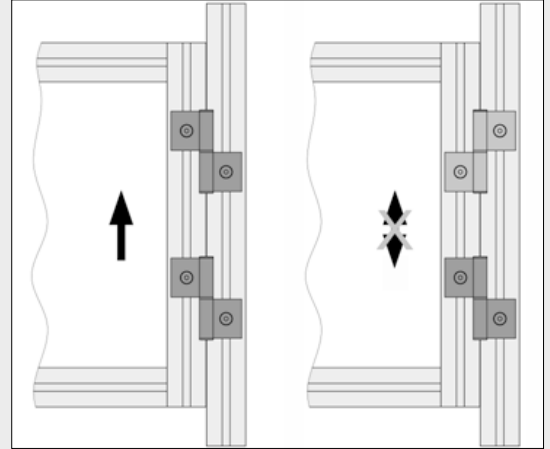

Irrespective of line or version, all Hinges AI light duty, have the connection dimensions shown here.

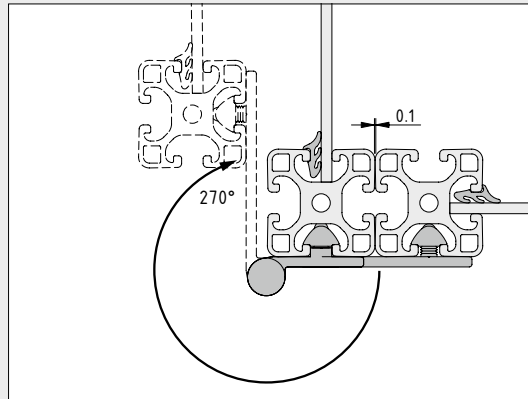

Hinges AI FP0-270° feature hinge leaves in different lengths. This enables an opening angle of 270°. The surface-mounted hinges secure both frameless panels and profile frames containing panel elements. Thanks to precision guidance that prevents the door leaf from sinking down, doors can be easily installed with virtually no gap between door and frame.



Hinges AI light duty are supplied in sets with screws and T-Slot Nuts for securing to profiles of the relevant line.

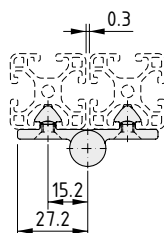

### Hinge 6 AI PP0, light duty



Hinge Leaf, Al, anodized, natural  
 2 T-Slot Nuts 6 St M5, bright zinc-plated  
 2 Countersunk Screws DIN 7991-M5x12, bright zinc-plated  
 Hinge AI light, Pin Set D6  
 Notes on Use and Installation  
 m = 84.0 g

1 set

0.0.488.98

**Hinge 6 Al FP0, light duty**

6

Hinge Leaf, Al, anodized, natural  
 T-Slot Nut 6 St M5, bright zinc-plated  
 Countersunk Screw DIN 7991-M5x12, bright zinc-plated  
 Hinge Al light, Pin Set D6  
 Notes on Use and Installation  
 m = 78.0 g

1 set

0.0.489.01

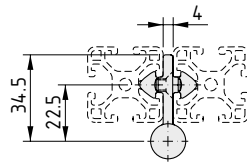
**Hinge 6 Al PP4, light duty**

6

Hinge Leaf, Al, anodized, natural  
 2 T-Slot Nuts 6 St M5, bright zinc-plated  
 2 Countersunk Screws DIN 7991-M5x12, bright zinc-plated  
 Hinge Al light, Pin Set D6  
 Notes on Use and Installation  
 m = 86.0 g

1 set

0.0.489.03

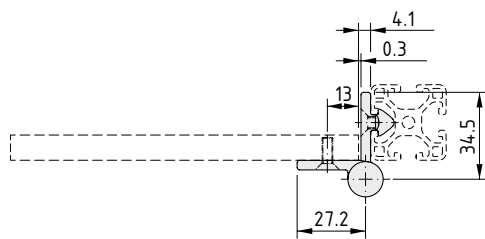
**Hinge 6 Al FP4, light duty**

6

Hinge Leaf, Al, anodized, natural  
 T-Slot Nut 6 St M5, bright zinc-plated  
 Countersunk Screw DIN 7991-M5x12, bright zinc-plated  
 Hinge Al light, Pin Set D6  
 Notes on Use and Installation  
 m = 79.0 g

1 set

0.0.489.05

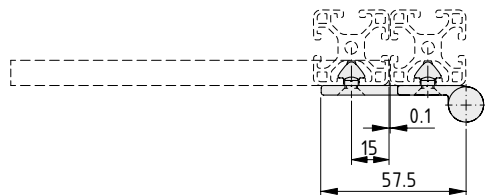
**Hinge 6 Al FP0-270° light**

6

Hinge Leaf, Al, anodized, natural  
 2 T-Slot Nuts 6 St M5, bright zinc-plated  
 2 Countersunk Screws DIN 7991-M5x12, St, bright zinc-plated  
 Hinge Al light, Pin Set D6  
 Notes on Use and Installation  
 m = 101.0 g

1 set

0.0.615.43

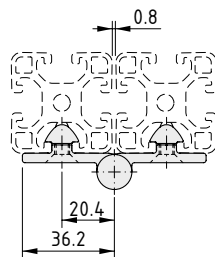
**Hinge 8 Al PP0, light duty**

8

Hinge Leaf, Al, anodized, natural  
 2 T-Slot Nuts V 8 St M6, bright zinc-plated  
 2 Countersunk Screws DIN 7991-M6x14, bright zinc-plated  
 Hinge Al light, Pin Set D6  
 Notes on Use and Installation  
 m = 110.0 g

1 set

0.0.488.90

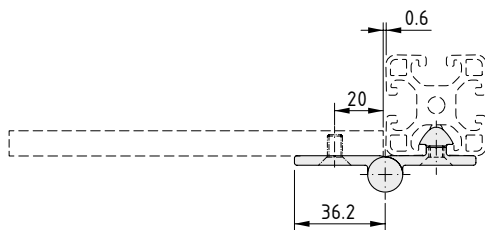
**Hinge 8 Al FP0, light duty**

8

Hinge Leaf, Al, anodized, natural  
 T-Slot Nut V 8 St M6, bright zinc-plated  
 Countersunk Screw DIN 7991-M6x14, bright zinc-plated  
 Hinge Al light, Pin Set D6  
 Notes on Use and Installation  
 m = 94.0 g

1 set

0.0.488.92

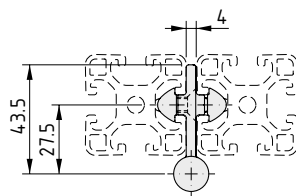
**Hinge 8 Al PP4, light duty**

8

Hinge Leaf, Al, anodized, natural  
 2 T-Slot Nuts V 8 St M6, bright zinc-plated  
 2 Countersunk Screws DIN 7991-M6x14, bright zinc-plated  
 Hinge Al light, Pin Set D6  
 Notes on Use and Installation  
 m = 113.0 g

1 set

0.0.488.94

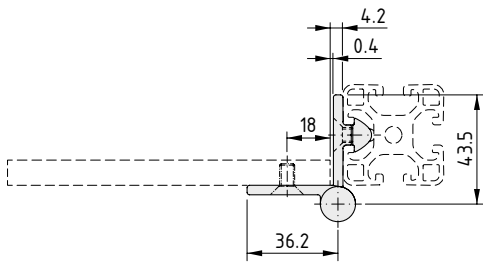

**Hinge 8 AI FP4, light duty**



Hinge Leaf, Al, anodized, natural  
 T-Slot Nut V 8 St M6, bright zinc-plated  
 Countersunk Screw DIN 7991-M6x14, bright zinc-plated  
 Hinge Al light, Pin Set D6  
 Notes on Use and Installation  
 m = 96.0 g

1 set 0.0.488.96

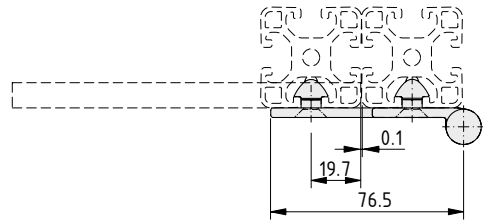

**Hinge 8 AI FP0-270° light**



Hinge Leaf, Al, anodized, natural  
 2 T-Slot Nuts V 8 St M6, bright zinc-plated  
 2 Countersunk Screws DIN 7991-M6x14, St, bright zinc-plated  
 Hinge Al light, Pin Set D6  
 Notes on Use and Installation  
 m = 128.0 g

1 set 0.0.615.45

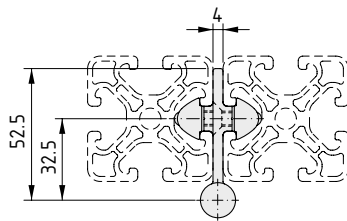

**Hinge 10 AI PP4 light**



Hinge leaves, Al, anodized, natural  
 2 T-Slot Nuts 10 St M6, bright zinc-plated  
 2 Countersunk Screws DIN 7991-M6x18, St, bright zinc-plated  
 Hinge Al light, Pin Set D6  
 Notes on Use and Installation  
 m = 144.0 g

1 set 0.0.632.86

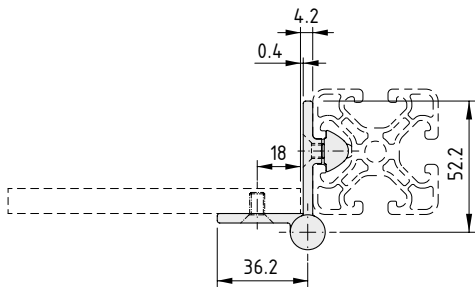

**Hinge 10 AI FP4 light**



Hinge leaves, Al, anodized, natural  
 T-Slot Nut 10 St M6, bright zinc-plated  
 Countersunk Screw DIN 7991-M6x18, St, bright zinc-plated  
 Hinge Al light, Pin Set D6  
 Notes on Use and Installation  
 m = 134.0 g

1 set 0.0.632.87

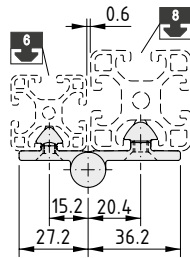

**Hinge 6/8 AI PP0, light duty**



Hinge Leaf, Al, anodized, natural  
 T-Slot Nut 6 St M5, bright zinc-plated  
 Countersunk Screw DIN 7991-M5x12, bright zinc-plated  
 T-Slot Nut V 8 St M6, bright zinc-plated  
 Countersunk Screw DIN 7991-M6x14, bright zinc-plated  
 Hinge Al light, Pin Set D6  
 Notes on Use and Installation  
 m = 98.0 g

1 set 0.0.489.07

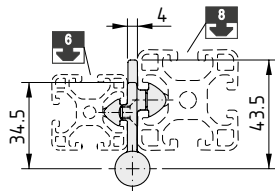

**Hinge 6/8 AI PP4, light duty**



Hinge Leaf, Al, anodized, natural  
 T-Slot Nut 6 St M5, bright zinc-plated  
 Countersunk Screw DIN 7991-M5x12, bright zinc-plated  
 T-Slot Nut V 8 St M6, bright zinc-plated  
 Countersunk Screw DIN 7991-M6x14, bright zinc-plated  
 Hinge Al light, Pin Set D6  
 Notes on Use and Installation  
 m = 101.0 g

1 set 0.0.489.09





## Hinge Leaf Profiles

- Individual hinge leaves in various designs
- Continuous hinge strips possible
- Suitable pins for customised hinges

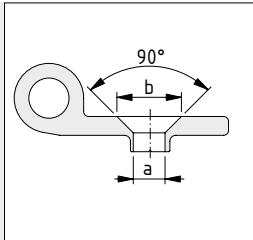

	a [mm]	b <sup>+0.2</sup> [mm]
	∅ 5.4	∅ 11
	∅ 6.4	∅ 13
	∅ 6.4	∅ 13



The Hinge Leaf Profiles must be provided with a countersink for screw fastening. The correct position of the hole is marked by a guide notch on the back of the hinge.

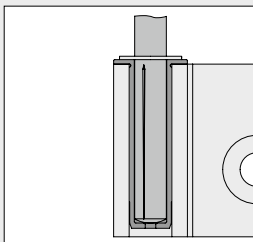

Pin Set D6 makes the fitting of all Hinges Al light child's play!

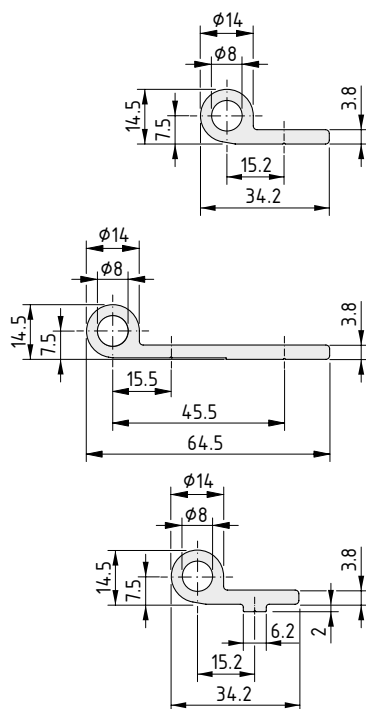

### Hinge Leaf Profile 6 e light

Al, anodized  
m = 0.54 kg/m

natural, cut-off max. 3000 mm	0.0.478.96
natural, 1 pce., length 3000 mm	0.0.451.80

### Hinge Leaf Profile 6 e 60 light

Al, anodized  
m = 0.83 kg/m

natural, cut-off max. 3000 mm	0.0.615.38
natural, 1 pce., length 3000 mm	0.0.615.37

### Hinge Leaf Profile V 6 e light

Al, anodized  
m = 0.57 kg/m

natural, cut-off max. 3000 mm	0.0.478.95
natural, 1 pce., length 3000 mm	0.0.451.78

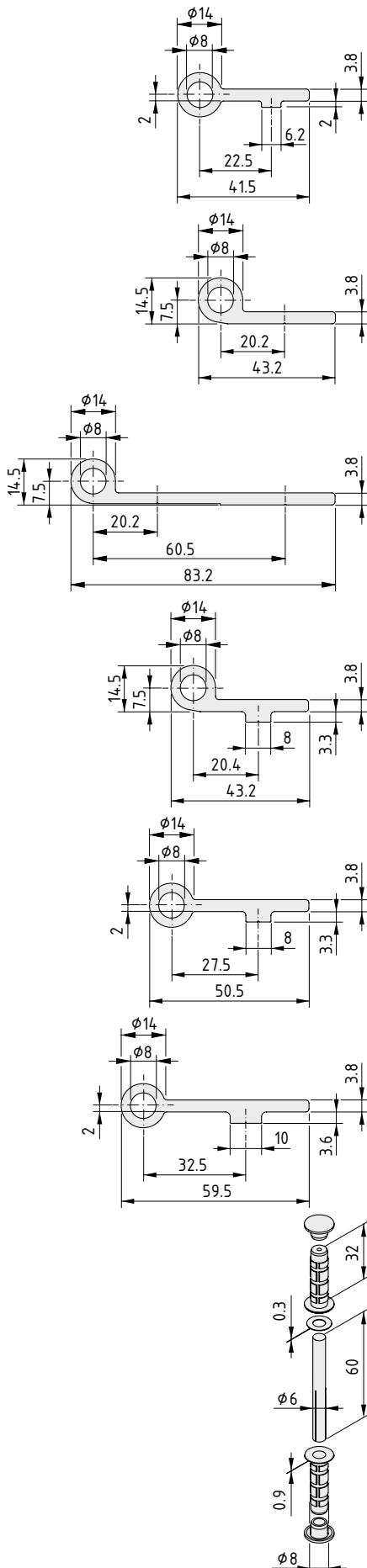

**Hinge Leaf Profile V 6 z light**



Al, anodized  
m = 0.60 kg/m

natural, cut-off max. 3000 mm	0.0.478.94
natural, 1 pce., length 3000 mm	0.0.451.76

**Hinge Leaf Profile 8 e light**



Al, anodized  
m = 0.64 kg/m

natural, cut-off max. 3000 mm	0.0.488.36
natural, 1 pce., length 3000 mm	0.0.454.58

**Hinge Leaf Profile 8 e 80 light**



Al, anodized  
m = 1.03 kg/m

natural, cut-off max. 3000 mm	0.0.615.40
natural, 1 pce., length 3000 mm	0.0.615.39

**Hinge Leaf Profile V 8 e light**



Al, anodized  
m = 0.71 kg/m

natural, cut-off max. 3000 mm	0.0.488.35
natural, 1 pce., length 3000 mm	0.0.454.56

**Hinge Leaf Profile V 8 z light**



Al, anodized  
m = 0.73 kg/m

natural, cut-off max. 3000 mm	0.0.488.34
natural, 1 pce., length 3000 mm	0.0.454.54

**Hinge Leaf Profile V 10 z**



Al, anodized  
m = 0.84 kg/m

natural, cut-off max. 3000 mm	0.0.632.92
natural, 1 pce., length 3000 mm	0.0.632.84

**Hinge Al light, Pin Set D6**



Grooved pin, St, bright zinc-plated  
2 bearing sleeves, PA, black  
Washer, St, stainless  
2 caps, PA, grey  
Notes on Use and Installation  
m = 25.0 g

1 set	0.0.621.16
-------	------------



## Modular Hinge System 8

- For particularly strong doors and lids
- Carefully designed hinge leaves that can be combined as required
- Suitable pins for hinge combinations



Modular Hinge System for high-strength aluminium hinges. Suitable for heavy doors, lids and swivel-type devices. Hinge Leaves of various heights and widths support heavy-duty hinges of virtually any length which the user can adapt to the specific situation. Hinges with an opening angle of up to 270° can be achieved using a suitable combination of sets.

A hinge consists of at least two Hinge Leaves and a suitable Hinge Pin. The Hinge Leaves and Pin are available in different lengths. When selecting these components, the minimum depth which the pin is inserted into the eye of the Hinge Leaf must always be taken into account.

Defined sets always contain all components necessary for a complete Hinge Leaf or Hinge Pin.

The use of slots and stepped locating lugs for screwing the Hinge Leaves facilitates the process of aligning the doors in the surrounding door frame. The locating lugs also serve as an anti-torsion device in the groove, thus preventing the hinges from becoming displaced under load.

Fastening is also possible to the end face of the profile. The slots are sealed with the enclosed Caps after installation has been completed, as are the drill holes of the hinge eyes.

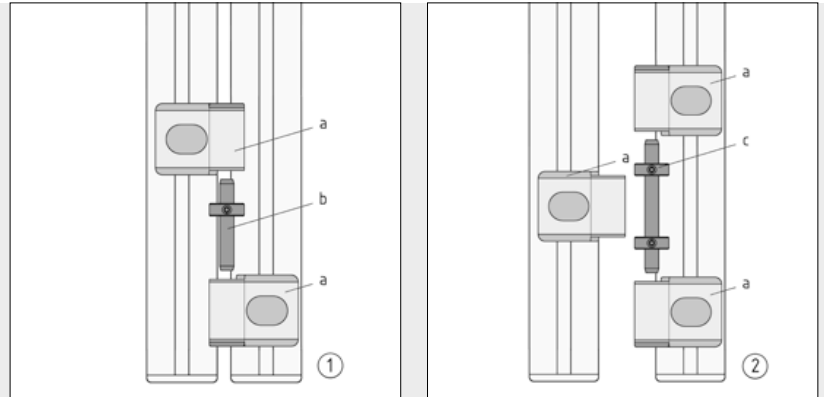

The required hinge can be assembled easily from the following sets:

- a = Hinge Leaf 8 40x40
- b = Hinge Pin D8x51
- c = Hinge Pin D8x76
- d = Hinge Leaf 8 80x40
- e = Hinge Leaf 80x80
- f = Hinge Pin D8x116

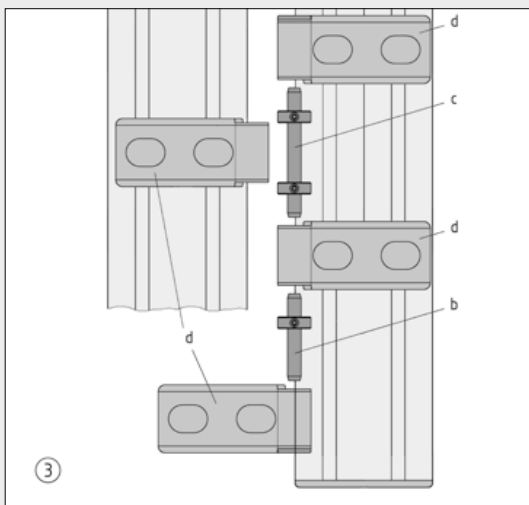

Various Hinge Leaves and Hinge Pins can be combined to construct hinge strips.

For example: Constructing a hinge strip with Hinge Leaves 8 80x40.

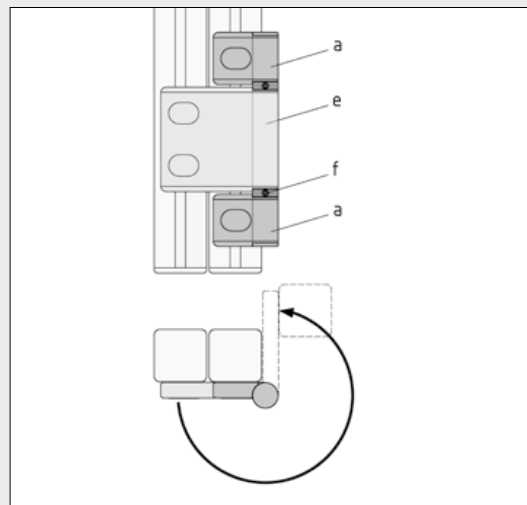

Example of a hinge opening around 270°.

The combination of Hinge Leaf 8 80x80 and two Hinge Leaves 8 40x40 (using a Hinge Pin D8x116) can be used to construct a hinge with a 270° angle of swing. This may be required, first and foremost, when constructing wide-opening doors in machine panelling.

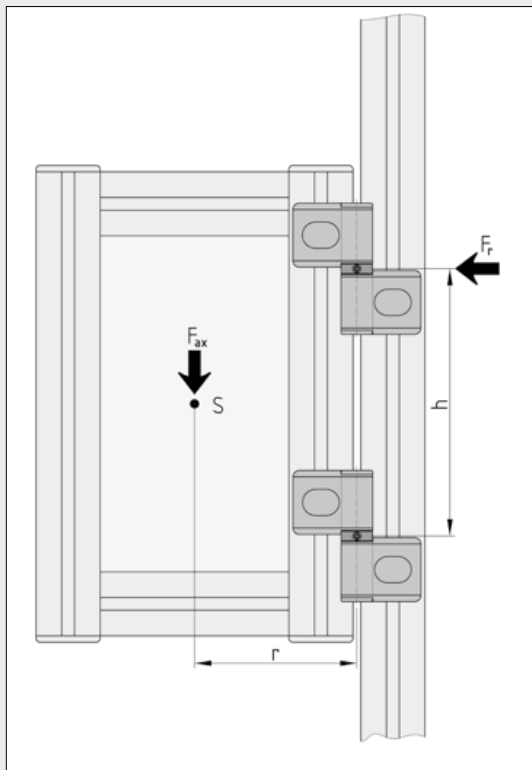
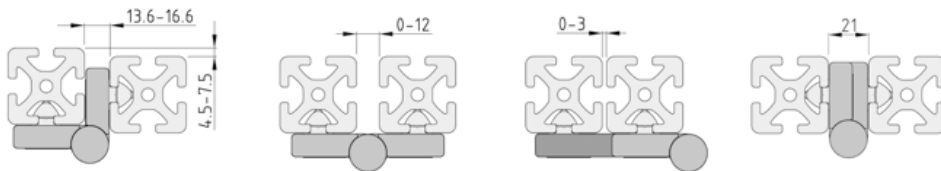

Application	$F_{r \text{ perm.}}$	$F_{ax \text{ perm.}}$
1	150 N	750 N
2	350 N	750 N
3	350 N	450 N

$$F_{ax} \times r = F_r \times h$$

The data apply for at least two hinges per door - one hinge assumed to be supporting.

7

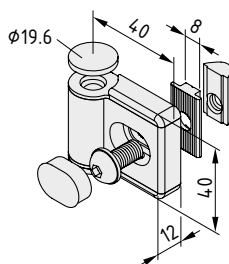

#### Hinge Leaf 8 40x40



Hinge Leaf, Al, anodized, natural  
 Locating lug, Al, anodized, natural  
 Button-Head Screw ISO 7380-M8x18, St, bright zinc-pl.  
 Washer DIN 433-8.4, St, bright zinc-plated  
 T-Slot Nut V 8 St M8, St, bright zinc-plated  
 Caps, PA-GF, black  
 m = 68.0 g

1 set

0.0.483.60

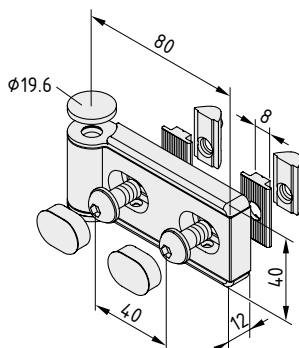

#### Hinge Leaf 8 80x40



Hinge Leaf, Al, anodized, natural  
 2 Locating lugs, Al, anodized, natural  
 2 Button-Head Screws ISO 7380-M8x18, St, bright zinc-pl.  
 2 washers DIN 433-8.4, St, bright zinc-plated  
 2 T-Slot Nuts V 8 St M8, St, bright zinc-plated  
 Caps, PA-GF, black  
 m = 125.0 g

1 set

0.0.483.59

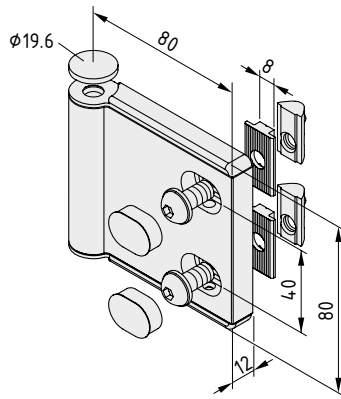
**Hinge Leaf 8 80x80**

Hinge Leaf, Al, anodized, natural  
 2 Locating lugs, Al, anodized, natural  
 2 Button-Head Screws ISO 7380-M8x18, St, bright zinc-pl.  
 2 Washers DIN 433-8.4, St, bright zinc-plated  
 2 T-Slot Nuts V 8 St M8, St, bright zinc-plated  
 Caps, PA-GF, black  
 m = 225.0 g

1 set

0.0.485.22

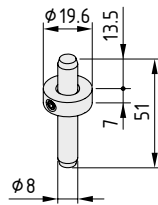
**Hinge Pin D8x51**

Pin, St, stainless  
 Locking ring, St, black  
 Grub screw DIN 916-M4x4, St, black  
 m = 32.0 g

1 set

0.0.483.62

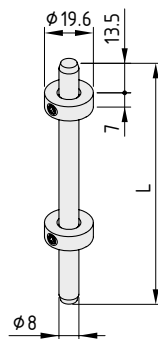
**Hinge Pin D8x76**

Pin, St, stainless  
 2 locking rings, St, black  
 2 grub screws DIN 916-M4x4, St, black  
 L = 76 mm  
 m = 55.0 g

1 set

0.0.483.61

**Hinge Pin D8x116**

Pin, St, stainless  
 2 locking rings, St, black  
 2 grub screws DIN 916-M4x4, St, black  
 L = 116 mm  
 m = 70.0 g

1 set

0.0.486.16



## Hinge St

- For lightweight doors and lids
- Can be installed to prevent disassembly from outside

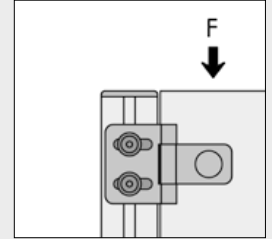
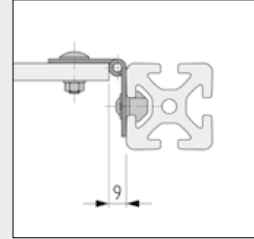
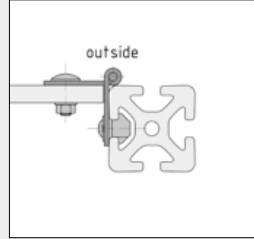
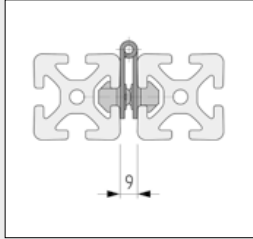
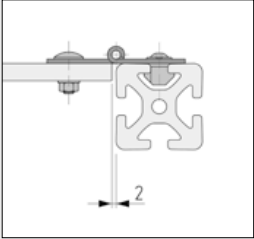

7

Note: T-Slot Nuts 8 Zn M5 is recommended for screwing Hinge St to the Line 8 Profile.

These attachment versions of Hinge St cannot be unscrewed from the outside.

F = 250 N

T-Slot Nuts Zn 137

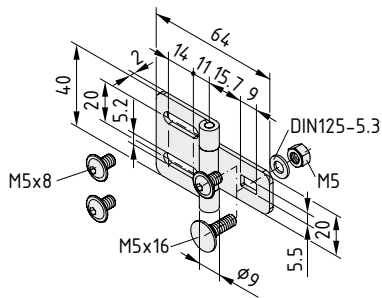

### Hinge St

- Hinge halves, St, black
- 3 dome-head screws M5x8, St, black
- Hexagon Nut DIN 934-M5, St, black
- Washer DIN 125-5,3, St, black
- Cup square bolt DIN 603-M5x16, St, black
- m = 51.0 g

1 set

0.0.373.82



## Hinges 6 Zn

- For medium-weight doors and lids
- Durable metal design

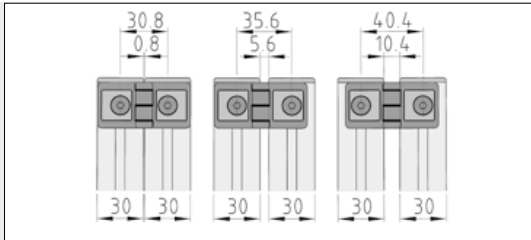

Hinge 6 30 Zn 6/6  
Possibilities for mounting the anti-torsion block with profiles line 6.

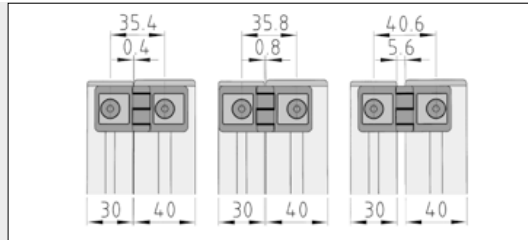

Hinge 6 30 Zn 6/8  
Possibilities for mounting the anti-torsion block with profiles line 6 and 8.

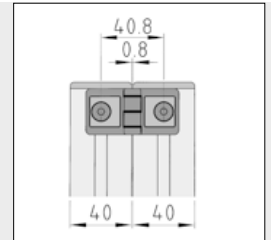

Hinge 6 30 Zn 8/8  
Possibilities for mounting the anti-torsion block with profiles line 8.

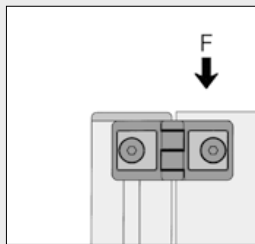
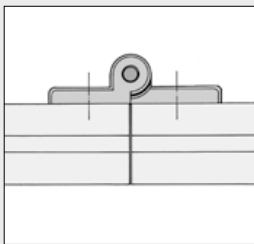

F = 300 N

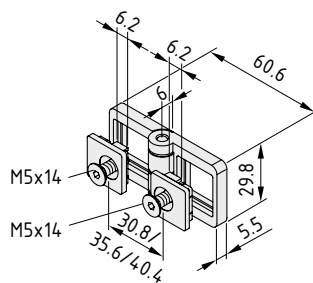

### Hinge 6 30 Zn 6/6



Hinge, die-cast zinc, black  
2 anti-torsion blocks 6, die-cast zinc, black  
2 Countersunk Screws DIN 7991-M5x14, St, black  
m = 62.0 g

1 set

0.0.441.58

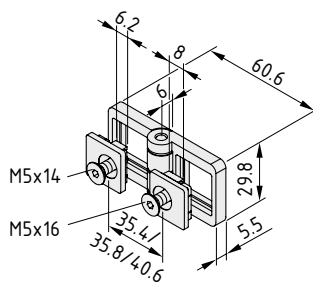

### Hinge 6 30 Zn 6/8



Hinge, die-cast zinc, black  
Anti-torsion block 6, die-cast zinc, black  
Anti-torsion block 8, die-cast zinc, black  
Countersunk Screw DIN 7991-M5x14, St, black  
Countersunk Screw DIN 7991-M5x16, St, black  
m = 63.0 g

1 set

0.0.441.61

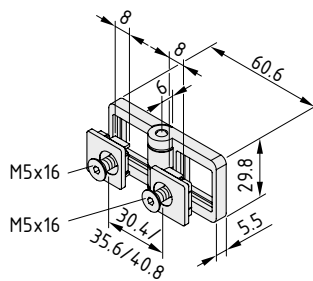

### Hinge 6 30 Zn 8/8



Hinge, die-cast zinc, black  
2 anti-torsion blocks 8, die-cast zinc, black  
2 Countersunk Screws DIN 7991-M5x16, St, black  
m = 63.0 g

1 set

0.0.441.81



## Hinge 8 Zn

- For heavily loaded doors and lids
- Durable metal design
- Products from Line X also available



7



If required, e.g. when fitting to a panel element, the anti-torsion pin should be removed with a screwdriver.

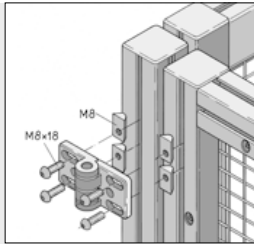

Attaching Hinge 8 40 Zn to the profile grooves of Line 8.

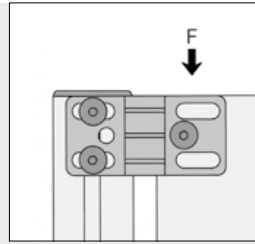

$F = 750 \text{ N}$

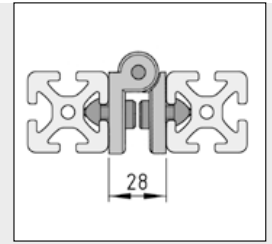
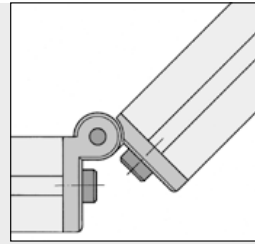

Hinge 8 40 Zn can be screw-connected to the end face or to the profile groove.



Hinges X 8 are used on Profiles X 8 when high loads come into play (large lids, doors, etc.). Hinges X 8 Zn can be used on the right or left and can be attached to the outer surfaces or end faces of Profiles. The integrated anti-torsion feature for additional fixing in the groove can be left out when screwing Hinge X 8 Zn to level surfaces.

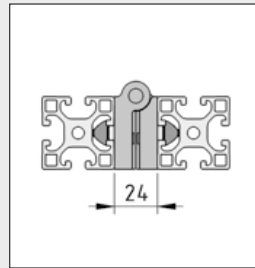
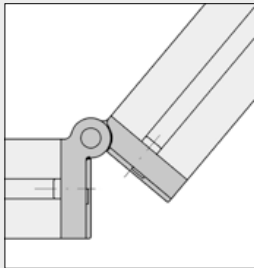

Hinge X 8 Zn can be screwed onto the end face or profile groove.

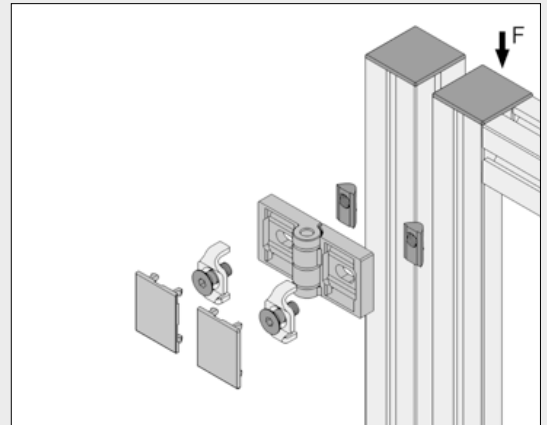

Fastening Hinge X 8 Zn to Line X 8 Profiles. For Profiles with closed grooves, the groove cover is to be removed to insert the T-Slot Nuts and positioning guides.

$F_{\text{max.}} = 500 \text{ N}$

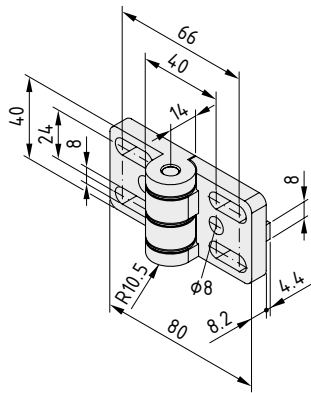

**Hinge 8 40 Zn**

Hinge halves, die-cast zinc, black  
 m = 180.0 g

1 pce.

0.0.196.36

**Hinge X 8 Zn**

Hinge, die-cast zinc, white aluminium  
 2 Caps, PA-GF, grey  
 2 positioning guides, St, bright zinc-plated  
 2 T-Slot Nuts V 8 St M8, bright zinc-plated  
 2 Countersunk Screws DIN 7991-M8x22, St, bright zinc-plated

m = 212.0 g

1 set

0.0.603.59

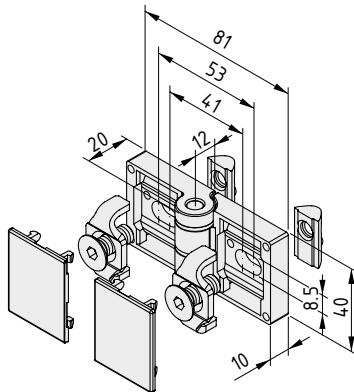



## Door Rabet 8

- For partitions with swing doors
- Safety thanks to robust design

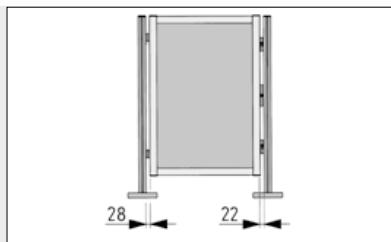
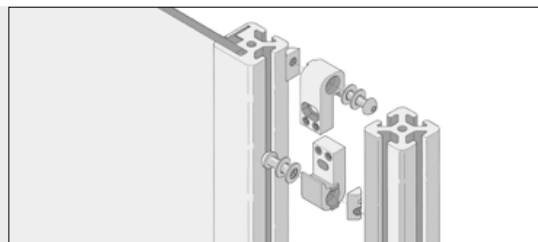

Application example for door construction:  
Clearance on left 28 mm with Hinges 8 40 Zn  
and on right 22 mm with Door Rabbets 8, in  
combination with Door Lock 8.

Door Locks 8 288

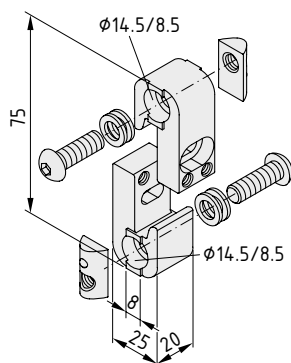

### Door Rabet 8

- 2 Door Rabbets, die-cast zinc, black
- 2 Button-Head Screws ISO 7380-M8x25, St, bright zinc-plated
- 4 spring washers, St, bright zinc-plated
- 2 T-Slot Nuts 8 St M8, bright zinc-plated
- m = 190.0 g

1 set

0.0.265.15



## Door Stop 8

- Flexible plastic Door Rabet
- No scratching of doors and frames
- Can be combined with Integrated Lock System 8

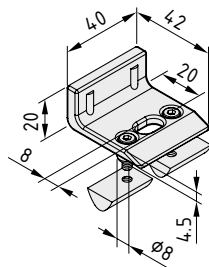

### Door Stop 8

- 2 Door Stops, PA-GF, black
- 4 Hex. Socket Head Cap Screw DIN 6912-M4x12, St, bright zinc-plated
- 4 T-Slot Nuts 8 St M4, bright zinc-plated
- m = 76.0 g

1 set

0.0.486.72



## Door Stop Seal

- Elastic lip seal has cushioning effect
- Protects against dust and dampness

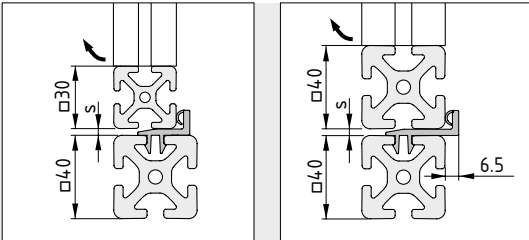

The Door Stop Seals are used in Line 8 frame structures. They are suitable for doors made of Profiles 6 (modular dimension 30 mm) or Profiles 8 (modular dimension 40 mm) with a door gap all-round (recommended:  $s > 4$  to 8 mm).

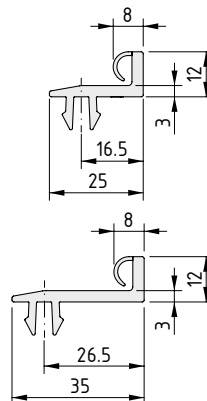

### Door Stop Seal 8 30

PP/TPE  
m = 127 g/m

grey similar to RAL 7042, 1 pce., length 3000 mm

0.0.616.57

### Door Stop Seal 8 40

PP/TPE  
m = 154 g/m

grey similar to RAL 7042, 1 pce., length 3000 mm

0.0.617.31



## Sliding-Door Guide Set 8

- Easy-running sliders on the panel element
- Guidance in Line 8 groove
- Two sliding doors can be installed in one groove

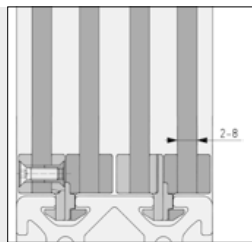
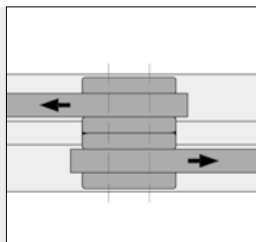
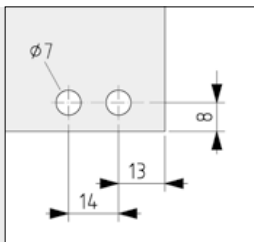
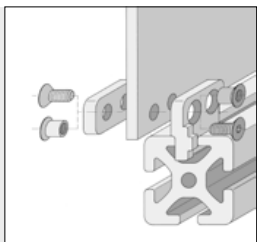

7

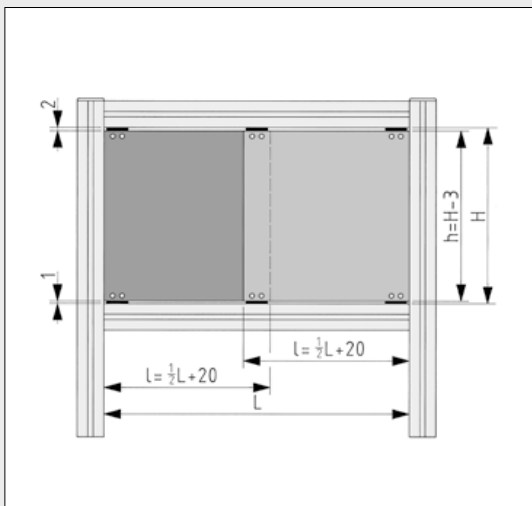

There can be either 1 or 2 sliding doors in a single Profile 8 groove.  
The slide pieces function as stops or catches for the second door at the terminal position.

The maximum permissible weight of one door is 10 kg.

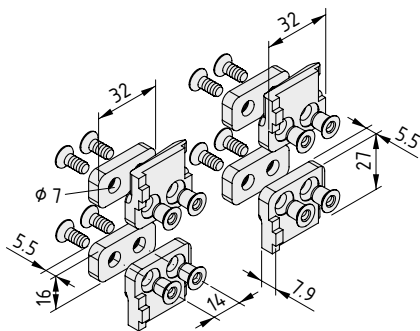

### Sliding-Door Guide Set 8



- 4 slide pieces (2xright, 2xleft), POM, black
- 4 spacer pieces, POM, black
- 8 Countersunk Screws DIN 7991-M5x12, St, bright zinc-plated
- 8 threaded bushings, St, bright zinc-plated
- m = 58.0 g

1 set

0.0.406.66



## Sliding-Door Guide Set 8/8

- Plastic slide pieces
- Designed for use with Clamp Profile 8 32x18
- Two sliding doors can be installed in one Line 8 groove

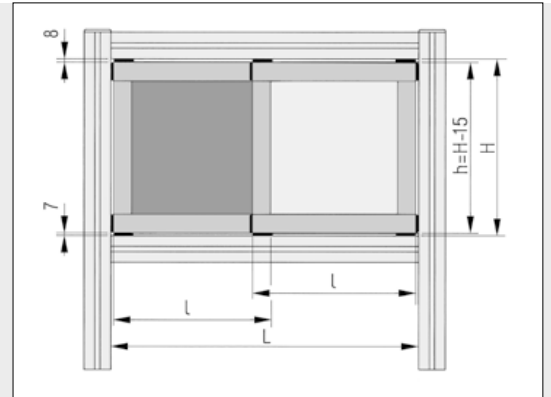
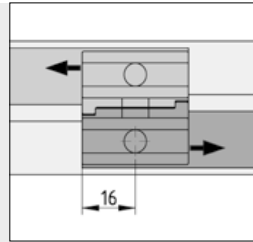
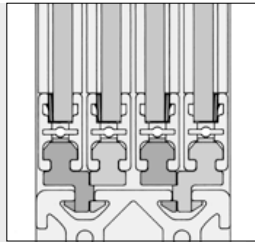
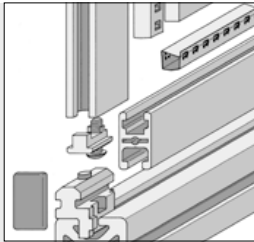

Sliding-Door Guide Set 8/8 is held securely in the profile groove by a spring bolt. For example, it locks into the mounting bore of Clamp Profile 8 32x18, which is ideal for use with Sliding-Door Guide Set 8/8. However, a separate hole with a diameter of 7 mm can also be created.

There can be either 1 or 2 sliding doors in a single Profile 8 groove. The slide pieces function as stops or catches for the second door at the terminal position.

For sliding door constructions with  $n$  door elements of the same size, the following equation can be used to calculate the profile length  $l$ :

$$l = \frac{L + 32(n-1) - 8}{n}$$

A side overlap of Caps 8 32x18 of 4 mm is taken into account.

The maximum permissible weight of one door is 10 kg.

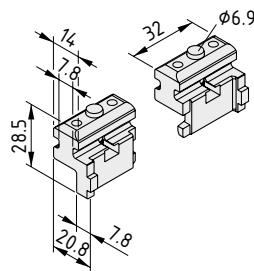

### Sliding-Door Guide Set 8/8



4 slide pieces (2x right, 2x left), POM, black  
 Spring bolt, St, bright zinc-plated  
 Spring, St, stainless  
 $m = 49.0$  g

1 set

0.0.404.87



## Sliding-Door Guide Profile

- For retrofitting sliding doors to profile constructions
- For frameless panel elements made from plastic
- Three guide tracks for door combinations



7

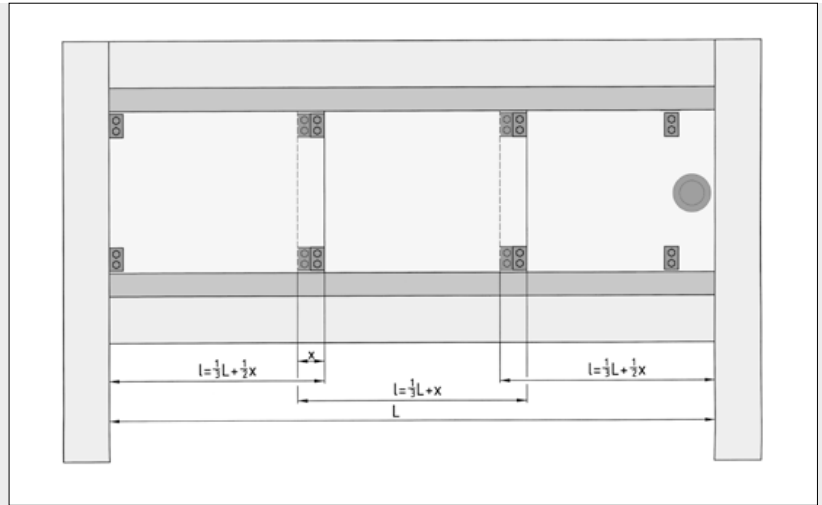
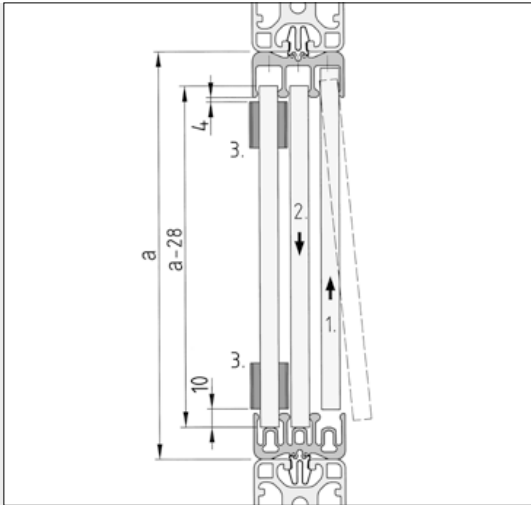

Use Clip 8 St to fasten the Sliding-Door Guide Profile to the frame profiles at the top and bottom. Next, insert the sliding doors as set out below:

1. Insert the panel element up into the desired top guide track of the Sliding-Door Guide Profile.
2. Lower the panel element into the corresponding bottom guide track.
3. Position the catch at the top to prevent the doors from being inadvertently knocked out.

Typical arrangement of a 3-part sliding door with equal-sized door segments.

The sliding-door catches are attached directly to the panel element if two or three sliding-door panels are to be moved together. Their position can be selected individually, in order to determine the required opening path of the accompanying door panels and the overlap of the doors  $x$  ( $x_{\min.} = 25 \text{ mm}$ ).

Clip 8 St 

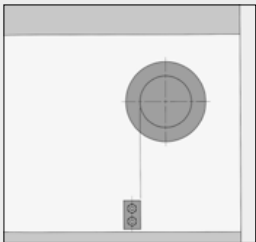

The sliding-door catches must be fitted correctly, so as to ensure that hands cannot become trapped in Handles or Recessed Grips.

Rubber rings are mounted on the catches as shock absorbers.

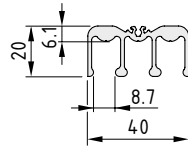

**Sliding-Door Guide Profile 8 40x20, Top**



Al, anodized

A [cm<sup>2</sup>]      m [kg/m]

2.76      0.75

natural, cut-off max. 3000 mm

0.0.473.75

natural, 1 pce., length 3000 mm

0.0.473.42

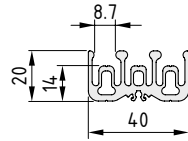

**Sliding-Door Guide Profile 8 40x20, Bottom**



Al, anodized

A [cm<sup>2</sup>]      m [kg/m]

3.43      0.93

natural, cut-off max. 3000 mm

0.0.473.74

natural, 1 pce., length 3000 mm

0.0.473.41

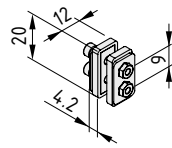

**Sliding-Door Catch Set**



2 Cap Screws DIN 912-M3x12, St, bright zinc-plated

2 nuts DIN 934-M3, St, bright zinc-plated

2 damping rings, NBR, black

m = 4.0 g

1 set

0.0.473.81





## T-Slot Slider

- Glides in the groove and enables free rotation
- Guide for folding, lifting and sliding doors
- Low-friction plastic



Construction of a folding door with T-Slot Sliders

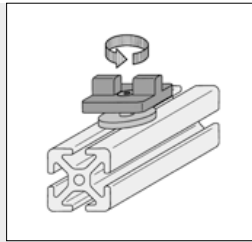

Unrestricted rotation of the T-Slot Slider around the hub also compensates for possible alignment errors.

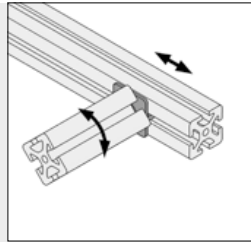

T-Slot Slider 8 can also be fitted to the end faces of Profiles 8 40x40.

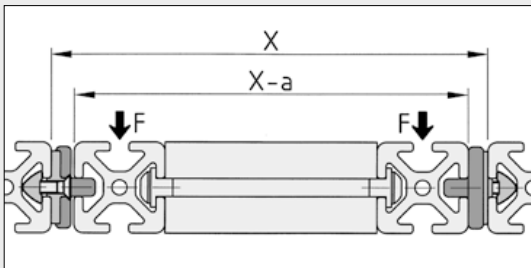

	a	F
	11 mm	30 N
	13 mm	40 N
	10 mm	60 N

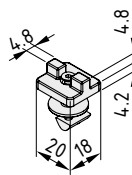

### T-Slot Slider 5

T-Slot Slider, POM, black  
 T-Slot Slider hub, St, bright zinc-plated  
 T-Slot Nut 5 St M3  
 Countersunk Screw DIN 7991-M3x10, St, bright zinc-plated  
 m = 6.0 g

1 set

0.0.437.98

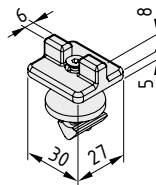

### T-Slot Slider 6

T-Slot Slider, POM, black  
 T-Slot Slider hub, St, bright zinc-plated  
 T-Slot Nut 6 St M4  
 Countersunk Screw DIN 7991-M4x14, St, bright zinc-plated  
 m = 21.0 g

1 set

0.0.459.07

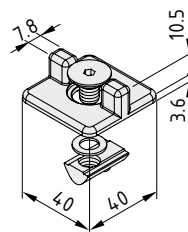

### T-Slot Slider 8

T-Slot Slider, POM, black  
 Adapter washer DIN 988-8x14x1, St, stainless  
 T-Slot Nut V 8 St M8, bright zinc-plated  
 Countersunk Screw DIN 7991-M8x13, St, bright zinc-plated  
 m = 24.0 g

1 set

0.0.601.23





## T-Slot Roller

- For pull-outs of all types
- Roller uses Line 8 groove as guide
- Fixed and floating bearing rollers prevent binding in the guide

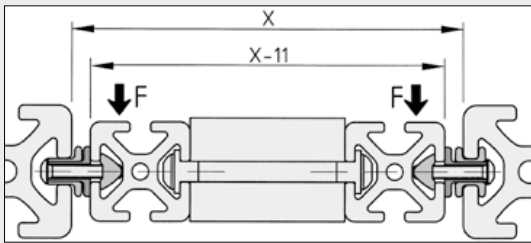
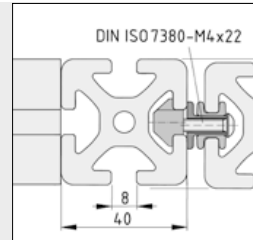
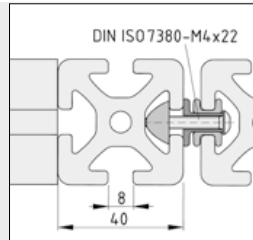
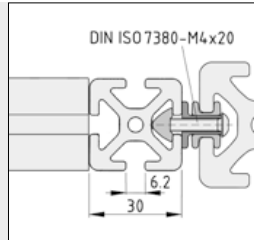
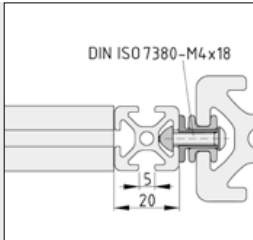

The T-Slot Rollers connect Profile 8 with the moving component without any central offset.

Special T-Slot Nut 8 Zn M4e with a central offset of 1 mm is available for moving elements made of Line 8 components. This ensures no collisions can occur during movement.

	F
T-Slot Roller 8L	50 N
T-Slot Roller 8F	50 N

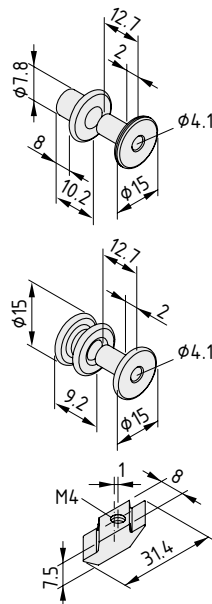

### T-Slot Roller 8 L



Floating bearing roller, POM, black  
 Bearing hub, St, bright zinc-plated  
 m = 4.0 g

1 set

0.0.457.60

### T-Slot Roller 8 F



Fixed bearing roller, POM, black  
 Bearing hub, St, bright zinc-plated  
 m = 5.0 g

1 set

0.0.457.51

### T-Slot Nut 8 Zn M4e



Die-cast zinc  
 M = 1.5 Nm      m = 5.0 g  
 black, 1 pce.

0.0.457.47



## Slide Guide Strips

- For the Slide Guides of doors and fixtures
- Plastic strips for guidance in the profile groove
- Fasten to a frame or sliding element

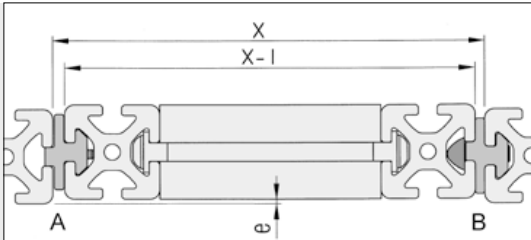

Slide Guide L (A = floating bearing) and Slide Guide F (B = fixed bearing) as guide elements, secured to a moving component.

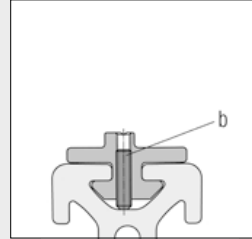
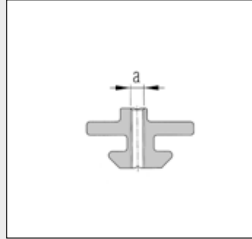

Required machining and fastening elements for fixing a Slide Guide Strip of any required length at the floating bearing end.

The distance between the fastening elements should be chosen to reflect the load.

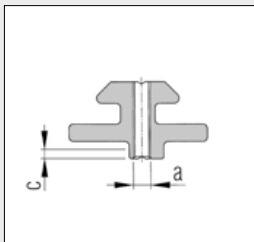
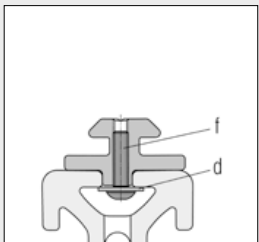

Required machining and fastening elements for fixing the Slide Guide Strip at the fixed bearing end.

Slide Guide Strip 5/5e must be counterbored by  $c = 2$  mm in the area of the screw head.

	Slide Guide Strip		
	5	6	8
a	M2.5	M3	M4
b	M2.5x8 DIN 916	M3x12 DIN 916	M4x16 DIN 916
c	2.0 mm	-	-
d	DIN 9021-2.7	DIN 9021-3.2	DIN 9021-4.3
e	0.8 mm	1.0 mm	2.0 mm
f	M2.5x8 DIN 912	M3x12 ISO 7380	M4x16 ISO 7380
l	$5.5^{+0.5}$ mm	$7.0^{+0.5}$ mm	$9.5^{+0.5}$ mm

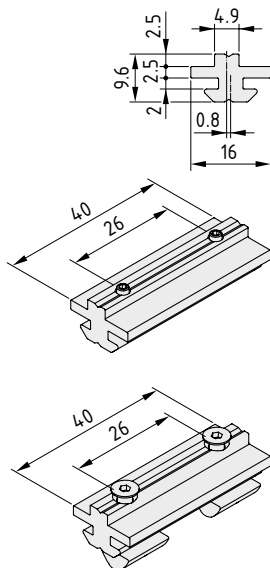

### Slide Guide Strip 5/5e

PE-UHMW  
m = 80 g/m

black, 1 pce., length 2000 mm

0.0.464.24

### Slide Guide 5/5e L

PE-UHMW  
with threaded bores  
2 grub screws DIN 916-M2.5x8, St, bright zinc-plated  
m = 5.0 g

1 set

0.0.464.29

### Slide Guide 5/5e F

PE-UHMW  
with through bores  
2 T-Slot Nuts 5 St M3, stainless  
2 Countersunk Screws DIN 7991-M3x14, St, bright zinc-plated  
2 O-rings 3x1  
m = 8.0 g

1 set

0.0.464.27

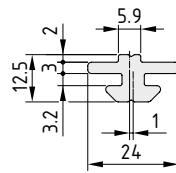
**Slide Guide Strip 6/6e**

PE-UHMW  
m = 150 g/m

black, 1 pce., length 2000 mm

0.0.459.27

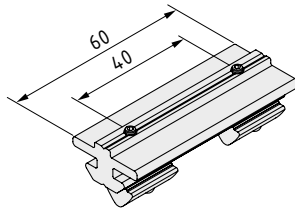
**Slide Guide 6/6e L**

PE-UHMW  
with threaded bores  
2 grub screws DIN 916-M3x12, St, bright zinc-plated  
m = 11.0 g

1 set

0.0.459.32

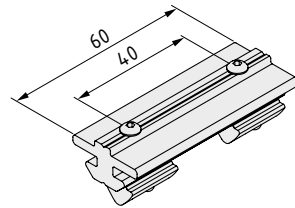
**Slide Guide 6/6e F**

PE-UHMW  
with through bores  
2 T-Slot Nuts 6 St M3, bright zinc-plated  
2 Button-Head Screws M3x18, St, bright zinc-plated  
2 O-rings 3x1  
m = 19.0 g

1 set

0.0.459.30

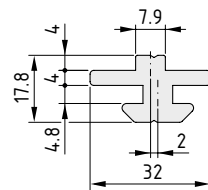
**Slide Guide Strip 8/8e**

PE-UHMW  
m = 260 g/m

black, 1 pce., length 2000 mm

0.0.458.58

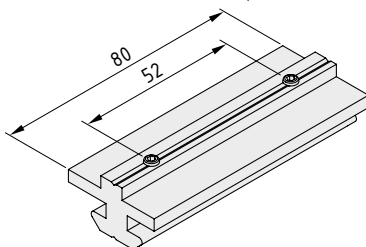
**Slide Guide 8/8e L**

PE-UHMW  
with threaded bores  
2 grub screws DIN 916-M4x16, St, bright zinc-plated  
m = 22.0 g

1 set

0.0.465.26

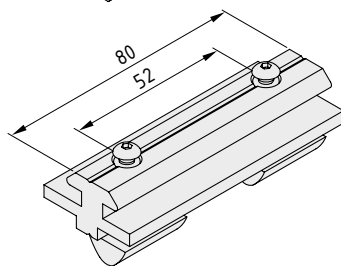
**Slide Guide 8/8e F**

PE-UHMW  
with through bores  
2 T-Slot Nuts 8 St M4, bright zinc-plated  
2 Button-Head Screws M4x25, St, bright zinc-plated  
2 O-rings 4x1.5  
m = 44.0 g

1 set

0.0.465.24



## T-Slot Slider

The solution for robust and easy-running slides

- Strong metal slide carrier
- Plastic slider for low-wear and low-friction movement
- For durable, reliable linear motion along a Line 8 groove
- Also available with clamp attachment

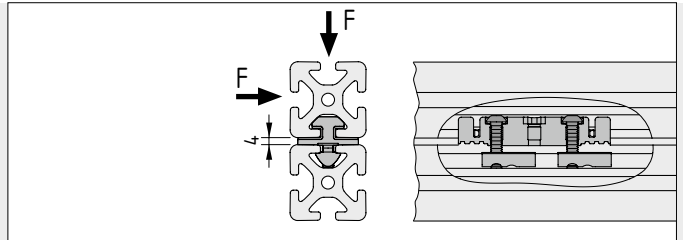
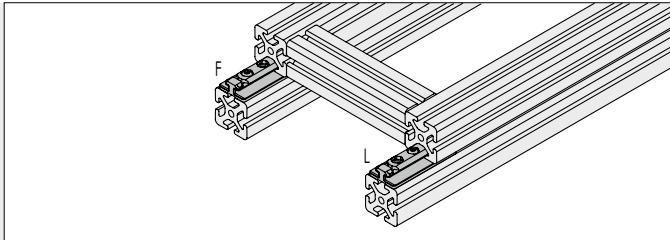

Slide guides with several slides must be designed as a combination of fixed bearing (F) and floating bearing (L). This compensates for tolerances and ensures ease of movement. The average coefficient of sliding friction of a T-Slot Slider is  $\mu = 0.22$ .

The slides must always be connected to the Profile 8 grooves using only the specially prepared Fastening Sets, part No 0.0.619.62.

The maximum permissible load for a T-Slot Slider 8 80x40 is:  
 $F_{max} = 50 \text{ N}$

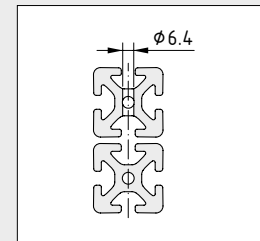
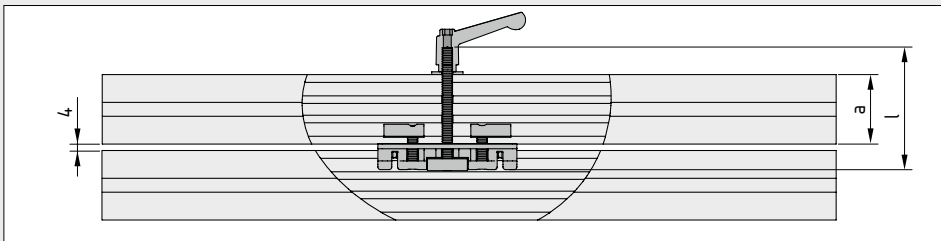
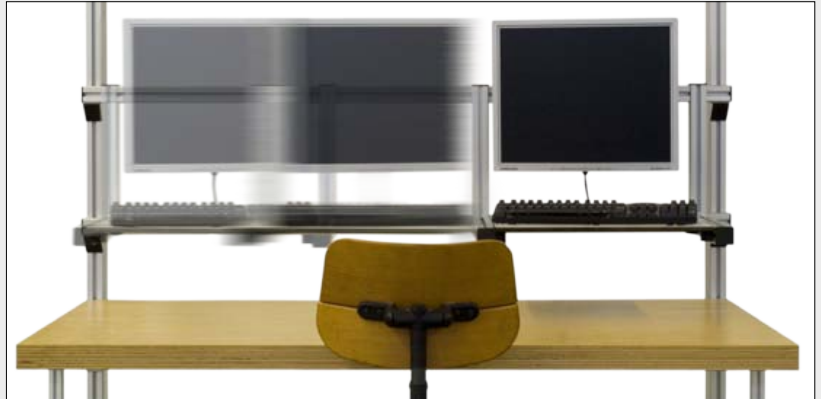

The length of the threaded stud (l) for the clamp lever must be appropriate to the height of the structure (a).

Maximum length of threaded stud:  
 $l = a + 26.5$

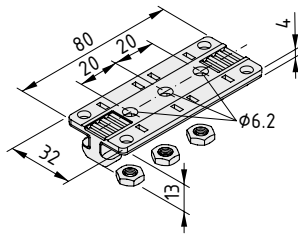
**T-Slot Slider 8 80x40**

Slide, die-cast zinc  
Slide inserts, POM  
3 nuts M6  
m = 44.0 g

1 set

0.0.607.39

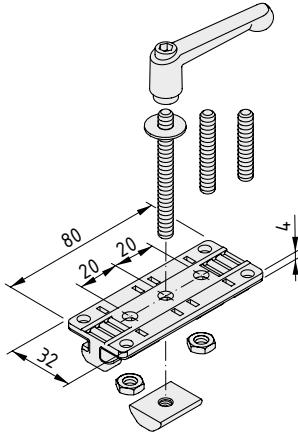
**T-Slot Slider 8 80x40 with Slide Clamp**

Slide, die-cast zinc, bright zinc-plated  
2 slide elements, POM  
2 nuts ISO 4035-M6, St, bright zinc-plated  
Special T-Slot Nut 8 St M6 heavy duty, bright zinc-plated  
Threaded stud DIN 913-M6x65, St, bright zinc-plated  
Threaded stud DIN 913-M6x45, St, bright zinc-plated  
Threaded stud DIN 913-M6x35, St, bright zinc-plated  
Clamp Lever M6-45, black  
Washer DIN 9021-6.4, St, bright zinc-plated  
m = 145.0 g

1 set

0.0.626.68

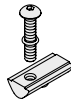
**T-Slot Slider 8 80x40, Fastening Set Floating Bearing**

Button-Head Screw M5x25, St, bright zinc-plated  
T-Slot Nut V 8 St M5, bright zinc-plated  
O-ring 5x1.2  
m = 17.0 g

1 set

0.0.619.53

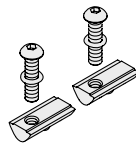
**T-Slot Slider 8 80x40, Fastening Set Fixed Bearing**

2 Button-Head Screws M6x25, St, bright zinc-plated  
2 T-Slot Nuts V 8 St M6, bright zinc-plated  
2 O-rings 6x2  
m = 34.0 g

1 set

0.0.619.62



## Castors

- Versatile and easy running
- Guidance along the profile groove



Versatile Castors which can be mounted in the profile grooves. Using screws M5 (Line 5) and M6 (Lines 6 and 8), the Castors can be secured to any chosen components in order to move these along the profile groove.

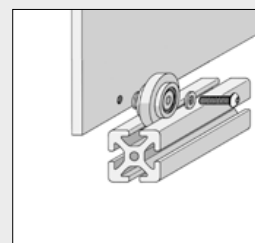
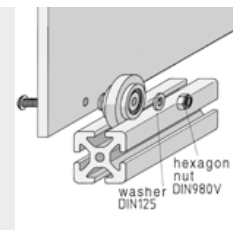
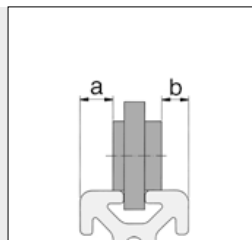
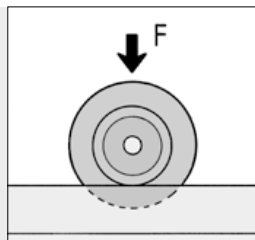

Castor	5	6	8
F	50 N	100 N	150 N
a	5.0 mm	8.5 mm	12.0 mm
b	4.0 mm	5.5 mm	10.0 mm

Light, intrinsically stable panel elements can be used as sliding doors in conjunction with the Castors.

7

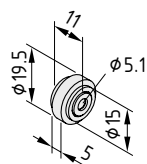

### Castor 5

Castor, POM, black  
Bearing hub, St, black  
Washer DIN 125-5.3, St, bright zinc-plated  
m = 4.0 g

1 pce.

0.0.370.97

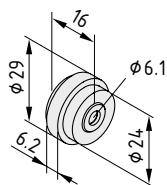

### Castor 6

Castor, POM, black  
Bearing hub, St, black  
Washer DIN 125-6.4, St, bright zinc-plated  
m = 16.0 g

1 pce.

0.0.419.79

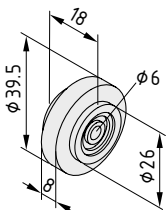

### Castor 8

Castor, PA-GF, black  
2 deep-groove ball bearings, sealed  
m = 32.0 g

1 pce.

0.0.026.83



## Castor Unit 8 PA

- Fully enclosed castor
- Door runs alongside the guide profile
- Ball-bearing, load-carrying castor

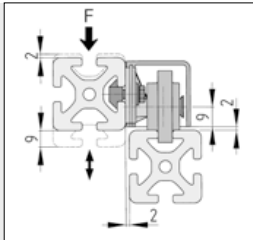

The mounting slots in the flange can be used to adjust the height of the Castor Unit. Castor 8 is asymmetrical. This means that the offset between the profiles can be altered (0 or 2 mm) depending on how it is installed.

F = max. 75 N

7

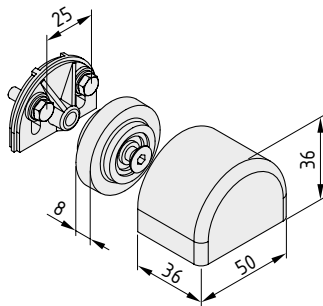

### Castor Unit 8 PA



Flange, PA-GF, black  
 Cap, PA-GF, black  
 Castor 8, PA-GF, black  
 Countersunk Screw DIN 7991-M6x30, St, bright zinc-plated  
 2 hexagon screws DIN 933-M5x16, St, bright zinc-plated  
 2 washers, St, bright zinc-plated  
 m = 66.0 g

1 set

0.0.458.85



## Runway Profiles

Easy-running turnkey solutions

- System solutions comprising Castor Units and Runway Profiles
- For use with high-load-carrying customised slides
- Runs smoothly, easily and reliably
- For automated and manual motion



Is building a sliding door really so involved? Perhaps it was in the past. The new Runway Slide Set 8 40x40 easily turns a panel of a protective fence into a sliding door.

Simply insert the runway slides into the Runway Profile, attach the door and that's it.

The 4 ball-bearing castors can accommodate tensile and compressive loads. The enclosed limit stops with locking function

bring the sliding door to a stop and hold it in place.

Maximum door weight: 30 kg

A sliding door must always be guided above and below.

7

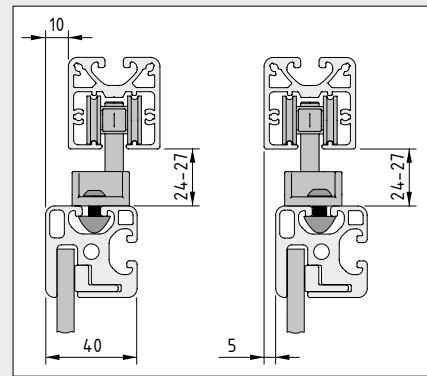
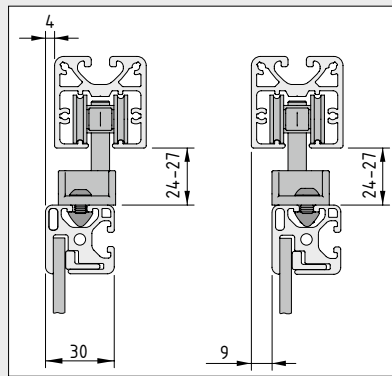

Runway Profile 8 40x40 with universal Profile 8 groove is easy to fasten and guides the sliding elements.

The hanger has broad adjustment ranges for door frames made from Profiles 8.

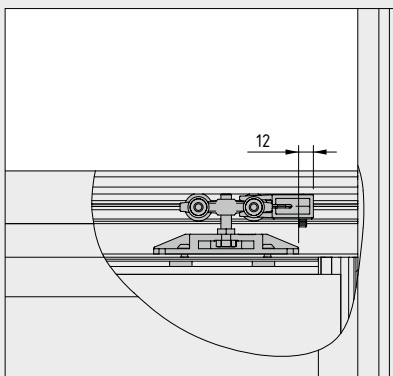

For covering the gap between a door and Runway Profile: Profile M W40x25x2 E blocks access to the door hanging system. This enhances security and ensures a seamless appearance.



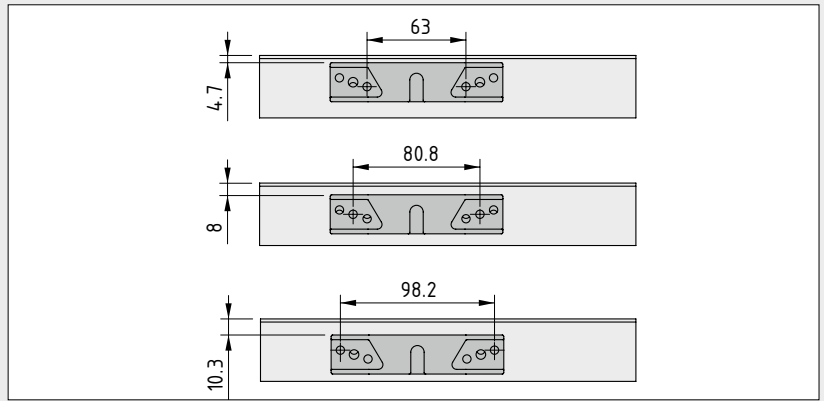
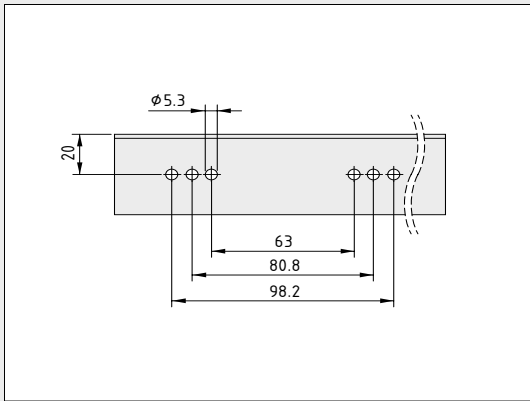

Processing of Profile M W 40x25x2 E for maximum slide adjusting range

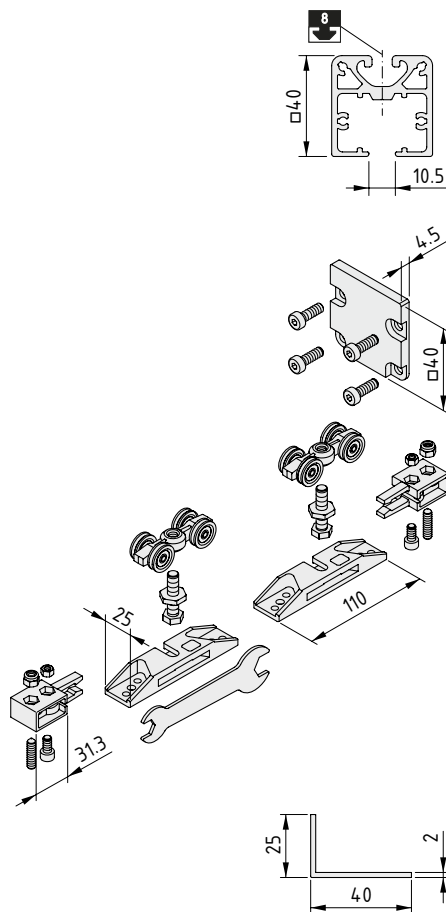

**Runway Profile 8 40x40** 8

Al, anodized

A [cm <sup>2</sup> ]	m [kg/m]	I <sub>x</sub> [cm <sup>4</sup> ]	I <sub>y</sub> [cm <sup>4</sup> ]	W <sub>x</sub> [cm <sup>3</sup> ]	W <sub>y</sub> [cm <sup>3</sup> ]
5.27	1.42	8.00	10.63	3.43	5.32
natural, cut-off max. 6000 mm <span style="float: right;">0.0.623.61</span>					
natural, 1 pce., length 6000 mm <span style="float: right;">0.0.623.58</span>					

**Castor Rail 8 Cap 40x40** 8

St, stainless, black  
 4 Hex. Socket Head Cap Screws DIN7984-M4x16, St, bright zinc-plated  
 m = 60.0 g

1 set	0.0.622.29
-------	------------

**Runway Slide Set 8 40x40** 8

2 slides, St, bright zinc-plated  
 2 Hangers, St, bright zinc-plated  
 2 limit stops, PA, black  
 Fastening elements, St, bright zinc-plated  
 Spanner, St, bright zinc-plated  
 Notes on Use and Installation  
 m = 510.0 g

1 set	0.0.624.45
-------	------------

**Profile M W40x25x2 E**

Al, anodized

A [cm <sup>2</sup> ]	m [kg/m]	I <sub>x</sub> [cm <sup>4</sup> ]	I <sub>y</sub> [cm <sup>4</sup> ]	W <sub>x</sub> [cm <sup>3</sup> ]	W <sub>y</sub> [cm <sup>3</sup> ]
1.26	0.34	0.38	2.40	0.19	0.89
natural, cut-off max. 3000 mm <span style="float: right;">0.0.626.77</span>					
natural, 1 pce., length 3000 mm <span style="float: right;">0.0.626.76</span>					



## Track Profile 8 80x40 Rollers D60 PU

The stable track for higher loads

- Ball-bearing castors with durable PU coating
- Complete Castor Units for easy installation



The system solution for constructing heavy-duty transport equipment consists of a special Track Profile and guided Rollers. Track Profile 8 80x40 is used as a guide rail for customised carriages equipped with Roller Units. Rollers D60 PU are ball-bearing mounted and are fitted with wear-resistant polyurethane tyres to ensure smooth and quiet running.

constructed for the given application. The result is a system for manual or automatic transportation of even heavy products that is particularly robust and insensitive to ambient factors (dust and knocks).

7 The pre-assembled Roller Units D60 PU can be fitted to workpiece carriers or frames constructed from profiles (preferably Line 8). The freely selectable support widths and axle distances of the carriage construction enable the guide to be

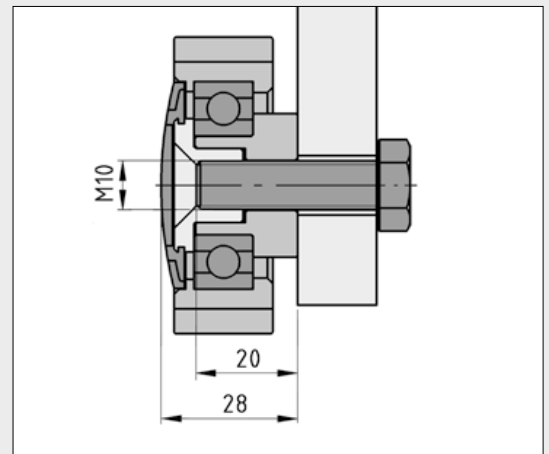
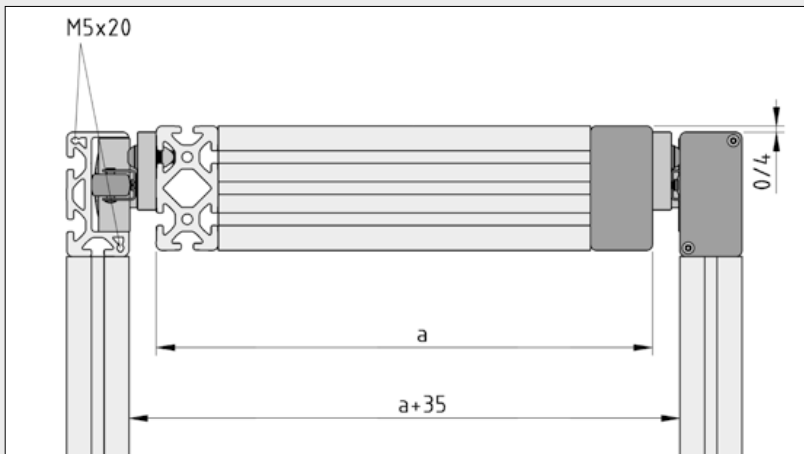

Track Profiles and Roller Units are also ideal for constructing overhead suspension units. An additional guide roller on the base plate guides Roller Unit D60 PU laterally in the Track Profile.

Rollers D60 PU can also be used as universal guide and support elements for pull-outs, as guide elements for sliding doors, and for all linear movements where flexibility and high load-bearing capacity are particularly important. They can be screwed from the outside (Countersunk Screw DIN 7981-M8) or inside (via the M10 internal thread) as required.

Roller D60 must always be fitted with the circlip facing outwards.

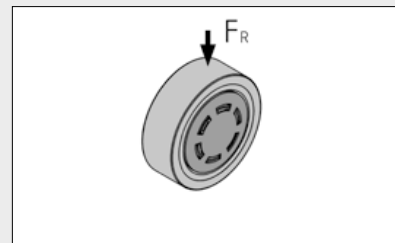

$F_R = 800 \text{ N}$

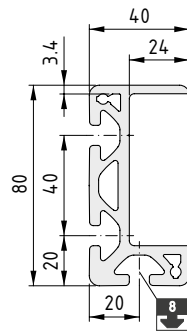

**Track Profile 8 80x40**



Al, anodized

A [cm <sup>2</sup> ]	m [kg/m]	I <sub>x</sub> [cm <sup>4</sup> ]	I <sub>y</sub> [cm <sup>4</sup> ]	W <sub>x</sub> [cm <sup>3</sup> ]	W <sub>y</sub> [cm <sup>3</sup> ]	I <sub>t</sub> [cm <sup>4</sup> ]	
10.92	2.84	76.68	12.79	17.76	7.94	3.20	
natural, cut-off max. 6000 mm							0.0.606.69
natural, 1 pce., length 6000 mm							0.0.494.77

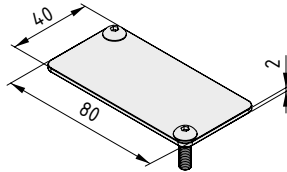

**Cap Set, Track Profile 8 80x40**



4 caps, St, black  
8 Button-Head Screws M5x16, St, bright zinc-plated  
m = 49.3 g

1 set	0.0.608.95
-------	------------

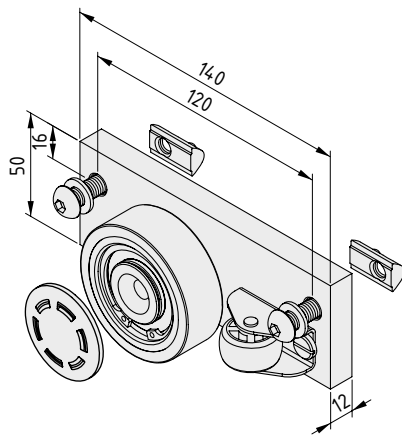

**Roller Unit D60 PU**

Connecting Plate, Al, anodized  
Roller D60 PU  
Guide roller with compression spring and fastening material  
2 Button-Head Screws ISO 7380-M8x25, St, bright zinc-pl.  
2 washers DIN 433-8.4, St, bright zinc-plated  
2 T-Slot Nuts V 8 St M8, bright zinc-plated  
m = 430.0 g

1 set	0.0.606.90
-------	------------

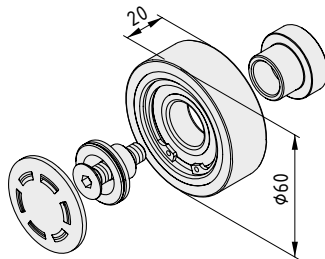

**Roller D60 PU**

Roller D60, St  
Tyre PU, 92 Sh A, yellow  
Bearing sleeve, St, bright zinc-plated  
Axial securing device, St, bright zinc-plated  
Cap, POM, black  
Countersunk Screw DIN 7981 M8x35  
C = 9,360 N  
C<sub>0</sub> = 5,000 N  
m = 270.0 g

1 set	0.0.608.94
-------	------------



## Roller Shutter System

- Turnkey solution with customised components
- Aluminium or plastic roller shutters
- Space-saving protection provided by a flexible door



7 Roller Shutters can be used primarily as moving panel elements for locking cabinet systems, control panels and operating consoles etc. The major advantage of the system is its flexibility, allowing it to be housed within the cabinet, and requiring far less space than swing or sliding doors.

The Roller Shutter System is suitable for constructing manually-operated vertical and horizontal roller shutters on frames built from Profiles 8. The system consists of the Roller Shutter Guide and the Roller Shutter itself, both of which are of modular design. The Roller Shutter is available in aluminium or plastic.

Detailed installation instructions are included with the Roller Shutter Curved Guide Set 45°.

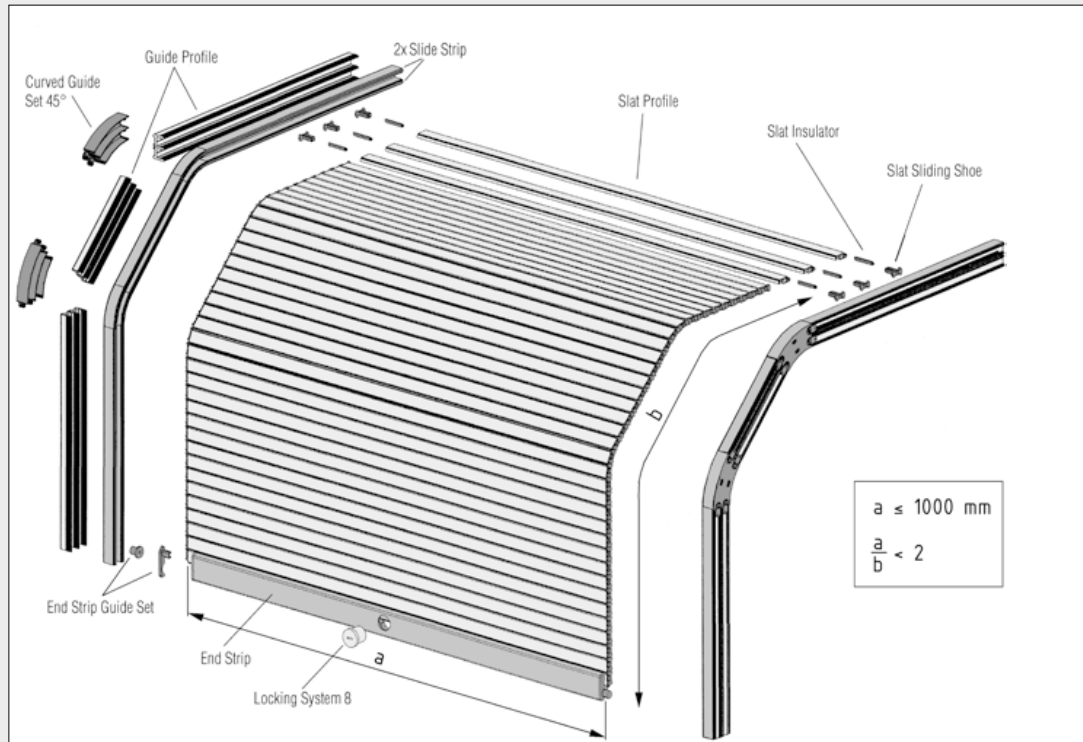

## RS Guide

- The flexible and universal guide for the Roller Shutter System
- Suitable for plastic and aluminium roller shutters
- Can be installed vertically and horizontally

Clip 8 St

69

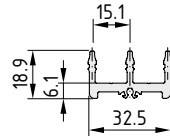

### RS Guide Profile 8

Al, anodized

A [cm<sup>2</sup>] m [kg/m]

2.28 0.61

natural, cut-off max. 3000 mm

0.0.465.63

natural, 1 pce., length 3000 mm

0.0.458.76

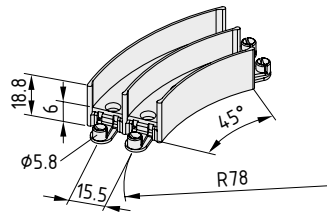

### RS Curved Guide Set 45°

2 Curved Guides 45°, PA, black

4 Countersunk Screws DIN 965-M2.5x5, St, bright zinc-pl.

Notes on Use and Installation

m = 135.0 g

1 set

0.0.465.70

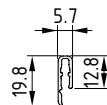

### RS Slide Strip

PE-HD

A [cm<sup>2</sup>] m [g/m]

0.45 44.0

black, 1 roll length 20 m

0.0.458.64

## Aluminium Roller Shutters

- Stable roller shutters made of aluminium
- Dividing insulators eliminate rattle

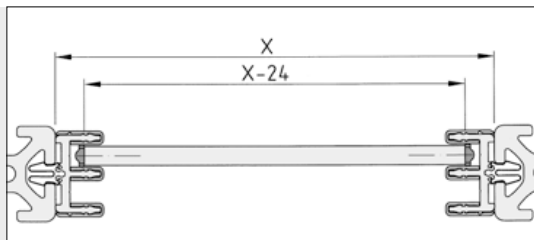

Aluminium Roller Shutters are constructed as Slat Profiles Al with Slat Insulators between them. Each slat must be provided with Slat Sliding Shoes at each end. Weight of aluminium Roller Shutter: 8 kg/m<sup>2</sup>

Length of aluminium Roller Shutter Slats:

$$l = X - 24 \text{ mm}$$

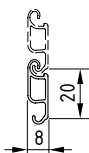

### RS Slat Profile Al

Al, anodized

A [cm <sup>2</sup> ]	m [kg/m]
0.58	0.16

natural, cut-off max. 3000 mm

0.0.465.69

natural, 1 pce., length 3000 mm

0.0.458.75

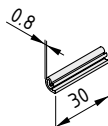

### RS Slat Insulator

PA

Recommended usage: 4 per 1m

m = 40 g/100

transparent, 1 pce.

0.0.458.66

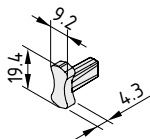

### RS Slat Sliding Shoe

PA

m = 60 g/100

black, 1 pce.

0.0.458.77

## Plastic Roller Shutters

- Lightweight slats with integrated fastener
- No additional Slat Sliding Shoe required
- For lightweight Roller Shutters

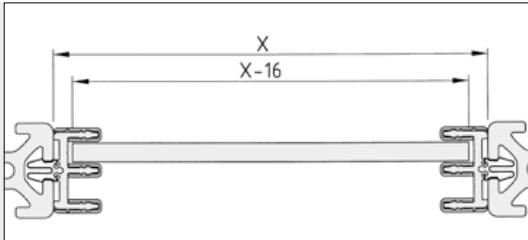

Roller Shutter Slat Profile K is connected to a Roller Shutter by means of the integrated locking segments.  
 No Slat Insulators or Slat Sliding Shoes are required.  
 Weight of plastic Roller Shutter: 3.2 kg/m<sup>2</sup>  
 Length of plastic Roller Shutter Slats:

$$l = X - 16 \text{ mm}$$

7

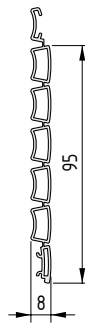

### RS Slat Profile K



PS/TPE  
 grey, aluminium-coloured coating  
 m = 306 g/m

1 pce., length 2000 mm

0.0.629.26



## Roller Shutter End Strip

- Roller Shutter guidance and terminating mechanism
- Can be fitted with grip and lock as required

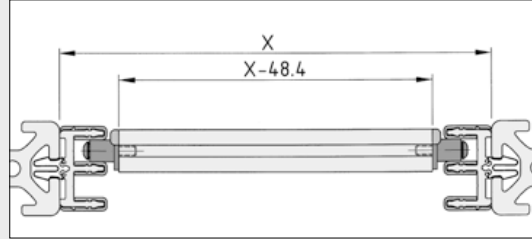
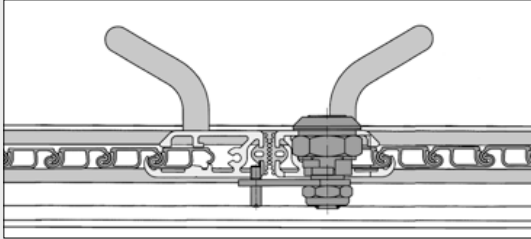

7

The Roller Shutter End Strip is used to terminate the Roller Shutter. Handles or a Grip System can be secured to it. Roller Shutter Locking System 8 is inserted into a drill hole in the Roller Shutter End Strip. Detailed installation instructions are included with the Roller Shutter Curved Guide Set 45°.

Length  $l$  of the Roller Shutter End Strip:

$$l = X - 48.4 \text{ mm}$$

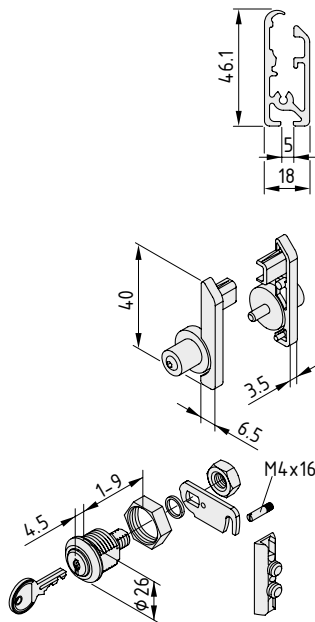

<b>RS End Strip</b>		
Al, anodized		
A [cm <sup>2</sup> ]	m [kg/m]	
2.95	0.79	
natural, cut-off max. 3000 mm		0.0.465.66
natural, 1 pce., length 3000 mm		0.0.458.78
<b>RS End Strip Guide Set</b>		
End Strip cap, left, PA, black		
End Strip cap, right, PA, black		
2 End Strip rollers, POM/St, black		
m = 8.0 g		
1 set		0.0.465.58
<b>RS Locking System 8</b>		
Cylinder Lock, all keys identical		
Key, locking bar, nab		
Headless screw		
m = 105.0 g		
1 set		0.0.465.57