



8

HANDLES AND GRIPS

8

Handles  
Grip Systems

Handles and grips  
Products in this section



**Handles PA**

- Universal handles made from robust plastic
- Wide range of fastening options

📄265



**Handles AI**

- Sturdy handles made from solid aluminium in standard sizes
- Angled version minimises risk of crushing

📄267



**Handles AI**

- Long design for moving heavy loads safely and securely
- With non-slip coating

📄269



**Handle, light duty**

- Slim aluminium grip
- Easy to attach

📄270



**Recessed Grip D50**

- For opening and closing sliding doors
- Closed rear wall protects fingers

📄271



**Grip systems**

- Customised length and design
- Ergonomic grips due to variable positioning

📄272



**Grip Rail Profiles**

- Long grip strips for easy opening and closing
- Angled cavity produces a comfortable feel

📄274



**Grip Cover Profile**

- Rubber covering for a secure grip
- Suitable for grips of any size made using standard profiles

📄275



## Handles PA

- Universal handles made from robust plastic
- Wide range of fastening options
- For sliding and swing doors
- Products from Line X also available

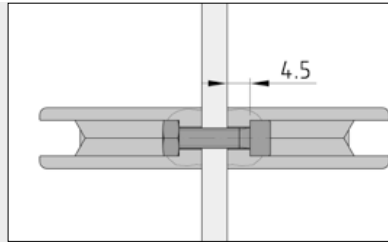
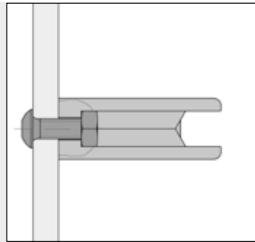
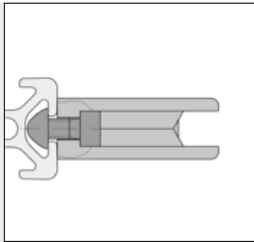

Handles PA for highly versatile application; they can be attached from the front or rear (concealed) and are particularly suitable for sliding and swing doors.

8

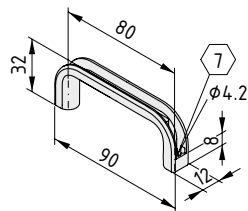

### Handle PA 80

PA-GF  
m = 9.0 g  
black, 1 pce.

0.0.391.34

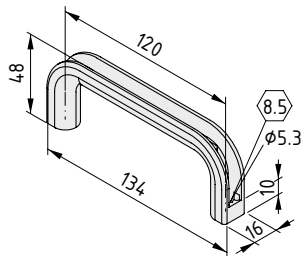

### Handle PA 120

PA-GF  
m = 30.0 g  
black, 1 pce.

0.0.391.35

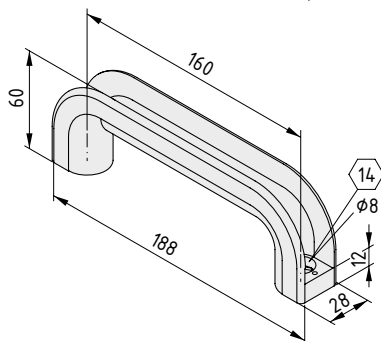

### Handle PA 160

PA-GF  
m = 93.0 g  
black, 1 pce.

0.0.196.57

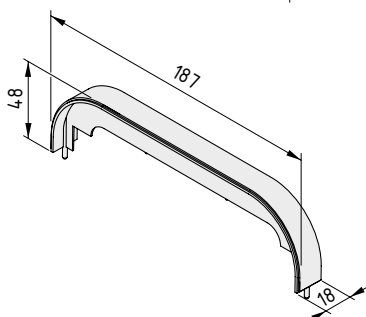

### Cap for Handle PA 160

PA-GF  
m = 20.0 g  
black, 1 pce.

0.0.475.38

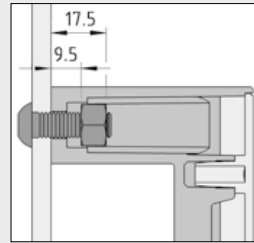
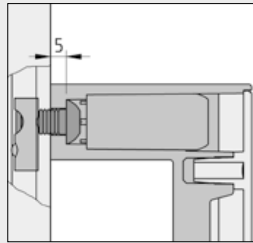

Handle X 160 PA can be fastened from the front or back (hidden) and is suitable for sliding and swing doors.

The top part of the grip of Handle X 160 PA is snapped on after the grip has been fitted.

Handle X 160 PA can be attached to profiles using a screw (max. M8) and T-Slot Nut.

An M8 nut can be inserted in the lower part of the grip for fastening from the back of the door.

8

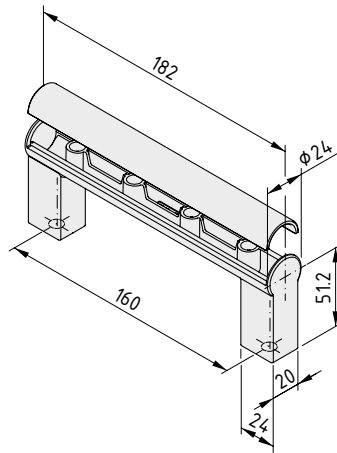

**Handle X 160 PA**



PA-GF

m = 83.0 g

black, 1 pce.

0.0.495.37

grey similar to RAL 7042, 1 pce.

0.0.494.86



## Handles AI

- Sturdy handles made from solid aluminium
- Angled version minimises risk of crushing
- For sliding and swing doors

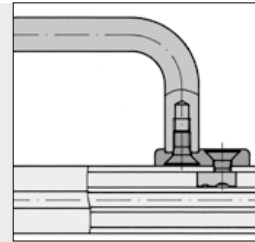
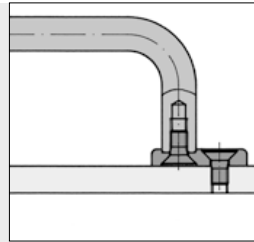
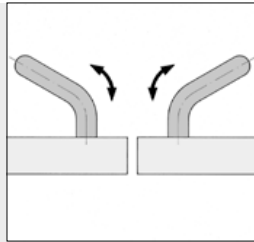
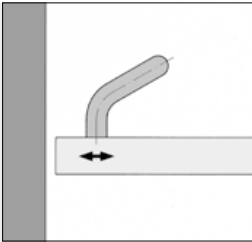

The cranked Handles are particularly suitable for sliding and swing doors to reduce the risk of fingers being crushed.

Handles AI can be secured from the rear (concealed). They can also be fitted from the front when used with the Fastening Sets.

8

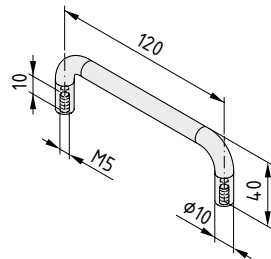

### Handle AI 120

Al

m = 37.0 g

black, 1 pce.

0.0.416.85

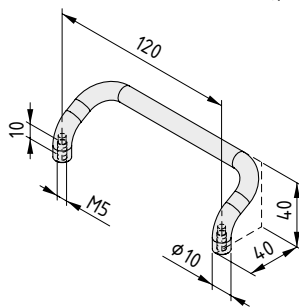

### Handle AI 120 cranked

Al

m = 43.0 g

black, 1 pce.

0.0.416.87

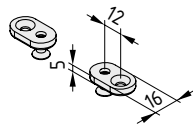

### Fastening Set for Handle AI 120

2 connection elements 120, die-cast zinc, black

2 Countersunk Screws DIN 7991-M5x10, St, black

m = 21.0 g

1 set

0.0.418.81

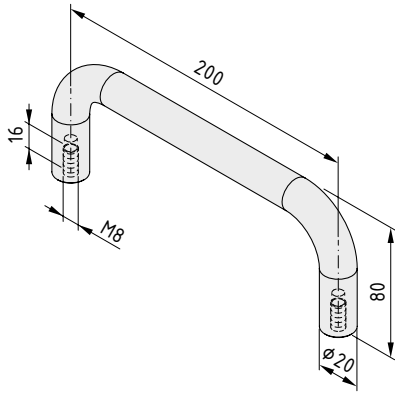

**Handle AI 200**

Al

m = 261.0 g

black, 1 pce.

0.0.416.81

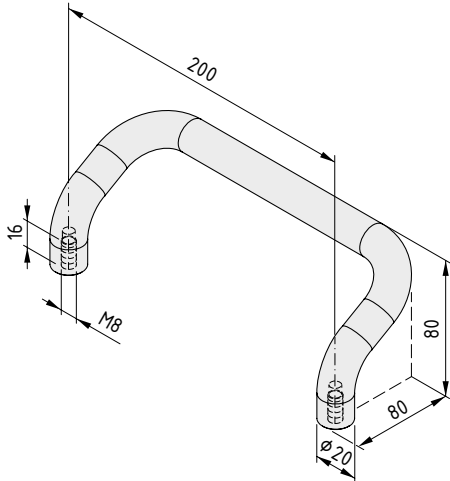

**Handle AI 200 cranked**

Al

m = 312.0 g

black, 1 pce.

0.0.416.83

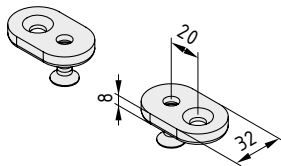

**Fastening Set for Handle AI 200**

2 connection elements 200, die-cast zinc, black

2 Countersunk Screws DIN 7991-M8x18, St, black

m = 130.0 g

1 set

0.0.418.82



## Handles AI

- Large handles for machine doors and mobile factory equipment
- Non-slip coating



The Handles are available in various lengths. They make it easier to transport even heavy loads manually. Robust die-cast handle mounts ensure a secure connection with the mobile equipment. A special grip profile with a non-slip coating supports smooth pulling and pushing motions.

All the Handles AI are ESD-safe.



8

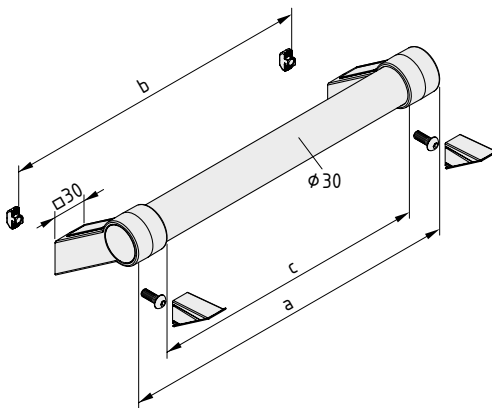

### Handle AI 350



2 handle mounts, black  
 Handle profile, Al, powder-coated, black  
 2 handle caps, PA, black  
 4 handle mount caps, PA, black  
 2 Button-Head Screws M6x16, St, bright zinc-plated  
 2 Hammerhead Nuts 8 M6, St, bright zinc-plated  
 a = 380 mm    b = 350 mm    c = 320 mm    m = 0.8 kg

1 set

0.0.644.01

### Handle AI 550



2 handle mounts, die-cast zinc, black  
 Handle profile, Al, powder-coated, black  
 2 handle caps, PA, black  
 4 handle mount caps, PA, black  
 2 Button-Head Screws M6x16, St, bright zinc-plated  
 2 Hammerhead Nuts 8 M6, St, bright zinc-plated  
 a = 580 mm    b = 550 mm    c = 520 mm    m = 0,9 kg

1 set

0.0.644.02

### Handle AI 750



2 handle mounts, die-cast zinc, black  
 Handle profile, Al, powder-coated, black  
 2 handle caps, PA, black  
 4 handle mount caps, PA, black  
 2 Button-Head Screws M6x16, St, bright zinc-plated  
 2 Hammerhead Nuts 8 M6, St, bright zinc-plated  
 a = 780 mm    b = 750 mm    c = 720 mm    m = 1.1 kg

1 set

0.0.644.03



### Handle X 160 Al

- Exceptionally stylish
- For constructions built with Profiles X



Handle X 160 Al is a light-duty handle with the same design as Line X Profiles. It can be fastened from behind (hidden).

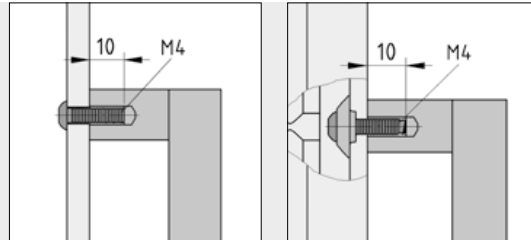

When using screws to attach these Handles to profile grooves, it is advisable to use the appropriate Locating Washers. The M4 thread in Handle X 160 Al is used to fasten it in place.

8

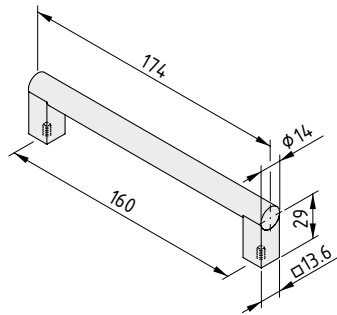

#### Handle X 160 Al



Al  
m = 94.0 g  
natural, 1 pce.

0.0.600.70



### Handle, light duty

- Slim aluminium grip
- Suitable for universal use

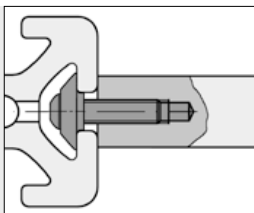

The Handle can also be secured from the rear (concealed) with M5 screws. Suitable Locating Washers are used to adapt the Handle for profiles from a range of Lines.

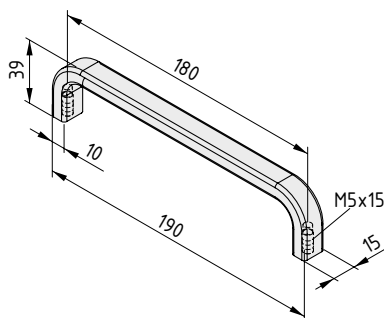

#### Handle, light duty

Al, anodized  
m = 87.0 g  
natural, 1 pce.

0.0.026.44





## Recessed Grip D50

Safe, practical and space saving

- For opening and closing sliding doors
- Closed rear wall to protect fingers

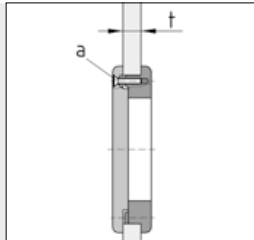
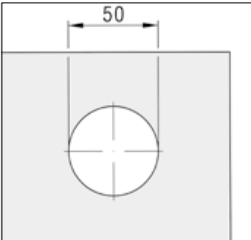

Self-Tapping  
Screws DIN 7982 t [mm]

2.2x9.5	5-6
2.2x13	7-8

Required hole size in panel element to fit the Recessed Grip D50.

8

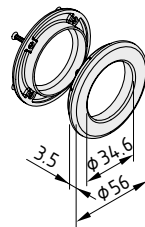

### Recessed Grip D50

PA-GF

4 Self-Tapping Screws DIN 7982-2.2x9.5, St, black

4 Self-Tapping Screws DIN 7982-2.2x13, St, black

m = 16.0 g

1 set

0.0.479.59



## Grip systems

- Customised length and design
- Ergonomic grips due to variable positioning
- Additional reinforcement for door constructions
- Products from Line X also available

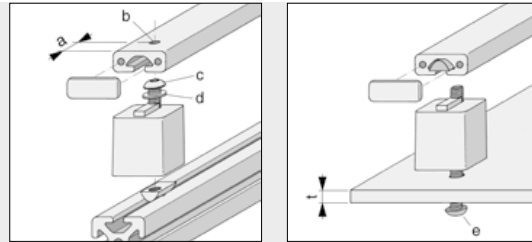

a [mm]	b [mm]	c [mm]	d [mm]	e [mm]
		Screw	Washer	Screw
		ISO 7380	DIN 125	ISO 7380
	20	∅ 7	M8x60	∅ 8.4 M8x(t+56)

Hand-Grip Elements, in conjunction with profiles and Caps, can be used to construct handles which when attached to the panel elements, have a supplementary stabilising effect.

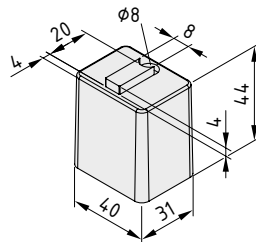

### Hand-Grip Element 8

PA-GF  
m = 28.0 g

black, 1 pce.

0.0.196.60



Grip System X D25 consists of Hand Grip Elements X D25 and cylindrical Profile D25. These components can be used to create handles of any length, but the distance between two Hand Grip Elements must not exceed 1000 mm.

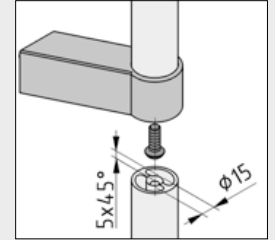
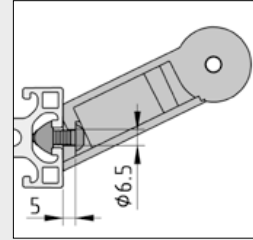
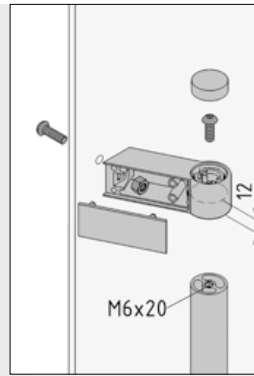

Profile sections D25 are inserted in Hand Grip Element X D25 from one or both sides. Any hole not required is covered using the Cap provided.

M6x20 threads are provided in the core bore of the Profile D25 which is then press-fitted in the correct position in the Hand Grip Elements. All M6 screw connections of Hand Grip Element X D25 should be tightened with a torque of  $M = 4 \text{ Nm}$ .

For longer Grip Systems X D25, an additional Hand Grip Element should be used to provide central support. Before being inserted in this Hand Grip Element, the second Profile D25 must be countersunk around the core bore.

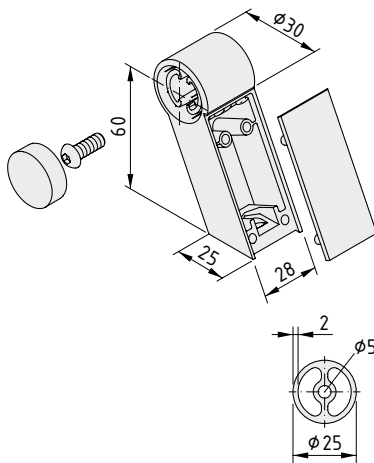

#### Hand Grip Element X D25



Hand grip, PA-GF, grey  
 Cap for hand grip, PA-GF, grey  
 Cap D25, PA-GF, grey  
 Button-Head Screw ISO 7380-M6x16, St, bright zinc-plated  
 $m = 44.0 \text{ g}$

1 set	0.0.601.65
-------	------------

#### Profile D25



Al, anodized  

A [cm <sup>2</sup> ]	m [kg/m]
2.32	0.57

natural, cut-off max. 3000 mm	0.0.601.63
-------------------------------	------------

natural, 1 pce., length 3000 mm	0.0.601.36
---------------------------------	------------



## Grip Rail Profiles

- Long grip strips for easy opening and closing
- Angled cavity produces a comfortable feel
- Added stability for panel elements
- Products from Line X also available

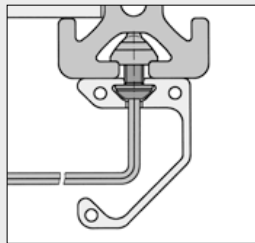
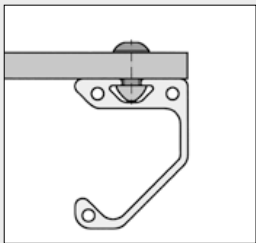
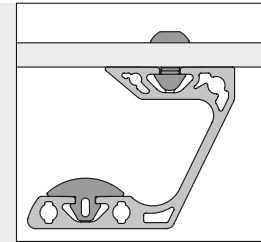
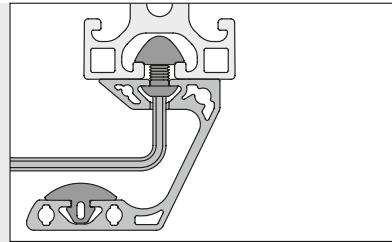

Using Grip Cover Profile 5 20x4 (0.0.437.03) on the inside gives Grip Rail Profile X extremely good non-slip and tactile properties. The integrated Line 5 grooves are used for simple fastening to any given structure and for mounting the Grip Cover Profile.

Grip Rail Cap Set X is also designed for use with Grip Cover Profile.

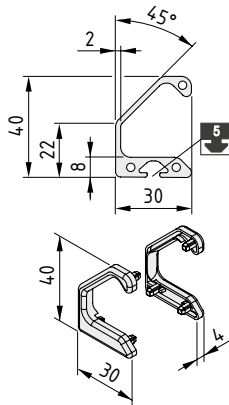

### Grip Rail Profile

Al, anodized

A [cm <sup>2</sup> ]	m [kg/m]
2.80	0.76

2.80 0.76

natural, cut-off max. 3000 mm

0.0.432.09

natural, 1 pce., length 3000 mm

0.0.452.17

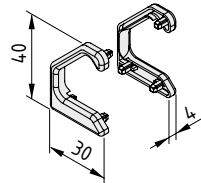

### Grip Rail Cap Set

Grip Rail Cap, right, PA-GF, black  
Grip Rail Cap, left, PA-GF, black  
m = 3.5 g

1 set

0.0.432.28



### Grip Rail Profile X

Al, anodized

A [cm <sup>2</sup> ]	m [kg/m]
3.43	1.01

3.43 1.01

natural, cut-off max. 3000 mm

0.0.494.59

natural, 1 pce., length 3000 mm

0.0.494.58

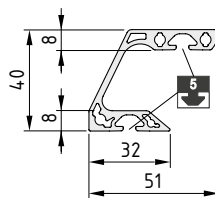

### Grip Rail Cap Set X

Grip Rail Cap right, PA-GF  
Grip Rail Cap left, PA-GF  
m = 3.2 g

grey similar to RAL 7042, 1 set

0.0.495.09

black, 1 set

0.0.613.12

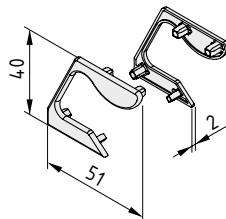

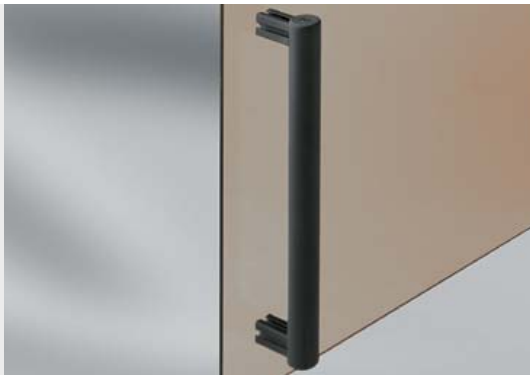

## Grip Cover Profile

- Rubber covering for a secure grip
- Suitable for grips of any size made using standard profiles
- Ideal for heavy-duty doors

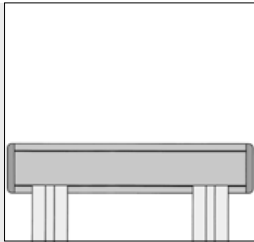

Discontinuation of the Grip Cover Profile for right-angled profile connections.

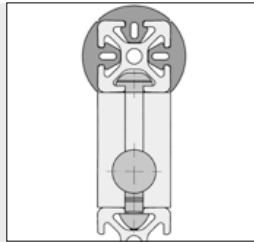

Can be connected using Standard or Universal Fastening Set.

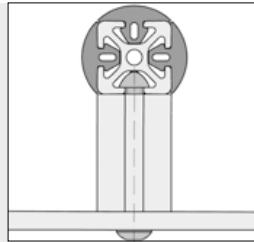

Can be connected from the inside of the door using T-Slot Nut St and Button-Head Screw ISO 7380.

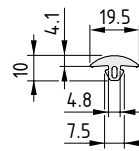

### Grip Cover Profile 5 20x4



TPE  
Hardness 73 Sh A  
Oil, UV and water resistant  
m = 78.2 g/m

black, cut-off max. 20 m

0.0.437.03

black, 1 roll length 20 m

0.0.437.05

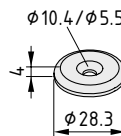

### Grip End Cap 5 D28



PA-GF  
m = 1.9 g

black, 1 pce.

0.0.437.06

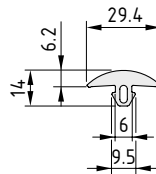

### Grip Cover Profile 6 30x6



TPE  
Hardness 65 Sh A  
Oil, UV and water resistant  
m = 170 g/m

black, cut-off max. 20 m

0.0.441.84

black, 1 roll length 20 m

0.0.441.86

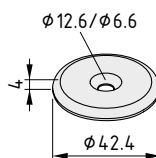

### Grip End Cap 6 D42



PA-GF  
m = 4.0 g

black, 1 pce.

0.0.441.87